

PARTS LIST AND INSTRUCTIONS

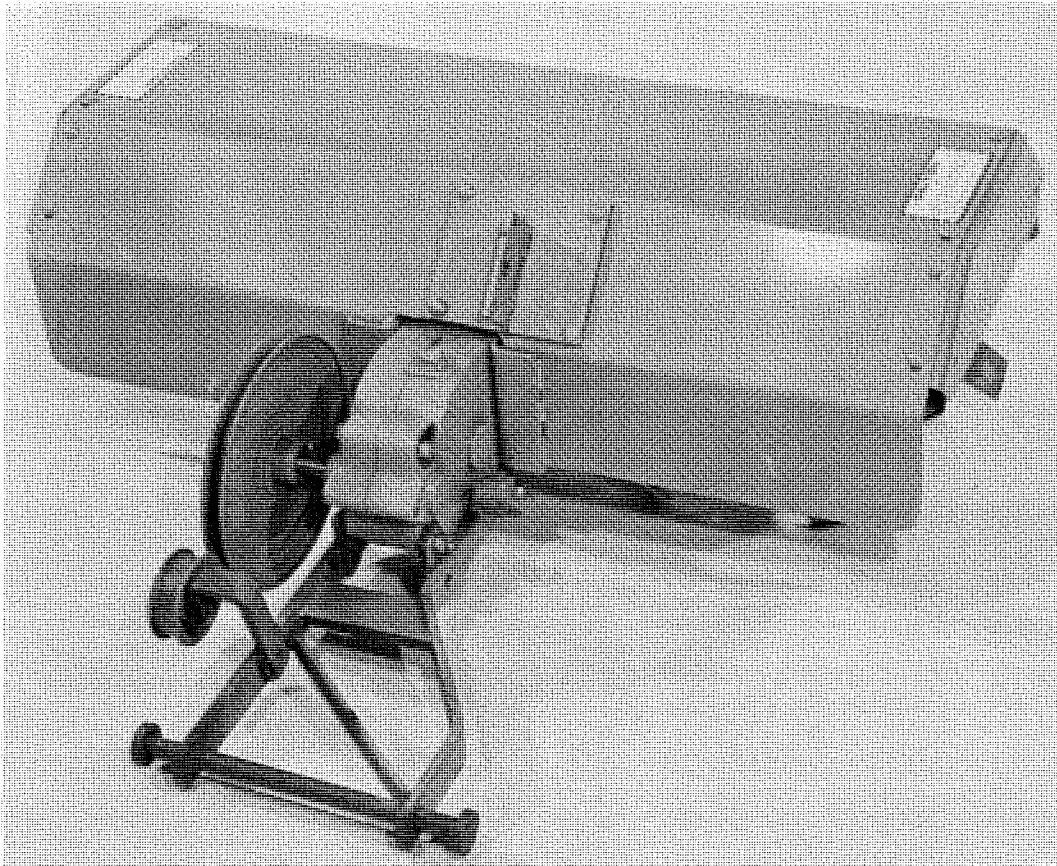

36" TILLER



WHEEL HORSE
lawn & garden tractors

77-36TL01

Price \$1.00

DESCRIPTION

The 77-36TL01 is designed for use with all 1976 and later B and C Series gasoline powered tractors. It can also be used with all 1974 and 1975 B-100 Automatic and C Series tractors when used in conjunction with Service Assembly #105111. Service Assembly #105111 is also required when mounting the tiller to 1973 and prior Long Frame Tractors. For more complete mounting information consult your Interchangeability Lists.

ASSEMBLY

IDENTIFY PARTS (Fig. 1)

Unpack the entire contents of the box and identify the parts as shown in Fig. 1.

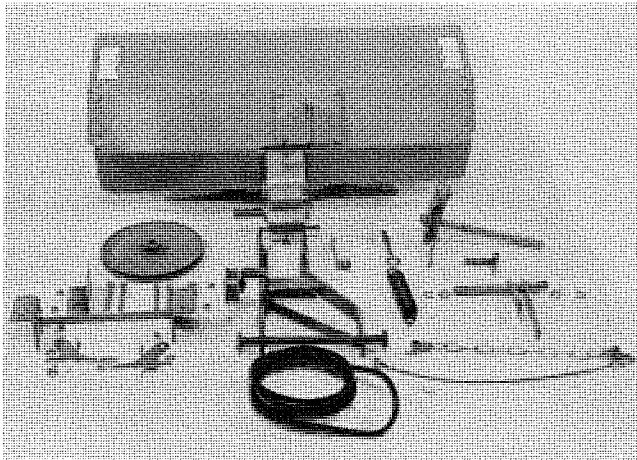

FIG. 1. 77-36TL01 Tiller Package

ATTACH HITCH (Fig. 2 & 3)

Position the tiller so that it sets in an upright position with the back hinged flap down (Fig. 2).

Remove the $\frac{3}{8}$ -16 x $5\frac{1}{2}$ Bolt from lower front of the tiller case (Fig. 2).

Install the Hitch Assembly and the "L" shaped spring bracket using the $\frac{3}{8}$ -16 x $5\frac{1}{2}$ bolt (Fig. 2). DO NOT TIGHTEN BOLT.

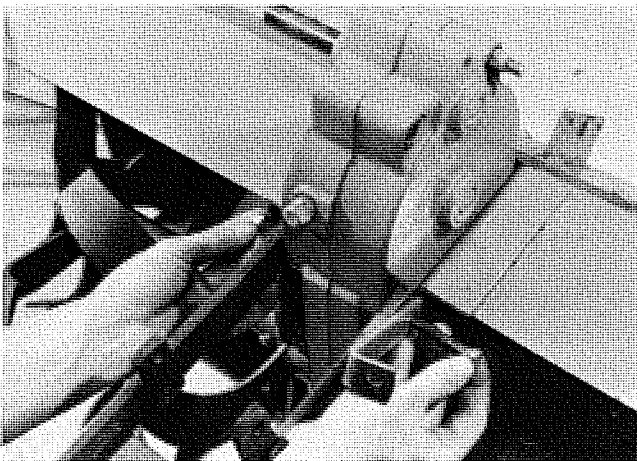

FIG. 2. Install Hitch & Spring Bracket Using $\frac{3}{8}$ -16 x $5\frac{1}{2}$ Bolt

Remove the $\frac{3}{8}$ -16 x $4\frac{1}{2}$ bolt located just forward of the $\frac{3}{8}$ -16 x $5\frac{1}{2}$ bolt. Align the "Mounting Ears" of the Hitch Assembly with the hole in the tiller gear box and reinstall the $\frac{3}{8}$ -16 x $4\frac{1}{2}$ bolt (Fig. 3). TIGHTEN BOTH BOLTS.

Note: The "Mounting Ears" are designed to be a tight fit on the tiller case.

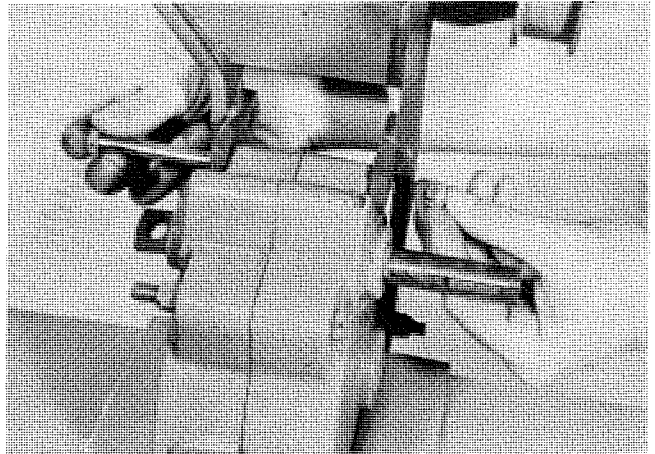

FIG. 3. Secure Mounting Ears with $\frac{3}{8}$ -16 x $4\frac{1}{2}$ Bolt

MOUNT DRIVE PULLEY (Fig. 4)

Attach the large Drive Pulley to the input shaft of the tiller. The drive pulley is installed with the hub toward the tiller gear case.

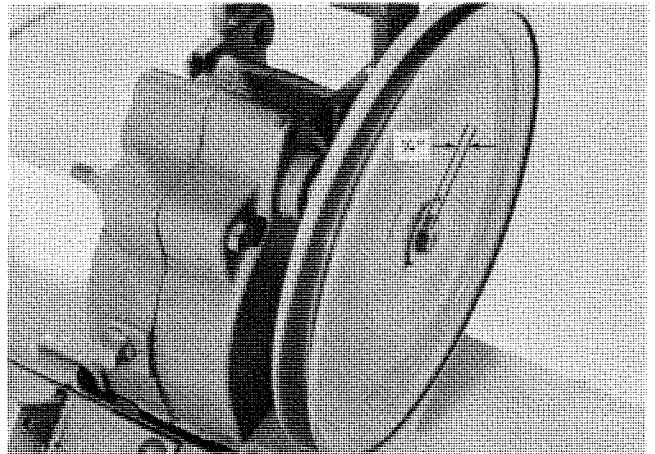

FIG. 4. Mount Drive Pulley

Note: For correct belt alignment, there should be a $\frac{1}{4}$ " gap between the end of the input shaft and the outside edge of the pulley.

INSTALLATION

MOUNT LIFT LEVER (Fig. 5)

Slip the lift lever assembly into the two holes at the top of the uprights of the rear seat pan support bracket (Fig. 1). The larger lift arm should be on the left side of the lift lever. Slip a bushing into each hole and secure the lift lever with an "E" ring outside of the bearings (Fig. 1).

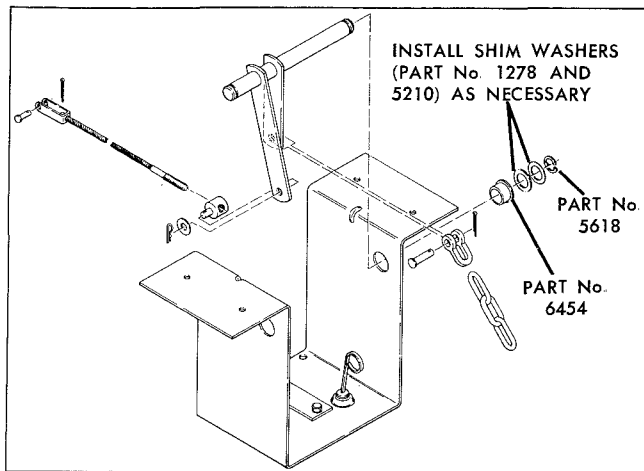

FIG. 5. Mount Lift Lever

INSTALL LIFT CABLE (Fig. 6 & 7)

The lift cable assembly is installed into the tube provided on top of the transmission. The cable is installed from the front of the tube, by sliding the threaded stud of the cable into the tube.

Attach the Clevis (on the front side of the cable) to the lowest hole of the tractor lift arm using a clevis pin and cotter pin.

Install the trunnion onto the threaded stud of the lift cable.

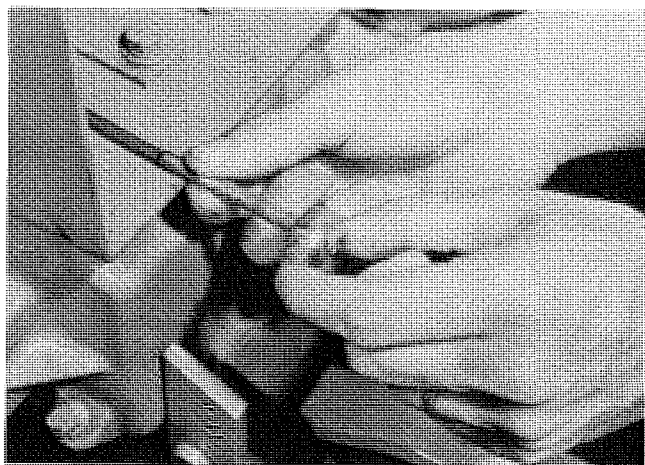

FIG. 6. Install Trunnion onto Cable

Slip the trunnion into the long arm of the lift lever and secure with a washer and hairpin cotter.



FIG. 7. Mount Trunnion into Long Lift Arm

ASSEMBLE REAR "QUICK HITCH" (Fig. 8 & 9)

Locate the Hitch Mounting Bracket, two Latching Plates, two Metal Links, two $\frac{3}{8}$ -16 x 1 Hex Bolts, two $\frac{3}{8}$ Washers, six $\frac{3}{8}$ -16 E.S. nuts, two Angle Spacers, and four $\frac{3}{8}$ -16 x $3\frac{1}{2}$ Carriage Bolts.

Attach the two Latching Plates to the Hitch Mounting Bracket using the $\frac{3}{8}$ -16 x 1 Hex Bolts, $\frac{3}{8}$ Washers and $\frac{3}{8}$ -16 E.S. Nuts. The washers are used between the bolt head and the Latching Plate. The Latching Plates are installed on the inside of the Mounting Bracket (Fig. 9). Tighten bolts so the latching plates will move with a small amount of force.

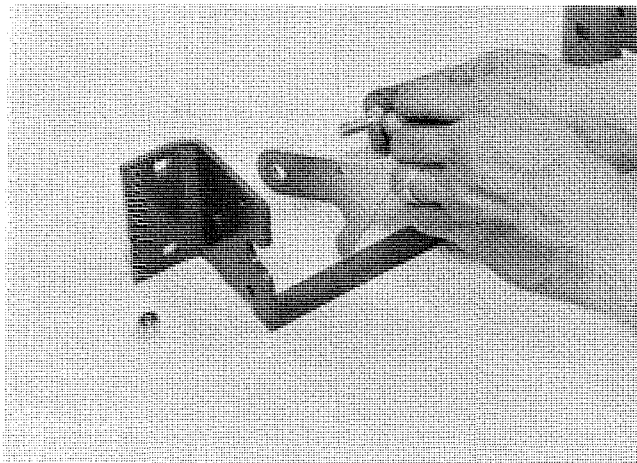

FIG. 8. Attach Latching Plates to Mounting Bracket

Install the two metal links to the Hitch Mounting Bracket using two $\frac{3}{8}$ -16 x $3\frac{1}{2}$ Carriage Bolts and two $\frac{3}{8}$ -16 E.S. Nuts. Install the "Right Angle" link on the left side of the hitch so the side with two holes faces rearward. Install the bolts in the holes farthest from the latching plates (Fig. 9). Finger tighten nuts only.

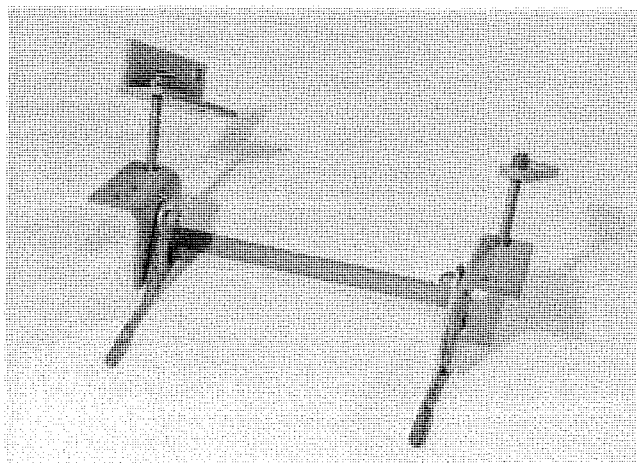

FIG. 9. Install Metal Links

ATTACH REAR QUICK-HITCH TO AXLE (Fig. 10 & 11)

From the rear of the tractor, install the Rear Hitch assembly to the tractor's rear axle housings. This is done by placing the hitch assembly under the tractor's transmission so the latch plate ends face rearward. Turn the Metal Links toward the front of the tractor (Fig. 10).

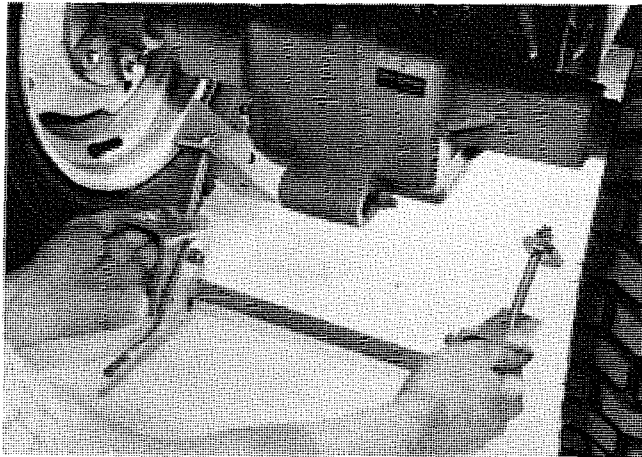

FIG. 10. Attach Rear Hitch

Raise the Rear hitch so the hitch touches the bottom of the axle housing. Turn the metal links rearward so they hold the hitch in place. Install the two remaining $\frac{3}{8}$ -16 x $3\frac{3}{4}$ Carriage bolts in the rear mount holes and secure with two $\frac{3}{8}$ -16 E.S. nuts.

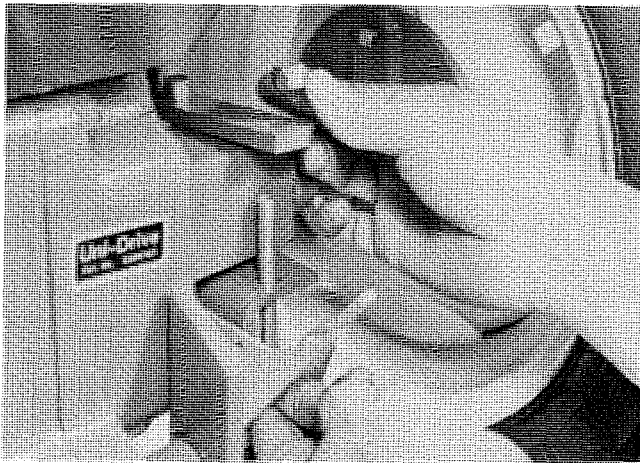

FIG. 11. Install two $\frac{3}{8}$ -16 x $3\frac{3}{4}$ Carriage Bolts & Nuts

Note: On some model tractors, it may be necessary to use the Angle Spacers to take out undue slack between the hitch and the rear axle. If necessary, install the Angle Spacers between the Metal Links and the tractor axle housings.

Center the Rear Hitch evenly between the rear wheels. Tighten the $\frac{3}{8}$ -16 nuts evenly to insure maximum strength.

REMOVE DRAWBAR HITCH (Fig. 12)

Remove one of the retaining rings from the shaft holding the Drawbar Hitch to the transmission case. Remove the shaft, being careful to retain the two spacers between the hitch and the transmission case. If the tractor is equipped with a Slot or Clevis Hitch, as well as the Drawbar Hitch, the Slot or Clevis Hitch must also be removed. Assemble all loose pieces onto the shaft and replace the retaining ring onto the shaft.

Note: If the tractor will be used at a later date without the tiller, the drawbar hitch, shaft, spacers and any other implement hitches removed should be retained so they may be replaced when the tiller is removed from the tractor.

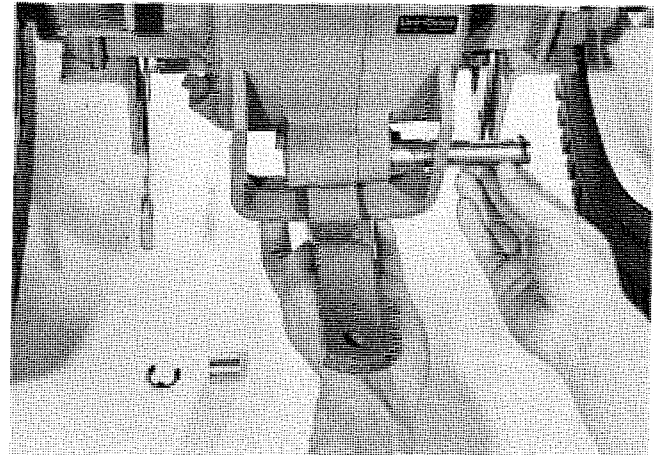

FIG. 12. Remove Drawbar Hitch

MOUNT TILLER (Fig. 13, 14 & 14A)

Open the left Hitch Latch and temporarily leave the right Latch in it's closed position. Maneuver the tiller so the Mounting Rod at the front of the Hitch Assembly lies just below the rear "Quick Hitch". AT THIS POINT ALIGNMENT (SIDE TO SIDE) IS CRITICAL (Fig. 14).

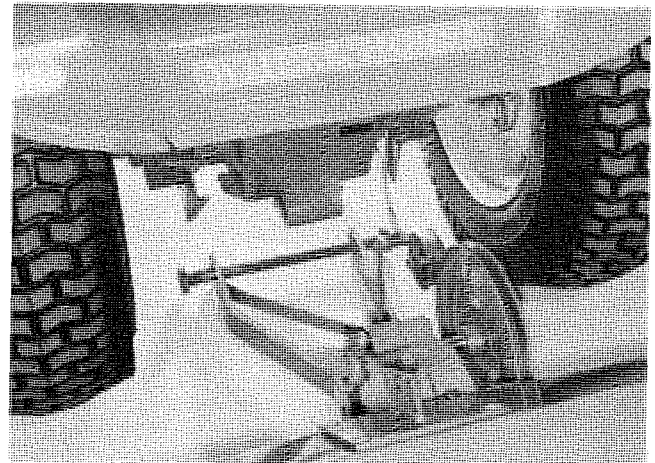

FIG. 13. Position Tiller Under Quick Hitch

Raise the Mounting Rod of the Hitch Assembly into the Quick Hitch. As the Mounting Frame is raised, open the right Hitch Latch so the tiller Mounting Frame can enter the Quick Hitch.

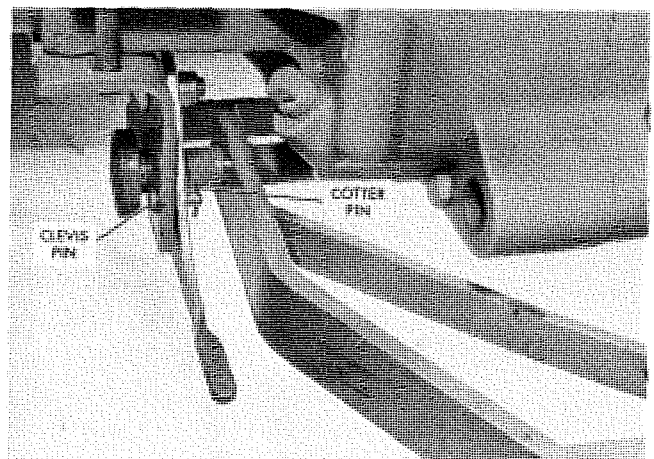

FIG. 14. Raise Tiller into Quick Hitch

Close both Hitch Latches by pushing down on the handles. Tighten the Bolts holding the Hitch Latches to the Quick Hitches. Install a Clevis Pin into each Hitch Latch so the clevis pin engages the Quick Hitch. This will keep the Latches from opening when the tiller is used in hard ground. Secure the Clevis Pins with Cotter Pins.

ATTACH LIFT CHAIN (Fig. 15)

Install the Lift Chain between the Short Lift Arm and the top hole of the Lift Plate as shown in Fig. 15.

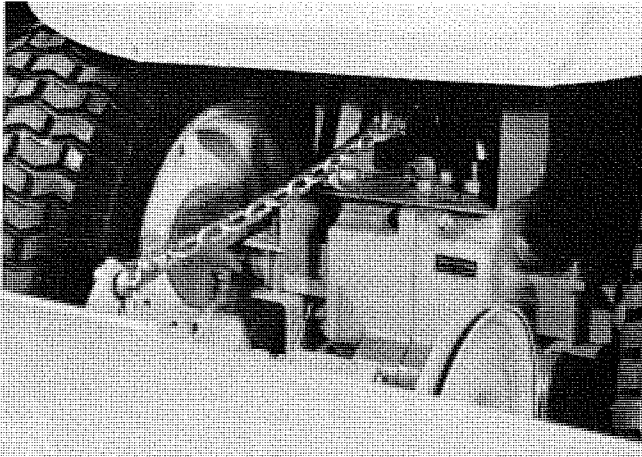

FIG. 15. Attach Lift Chain

INSTALL SPRING ASSIST (Fig. 16)

Lift the tiller to its maximum height using the tractor's attachment lift. Slip one end of the heavy spring into the left metal link at the top of the Quick Hitch. Slip the other end of the Spring into the large Eye Bolt. Thread a $\frac{3}{8}$ -16 E.S. nut onto the Eye Bolt and install the Eye Bolt through the Spring Bracket, attached to the bottom of the tiller, and secure the Eye Bolt with another $\frac{3}{8}$ -16 E.S. nut. The Spring should be adjusted so there is a slight amount of tension while the tiller is fully raised.

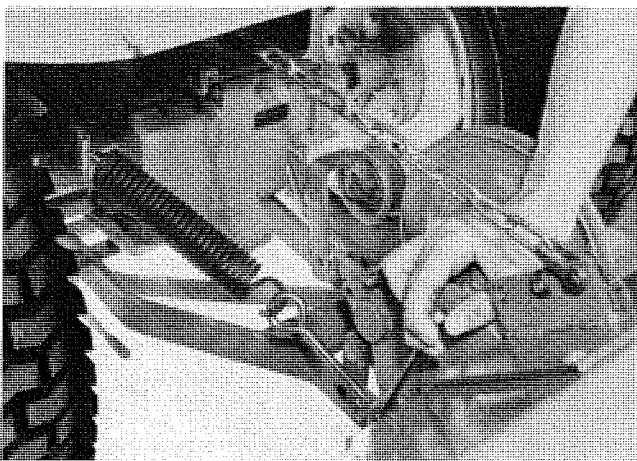

FIG. 16. Install Assist Spring

INSTALL BELT ON PTO PULLEY (Fig. 17)

Remove the hairpin cotter that retains the adjustment trunnion to the PTO Engagement Plate. Remove the clevis pin that secures the Yoke Assembly to the Clutch Shaft. Remove the Bolt, Spacer and Nut that hold the PTO Engagement Plate to the bracket on the engine.

Slip the belt between the Yoke Assembly and PTO Pulley and onto the pulley (Fig. 17).

Note: Correctly installed, the Yoke will be positioned between the two sides of the belt (see Fig. 19).

Reinstall the PTO Engagement Plate, the Yoke and the adjustment trunnion.

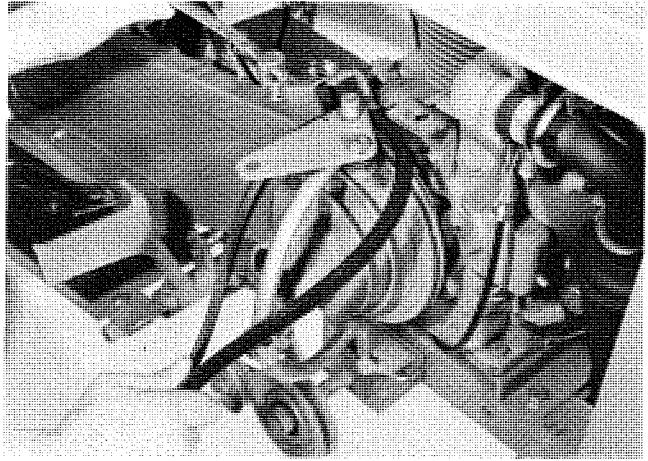

MOUNT MID MOUNT IDLERS (Fig. 18 & 19)

Open the mid Tach-a-Matic™ hitch. Slip the Mid Mount Idlers into the hitch and close the latch (Fig. 18).

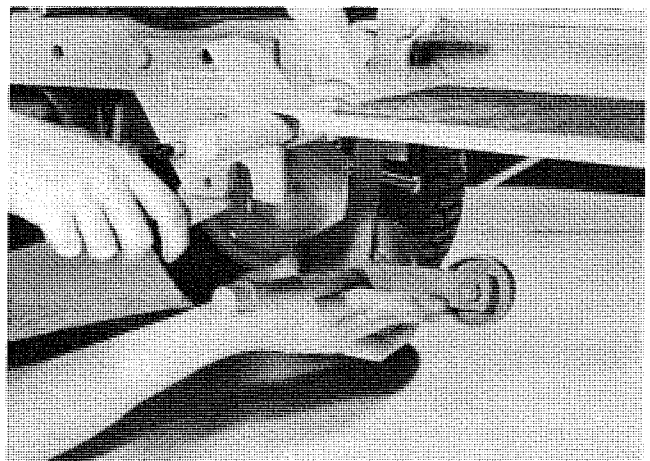

FIG. 18. Install Mid Mount Idlers

Slip the $\frac{3}{8}$ -16 x $2\frac{3}{4}$ Bolt through the light spring. Thread a $\frac{3}{8}$ -16 nut onto the bolt. Install the bolt into the hole in the frame just behind the Mid Tach-a-Matic hitch. Add another $\frac{3}{8}$ -16 nut so the two nuts sandwich the tractor frame.

On 1973 and prior model tractors, remove the bolt holding the footrest to the belt guard. Replace it with a $\frac{5}{16}$ -18 x 1 bolt. Thread a $\frac{5}{16}$ -18 Eslok nut on the end of the bolt, leaving room to hook the idler spring over the bolt between the nut and the belt guard. Then connect the spring to both the bolt and the idler arm.

INSTALL DRIVE BELT (Fig. 19 & 20)

Guide the belt past the Mid Mount Idlers as shown in Fig. 19. Note that the smaller pulley rides on the back side of the belt.

Route the belt onto the two pulleys on the tiller as shown in Fig. 20. **Note: It is not necessary to remove rear tire to install belt.** Check the belt to be sure it has no twists, and that all pulleys and idlers are aligned with each other.

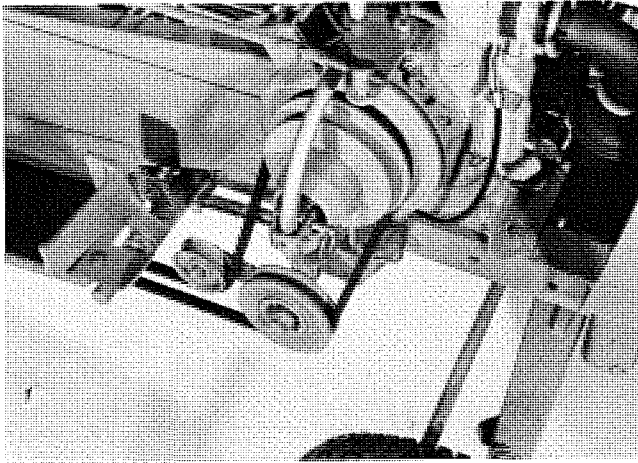

FIG. 19. Route Belt Past Idlers

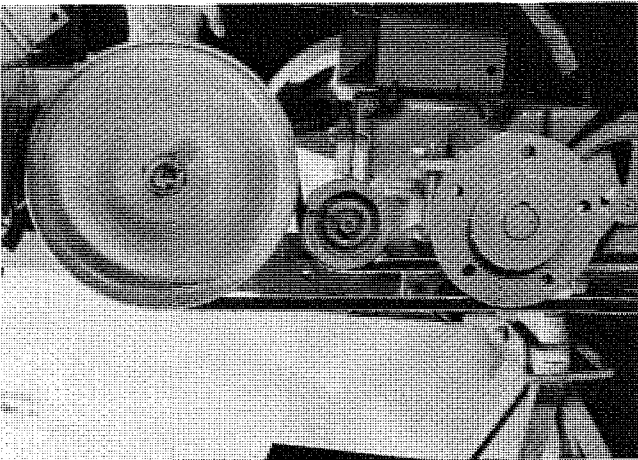

FIG. 20. Guide Belt Onto Tiller Pulleys

REMOVAL

The tiller can be removed from the tractor by the following procedure:

1. Remove the drive belt.
2. Remove the Mid-Mount Idlers.
3. Remove the tiller from the tractor by disconnecting the lift chain, the spring assist and opening the rear Quick Hitch.

For more detailed Removal Instructions consult the "Installation Instructions" in the areas mentioned above.

OPERATION

For maximum traction and steering control, both front and rear wheel weights, as well as cleat tires or tire chains are recommended when using the tiller.

8 SPEED TRANSMISSIONS

If the tractor is equipped with an 8-speed transmission, the tractor should be used in "LOW" Range. The slower the ground speed, the more aggressive the action of the tiller.

AUTOMATIC TRANSMISSION

If the tractor is equipped with an Automatic Transmission, the tractor should be used with the engine at "FULL" throttle. Ground speed should be kept between 0.5 and 1.5 MPH using the Motion Control Lever. The slower the ground speed, the more aggressive the action of the tiller.

⚠ CAUTION ⚠

When tilling sod, gumbo, or virgin soil, the tiller may have a tendency to "push" the tiller. If the tiller pushes the tractor, shut off the tiller immediately by disengaging the PTO clutch.

If the tiller "pushes" the tractor, the tiller should be raised so the tines penetrate only the top layer of the ground. The tiller can be relowered to its normal depth on succeeding passes.

For best results, the ground may have to be tilled twice. If the terrain permits, till the second pass at a 90° angle to the first.

Do not overtill the soil. Soil tilled too finely will not absorb water, and cause puddling and water run-off. The soil will also become compacted more readily.

⚠ CAUTION ⚠

Always stop engine and remove ignition key from the tractor before attempting to clear tiller of rock, or debris, or attempting to work on the tiller.

ADJUSTMENTS

The tiller has three basic height adjustment positions. Installing the lift chain in the top hole of the Lift Plate (Fig. 15) will allow for maximum ground clearance while transporting the tiller. The middle hole will provide normal operation and allow the tiller to penetrate about 4" deep. The lowest hole provides maximum tilling depth; it may be necessary, however, to move the chain to a higher position to transport the tiller.

The two outside tines can be removed, reducing the effective tilling width to 30". This is especially helpful when tilling hard ground.

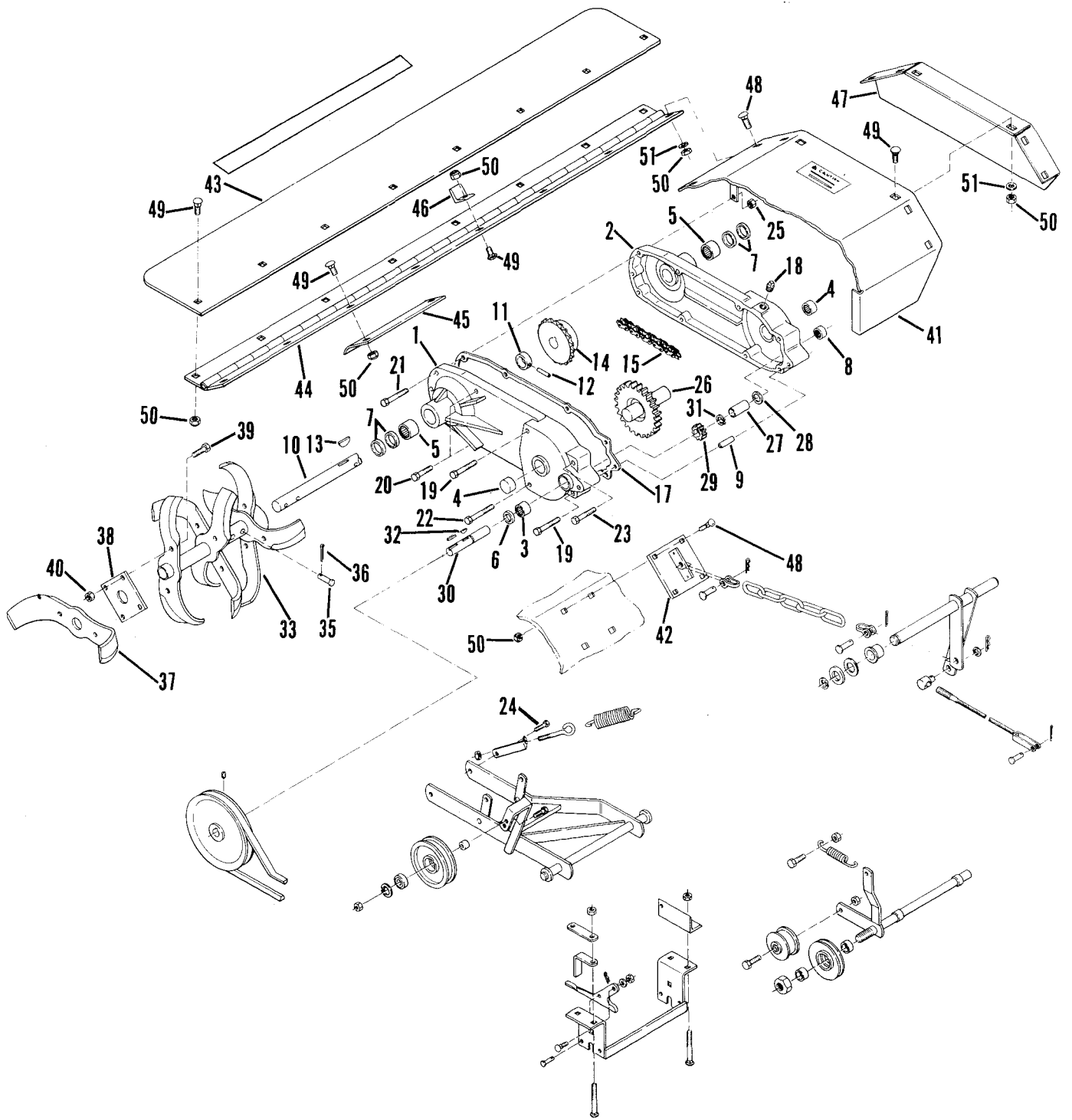

**PARTS LIST FOR 36" TILLER
FACTORY ORDER NUMBER 77-36TL01**

Parts available only through Authorized Dealers.
When ordering parts always list Part No. and Description.
(Specifications subject to change without notice.)

ITEM NO.	PART NO.	DESCRIPTION	NO. REQ'D.
1	6836	R. H. Case (w/Bearings)	1
2	6839	L. H. Case (w/Bearings)	1
3	1540	Needle Bearing $\frac{3}{4}$ ID x $\frac{1}{2}$	1
4	1532	Needle Bearing 1 ID x $\frac{3}{4}$ Closed End	2
5	6838	Needle Beaeing $1\frac{1}{4}$ ID x 1	2
6	100441	Seal $\frac{3}{4}$ ID	1
7	103118	Seal $1\frac{1}{4}$ ID	4
8	1529	Needle Bearing $\frac{3}{4}$ ID x $\frac{3}{4}$ Closed End	1
9	933242	Roll Pin $\frac{3}{8}$ x 1	2
10	6842	Tine Shaft	1
11	6843	Spacer	1
12	933232	Roll Pin $\frac{5}{16}$ x 2	1
13	937058	Woodruff Key #128	1
14	6845	Sprocket, 20 Teeth	1
15	6848	Chain, $\frac{3}{4}$ Pitch, 44 Pitches	1
17	6851	Gasket	1
18	943421	Pipe Plug, $\frac{1}{2}$ -14	2
19	908143	Hex Bolt $\frac{3}{8}$ -16 x 5	1
20	908041	Hex Bolt $\frac{3}{8}$ -16 x $2\frac{3}{4}$	3
21	908043	Hex Bolt $\frac{3}{8}$ -16 x $3\frac{1}{2}$	1
22	908144	Hex Bolt $\frac{3}{8}$ -16 x $4\frac{1}{2}$	1
23	908149	Hex Bolt $\frac{3}{8}$ -16 x $5\frac{1}{2}$	1
24	908044	Hex Bolt $\frac{3}{8}$ -16 x 4	1
25	915663	Elastic Stop Nut $\frac{3}{8}$ -16	8
26	6894	Reduction Gear Assy. (w/Shaft)	1
	6895	Reduction Gear	1
	6898	Shaft	1
27	6963	Spacer	1
28	1535	Thrust Washer	1
29	3528	Pinion Gear	1
30	104387	Input Shaft	1
31	936125	Snapping - $\frac{3}{4}$ Dia.	1
32	937014	Key #9 Woodruff	1
33	9204	R. H. Tine Assy.	1
	9205	L. H. Tine Assy.	1
35	9208	Tine Tube Clevis Pin	4
36	932017	Cotter Pin $\frac{1}{8}$ x 1	4
37	9206	R. H. Outside Tine	1
	9207	L. H. Outside Tine	1
38	9203	Outside Tine Mounting Plate	2
39	908046	Hex Bolt $\frac{7}{16}$ -14 x 1	8
40	915114	Eslok Nut $\frac{9}{16}$ -14	8
41	105546	Tiller Tine Shield	1
42	105549	Lift Plate	1
43	104437	Rear Shield	1
44	104438	Rear Shield Hinge	1
45	104436	Lower Rear Shield Stop	2
46	2595	Upper Rear Shield Stop	1
47	104434	Tiller End Cover	2
48	900037	Carriage Bolt $\frac{5}{16}$ -18 x $\frac{3}{4}$	6
49	900036	Carriage Bolt $\frac{5}{16}$ -18 x $\frac{5}{8}$	24
50	915112	Eslok Nut $\frac{5}{16}$ -18	30

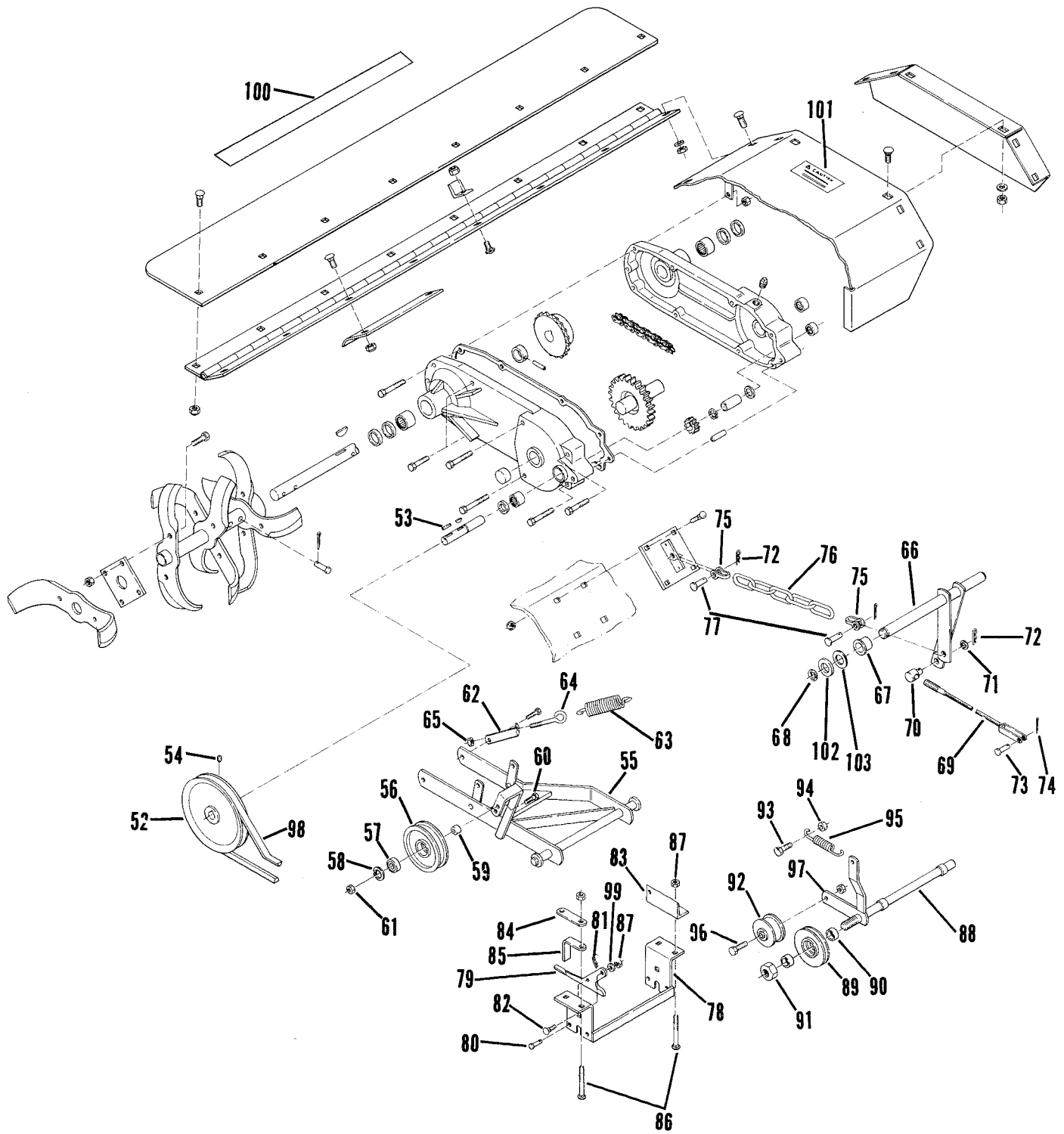

**PARTS LIST FOR 36" TILLER
FACTORY ORDER NUMBER 77-36TL01**

Parts available only through Authorized Dealers.
When ordering parts always list Part No. and Description.
(Specifications subject to change without notice.)

ITEM NO.	PART NO.	DESCRIPTION	NO. REQ'D.
51	920008	Washer $\frac{5}{16}$ SAE	12
52	6844	Pulley	1
53	1005	Square Key	1
54	7977	Set Screw $\frac{5}{16}$ -18 x $\frac{1}{2}$ Sq. Hd.	2
55	105543	Tiller Hitch	1
56	105874	Idler Pulley	1
57	4567	Bearing	1
58	936024	Snapping $1\frac{3}{8}$ Dia.	1
59	2138	Spacer	1
60	911404	Hex Bolt $\frac{3}{8}$ -16 x $1\frac{5}{8}$ Special	1
61	915113	Eslok Nut $\frac{3}{8}$ -16	1
62	104448	Spring Bracket	1
63	4629	Spring (Heavy)	1
64	100653	Eye Bolt	1
65	915663	E. S. Nut $\frac{3}{8}$ -16	1
66	105539	Lever Assy.	1
67	6254	Bushing	2
68	5618	E-Ring	2
69	105542	Lift Cable	1
70	104524	Trunnion	1
71	920009	Washer $\frac{3}{8}$ SAE	1
72	933504	Hairpin	3
73	932120	Clevis Pin	1
74	932000	Cotter Pin $\frac{1}{16}$ x $\frac{1}{2}$	1
75	105820	Clevis	2
76	105550	Lift Chain	1
77	105821	Clevis Pin	2
78	104659	Mounting Bracket	1
79	104657	Hitch Latch	2
80	932120	Clevis Pin	2
81	933504	Hairpin	2
82	900063	Carriage Bolt $\frac{3}{8}$ -16 x 1	2
83	104845	Link	1
84	3697	Link	1
85	7713	Axle Spacer	2
86	900073	Carriage Bolt $\frac{3}{8}$ -16 x $3\frac{1}{2}$	4
87	915113	Eslok Nut $\frac{3}{8}$ -16	5
88	104089	Mid Mount Idler Frame	1
89	104974	Idler Pulley	1
90	7038	Spacer	2
91	915640	E. S. Nut $\frac{3}{4}$ -16 Jam	1
92	MW8821	Flat Idler Pulley	1
93	908036	Hex Bolt $\frac{3}{8}$ -16 x $1\frac{1}{2}$	1
	908041	Hex Bolt $\frac{5}{16}$ -18 x 1	1
94	915113	Eslok Nut $\frac{3}{8}$ -16	3
95	6135	Idler Spring (Light)	1
96	960179	Whizlock Bolt $\frac{5}{16}$ -18 x 1	1
97	915112	Eslok Nut $\frac{5}{16}$ -18	1
98	1599	Drive Belt	1
99	920009	Washer - $\frac{3}{8}$ SAE	2
100	103174	Decal - Wheel Horse	1
101	105003	Decal - Caution	2
102	1278	.050" Shim Washer	2
103	5210	.015" Shim Washer	2

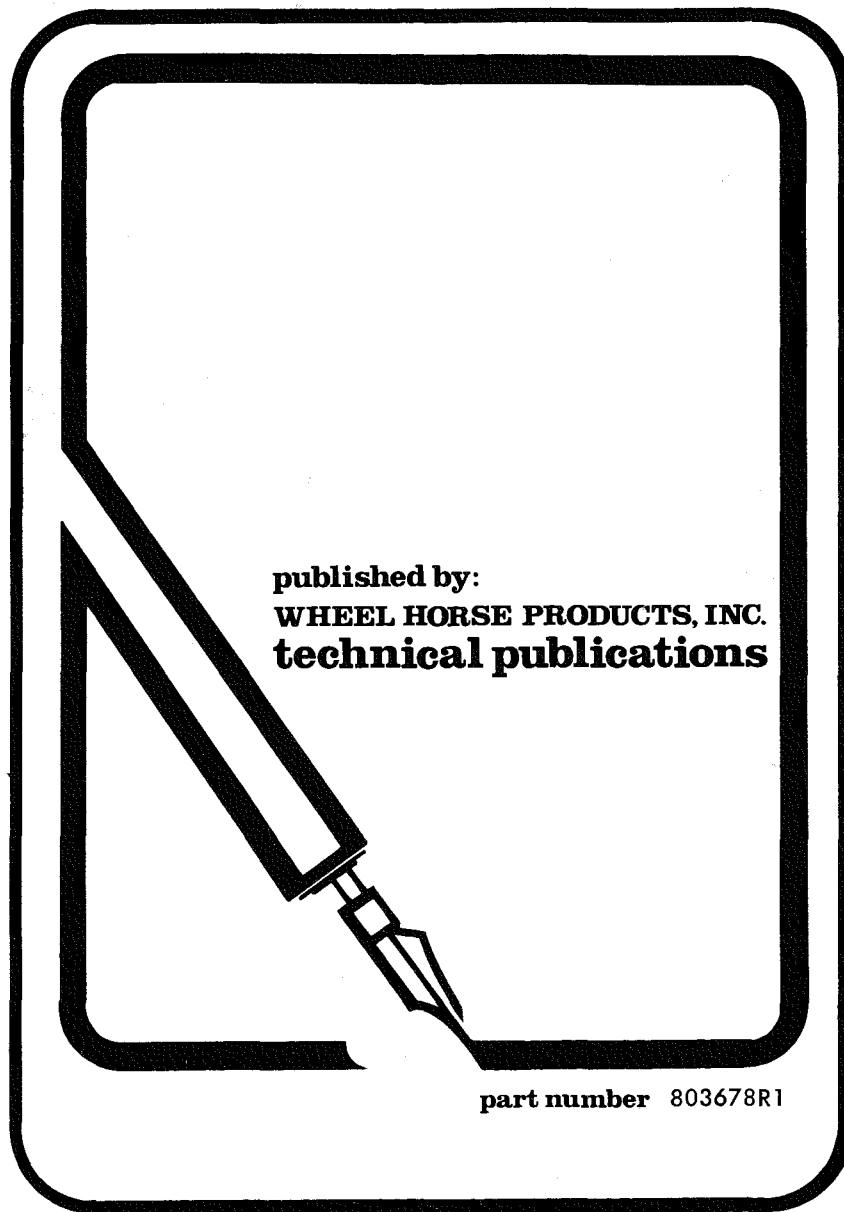

At the time of printing, product information and specifications, as shown, were correct. Wheel Horse Products, Inc. reserves the right to change product specifications, designs and standard equipment without notice and without incurring obligation.



WHEEL HORSE
lawn & garden tractors

515 West Ireland Road, South Bend, Indiana 46614

Wheel Horse Service Bulletins 1961 - 1990: **#220** Issued: February 1978
36" Tiller Conversions - Slot and Clevis Hitch Conversions

[Previous](#) [Table of Contents](#) [Next](#)

To All Dealers:

1. Problem:

1.1 New rear lift on 1978 C-Series tractors will not accomodate 1977 and 1976 tillers (VIN 67-36TL01, 77-36TL01, 77-36TL02) or 1977 and 1976 slot and clevis hitches (8-5522, 8-5523, 8-5512, 8-5513).

1.2 Old rear lift on 1976 and 1977 B & C Series tractors will not accomodate 1978 tiller (VIN 87-36TL01) or 1978 slot and clevis hitches (8-5524, 8-5514).

2. Solution:

2.1 1976 and 1977 tillers (VIN 67-36TL01, 77-36TL01, 77-36TL02) and 1976 and 1977 slot and clevis hitches (8-5522, 8-5523, 8-5512, 8-5513) can be updated to fit 1978 tractors by employing Service Assembly 106629 (installation instructions with S/A).

2.1.1 If adapting a slot hitch (8-5512, 8-5513) cut 1-1/4" off of the "handle" end of the 8228 hitch pin. This will prevent the possibility of the hitch pin striking the fuel tank on 1978 tractors.

2.2 1978 tiller (VIN 87-36TL01) and 1978 slot and clevis hitches (8-5524, 8-5514) can be adapted to fit 1976 and 1977 B & C Series tractors by employing Service Assembly 105162 and proceeding as follows:

2.2.1 Delete following parts from the 1978 tiller (VIN 87-36TL01) and 1978 slot and clevis hitches (8-5524, 8-5514):

106532 Lever Assembly
106619 Lock Bracket
908016 Bolt 5/16-18 x 5/8
920082 Lockwasher 5/16

Also delete from tiller:

960179 Whizlock Bolt 5/16-18 x 1
915112 Eslok Nut 5/16-18

2.2.2 Add the following parts, contained in S/A 105162:

105539 Lever Assembly
105820 Clevis
105821 Clevis Pin
932017 Cotter Pin

908041 Bolt 3/8-16 x 2-3/4 (tiller only)
 915113 (2) Eslok Nut 3/8-16 (tiller only)

2.2.3 Install rear lift lever assembly (105539) as shown in Fig. 1

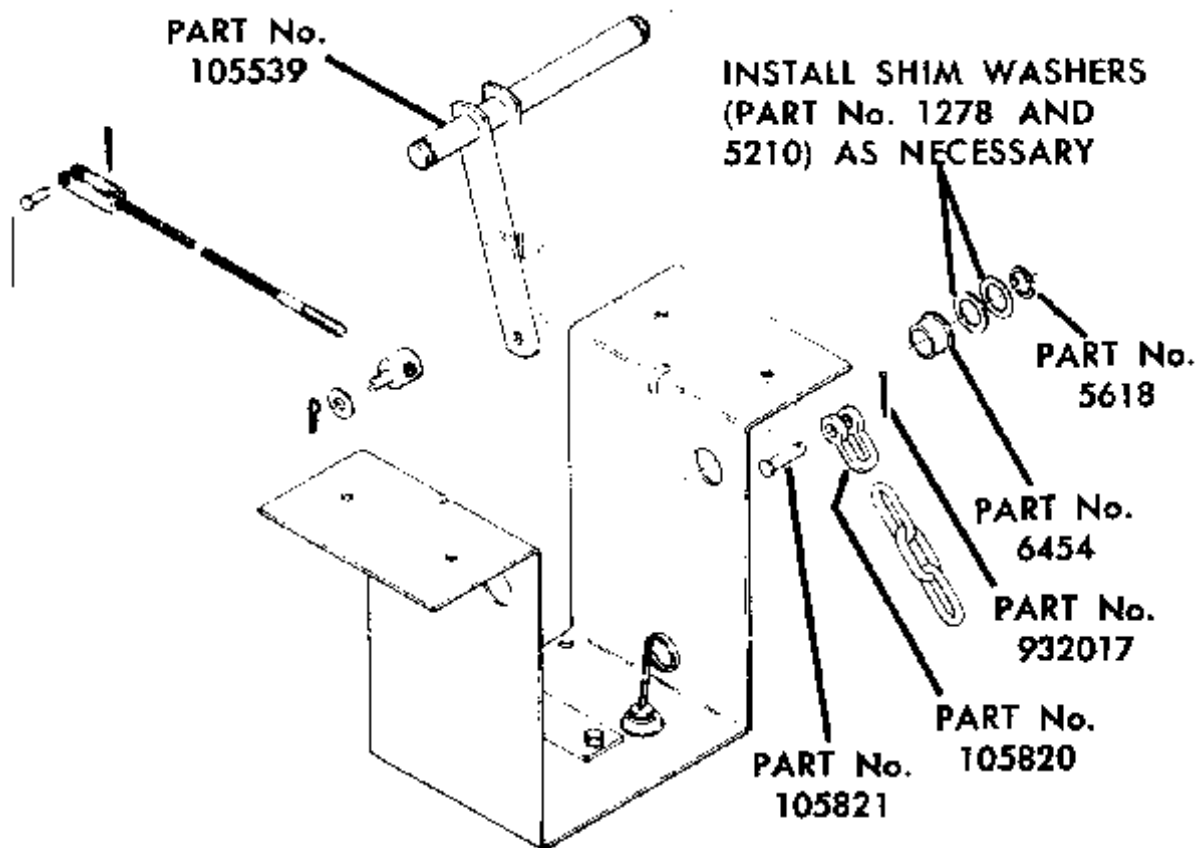

Fig. 1 1976 and 1977 rear lift lever installation

Fig. 1 1976 and 1977 rear lift lever

installation

2.2.4 On tillers only, the supplied 3/8-16 x 2-3/4 bolt and two 3/8-16 nuts are used to attach the mid-mount idler pulley spring. Refer to mounting instructions for tiller VIN 77-36TL02, Fig. 18; microfiche card 13 pink grid E-2.

2.2.5 Additional operating depth or transport height of rear mounted attachments can be gained by shortening or lengthening the lift chain. The lift chain is shortened, for additional attachment height, by installing the clevis (#105820) into the second or third link from the lower end. The lift chain is lengthened, for additional operating depth, by installing the clevis (#105820) into the first or second link from the lower end.

Wheel Horse Service Bulletins 1989 - 1990: **T Series #T10** Issued: July 1990
Slot & Clevis Hitch Conversions, 36" Tiller Conversions

[Previous](#) [Table of Contents](#) [Next](#)

TO ALL DEALERS:

1. Subject

1.1 The following table summarizes all backfit/conversion information applying to the slot and clevis hitch and the 36" tiller. This equipment is used on:

1969-73 Long Frame Tractors

1974-77 B and C-Series Tractors

1978 and Later C,GT,3/4/500-Series

1.2 This information is most often useful when a customer purchases a new tractor and wishes to keep the original older hitch or 36" tiller. (Tiller 07-36TL02 and later fit 1978 and later tractors with no added parts or alterations required.)

2. Service Action

2.1 To use the table properly it is essential that you know the EXACT 8-Series number or VIN of the hitch or tiller and the correct model year of the tractor.

3. Installation Information/Original Service Bulletin Reference

S/A 105104 - Instructions with S/A; Original Bulletin #179A

S/A 105105 - Instructions with S/A; Original Bulletin #180A

S/A 105111 - Instructions with S/A; Original Bulletin #180A

S/A 105112 - Instructions with S/A; Original Bulletin #179A

S/A 105162 - Instructions on Original Bulletin #220

S/A 106629 - Instructions with S/A; Original Bulletin #220

ROUTING	SERVICE MANAGER	SALES MANAGER	PARTS MANAGER	CHIEF MECHANIC	MECHANIC NO 1	MECHANIC NO 2	MECHANIC NO 3	MECHANIC NO 4	RETURN THIS TO
INITIAL HERE									

>

OBTAIN THE INDICATED SERVICE ASSEMBLY/PARTS TO INSTALL IT ON A:

WHEN YOU HAVE A	1969-75 TRACTOR	1976-77 TRACTOR	1978 and LATER TRACTOR
-----------------	-----------------	-----------------	------------------------

CLEVIS HITCH:

8-5511	*	S/A 105112	N/A
8-5512	S/A 105104	*	S/A 106629, Note 1
8-5513	S/A 105104	*	S/A 106629, Note 1
8-5514	S/A 105104	S/A 105162	*, Note 1
8-5515	S/A 105104	S/A 105162	*

SLOT HITCH:

8-5521	*	S/A 105112	N/A
8-5522	S/A 105104	*	S/A 106629, Note 1
8-5523	S/A 105104	*	S/A 106629, Note 1
8-5524	S/A 105104	S/A 105162	*, Note 1
8-5525	S/A 105104	S/A 105162	*

TILLER:

7-1251	Note 2	Note 2	Note 2	
7-1252	*	S/A 105111	S/A 106629, Note 3	
67-36TL01	S/A 105105	*	S/A 106629, Note 1, 4, 5	..
77-36TL01, 02	S/A 105105	*	S/A 106629, Note 1, 4, 5	
87-36TL01	S/A 105105	S/A 105162	*, Note 1, 4, 5	
97-36TL01	S/A 105105	S/A 105162	*, Note 1, 4, 5	
07-36TL01	S/A 105105	S/A 105162	*, Note 1, 4, 5	

* Indicates original application; fits "as supplied", unless otherwise noted.

NOTES

1. Automatic tractors with an "E" in the VIN (Eaton Hydrostatic Transmission) also require 108144 Lift Cable and 108143 Clevis.

2. Check that tiller has been updated according to Service Bulletin #145, then follow 7-1252 information. If brace on tiller frame prevents raising tiller, cut brace out and re-weld lower on frame.

3. The following parts are also required, as applicable. Figure 1 shows the hole locations for mounting the lift plate. The lift plate is installed so the lift chain hole is down (closest to gearcase).

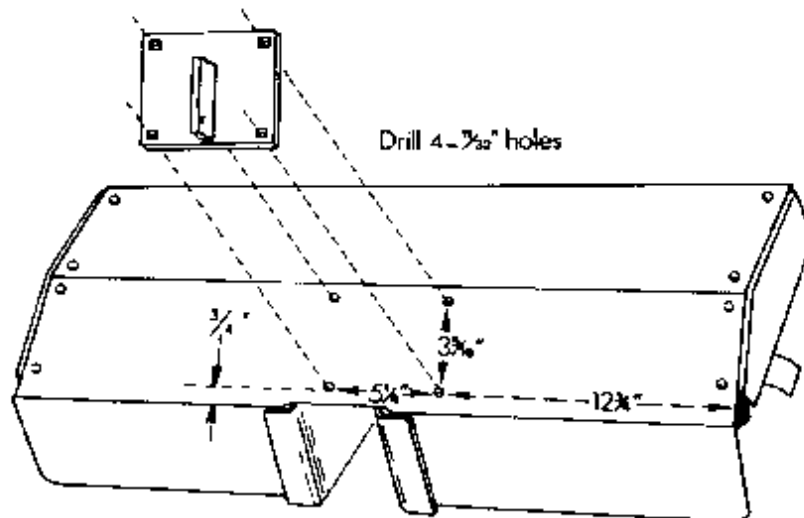

Figure 1. Lift Plate Holes, 7-1252 Modification

All Models

1278 (2) Shim Washer	810191 (1) Tiller Owner's Manual
5210 (2) Shim Washer	(Disregard Belt Guard Instructions,
5618 (2) E-Ring	Fig. 23)
6254 (2) Bushing	900037 (4) Carriage Bolt 5/16-18 x 3/4
104524 (1) Trunnion	915112 (4) Eslok Nut 5/16-18
105820 (1) Clevis	920009 (1) Washer 3/8 SAE
105821 (1) Clevis Pin	932000 (1) Cotter Pin 1/16 x 1/2
108144 (1) Lift Cable	932120 (1) Clevis Pin
	933504 (2) Hairpin Cotter

8-Speed and Sundstr and Auto. Only

108145 (1) Clevis, Short

Eaton Auto. Only

108143 (1) Clevis, Long

Twin Cylinder Models

103635 (1) Drive Belt

4. Twin cylinder models require drive belt 103635.

5. Automatic tractors with Eaton hydrostatic transmission: if the LH (right angle) bracket on the rear hitch interferes with the oil filter, replace it with 108485 bracket. The original bracket can also be modified by cutting off material as required to eliminate the interference. The lift assist spring is not used in this case.

Toro Service Bulletins 1991 - Present: Garden Tractors #14 Issued: July 1993
Toro Wheel Horse "T" Bulletins

[Previous](#) [Table of Contents](#) [Next](#)

PRODUCT: Garden Tractors

SUBJECT: Service Bulletin Information

SITUATION: Some Toro Wheel Horse Service Bulletins issued during the 1990 model year ("T" prefix bulletins) are applicable to 1991 and later products. For ease in identifying and finding this information, a listing of product, subject matter and bulletin number follows. In addition to the paper copies, "T" prefix service bulletins are contained on Wheel Horse fiche card Orange 10.1, dated 5-93.

<u>Product</u>	<u>Subject</u>	<u>Bulletin *</u>
3/4/500-Series	Engine Oil & Fuel Recommendations	T7
3/4/500-Series	Servicing New Batteries/Front Wheel Bearing Lubrication	T8
3/4/500-Series	Guidelines for Fluid-filled Tires	T9
3/4/500-Series	Installing Older 36" Tillers or Slot and Clevis Hitches on Newer Tractors	
	-NOTE-	
	1992 and later tractors also require Clamp P/N 108903 and Lift Tube P/N 105845 (8-Speed) or P/N 108315 (Hydro) in addition to parts called for in bulletin.	T10
3/4/500-Series	Eaton Hydrostatic Transaxle Ident.	T11
3/4/500-Series	Use of Loctite on Setscrews	T12
3/4/500-Series	Kohler, Toro Power Plus Regulator Rectifier Troubleshooting	T13
3/4/500-Series	Product Selection Basis	T15
3/4/500-Series	Voltmeter and Indicator Light Circuit Board Electrical Precaution	T16
Product	Subject Bulletin *	
3/400-Series	Oil Level Sensor Switch Servicing, Kohler Single Cylinder Engine	T17
3/400-Series	8-Speed Clutch Idler Dampener Adjustment (Applies to 1 991 Single Cylinder Tractors)	T18
500-Series	Front Wheel Bearing Grease Seal	T19
3/4/500-Series	Replacing Transmission Mounting Plate	T20

3/400-Series	Spark Plug Maintenance, Kohler Engines	T31
3/4/500-Series	Replacement Steering Wheel Insert	T33

*These bulletins are located on Wheel Horse fiche card Orange 10.1,dated 5-93.