

163508
315-3000

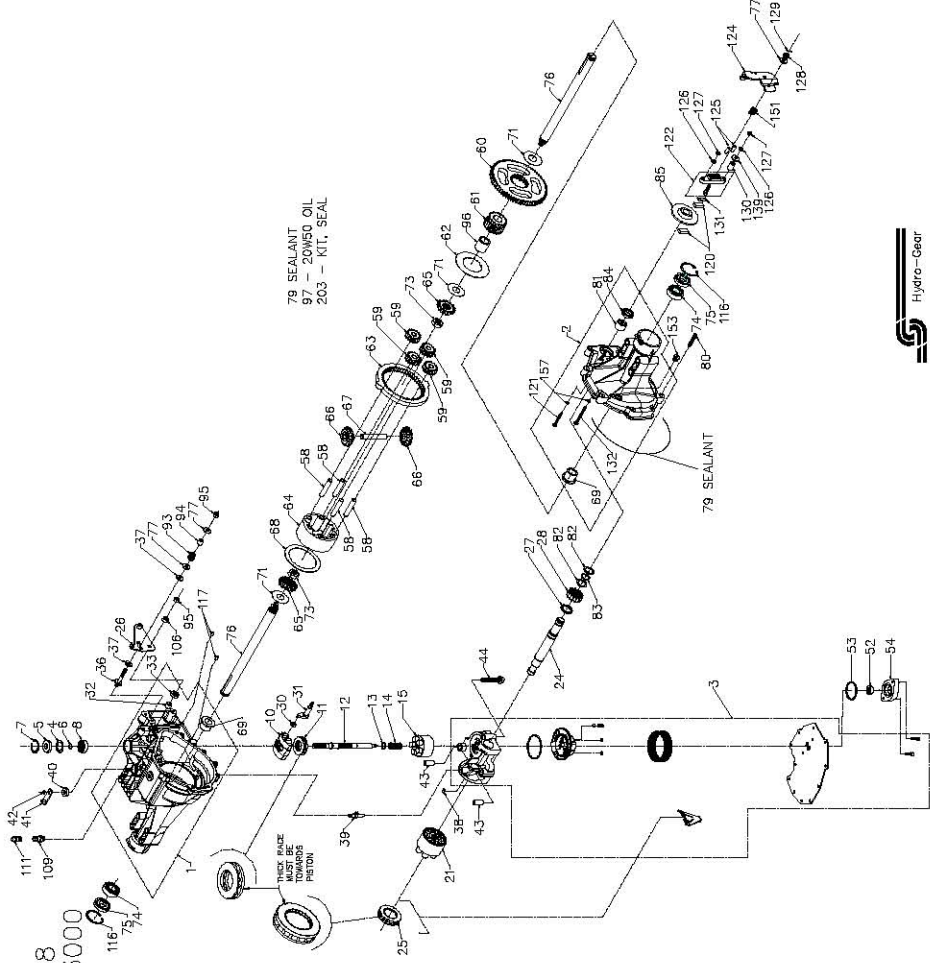

79 SEALANT
97 - 20WED OIL
203 - KIT, SEAL



P.1 of 2. 703370-P3

163508
315-3000

ITEM #	PART #	QTY	DESCRIPTION
1	70297	1	MAIN HOUSING ASSEMBLY
2	70298	1	LIP SEAL
3	70449	1	FLANGE BEARING
		1	TRUNNION BUSHING
		2	GRADLE BEARING
		1	P.H. HOUSING ASSEMBLY
		1	FLANGE BEARING
		2	O-RING
		1	RIB NECK BOLT, 2"
		1	RIB NECK BOLT, 3"
		1	NEEDLE BEARING (SCE1412)
		1	SEAL, LIP .875 X 1.38 X .25
		1	KIT, MANIFOLD
		1	KIT, CENTER SECTION
		1	BEARING 30 X .60 X .50
		1	BUSHING 30 X 1.02 X .75
		1	PLATE, BYPASS
		1	CHECK PLUG ASSEMBLY, .044
		1	CAPSCREW M6 X 1-22
		2	COVER, LOWER
		1	KIT, FILTER
		1	MANIFOLD, CHARGE
		1	RETAINER, MOTOR BEARING
		1	SPRING, RELIEF
		1	BALL 7/16
		2	O-RING .070X.239
		2	SPACER, P.
		1	WASHER, MOTOR BEARING
		1	RETAINING RING
		1	RETAINING RING
		1	BALL BEARING
		1	VARIABLE WASHPLATE
		1	THRUST BEARING 30 X 52 X 13
		1	INPUT SHAFT
		1	LOCK THRUST WASHER
		1	BLOCK THRUST WASHER
		1	10cc CYLINDER BLOCK ASSEMBLY
		1	10cc PISTON
		5	10cc PISTON SPRING
		5	PISTON SEAT WASHER
		5	21cc CYLINDER BLOCK ASSEMBLY
		7	21cc CYLINDER BLOCK
		7	PISTON WASHER
		7	21cc PISTON
		7	21cc PISTON SPRING
		7	THRUST BEARING 42 X 68 X 16
		1	CONTROL ARM
		1	10cc PISTON GEAR
		2	CAPSCREW M6 X 1-22
		1	SLOT GUIDE
		1	TRUNNION ARM
		1	TRUNNION BUSHING

ITEM #	PART #	QTY	DESCRIPTION
125	44127	2	PINS, BRAKE
126	43177	2	LOCKWASHER, 1/4"
127	43178	2	NUT, 1/4-20
128	44112	1	WASHER, 1/4-20
129	44101	1	COTTER PIN
130	23711	1	SPACER
131	44134	1	PLUCK PLATE
132	50865	1	RIB NECK BOLT, 3" .2630 X .125 THK
133	50865	1	WASHER, 7/80 X 3/16 X 1/16
134	44278	1	WASHER, 7/80 X 3/16 X 1/16
135	900510-5600	1	PLUG, STRAIGHT THREAD
157	50977	1	SCREW O-RING
203	70492	2	KIT, SEAL
		1	SEAL-LIP 15X5X37
		1	SEAL-LIP 12X25X7
		1	SEAL-LIP 10X25X7
		1	O-RING .103X1.862
		2	SEAL 23X25X10
		4	SEAL 17X25X10
		2	O-RING .070X.239
		1	KIT, O-RING, MANIFOLD

ITEM #	PART #	QTY	DESCRIPTION
33	5038300-0126	1	SEAL, LIP 1.8 X 25 X 7
34	5038300-0126	1	SEAL, LIP 1.8 X 25 X 7
37	50281	2	PLUCK, FRICTION
38	70680	1	KIT, BYPASS PLATE
39	2003555	1	BYPASS ACTUATOR
40	45074	1	LIP SEAL
41	50270	1	RETAINING RING
42	44870	1	BYPASS ARM
43	50002	2	SPACER
44	50273	1	SCREW
52	9004101-1340	1	GEOROTOR ASSEMBLY
54	50280	1	O-RING
55	50776	4	GEOROTOR COVER
59	50763	4	PIN, CARRIER
60	50646	1	15T PLANET GEAR
61	50646	1	67T SPUR GEAR
62	50646	1	21 TOOTH SUN GEAR
63	50784	1	PLANETARY CARRIER
64	50785	1	51T RING GEAR
65	50647	2	MITER GEAR, DIFF. (SPLINED)
66	50648	2	MITER GEAR, DIFF. (SPLINED)
67	50766	1	SHAFT, DIFFERENTIAL
68	50767	1	DIFF. THRUST PLATE
69	50768	2	FLANGE BEARING
70	50768	2	WASHER 1.0 X 2.25 X .04
71	50786	3	WASHER 1.0 X 2.25 X .04
72	50791	2	BEARING, BUT. 6/8 X 1/8
73	50791	2	BEARING, BUT. 6/8 X 1/8
75	50772	2	SEAL 1 X 2.047 X .375
76	50663	2	SHAFT, AXLE
78	44130	3	WASHER
79	50928	3	SEALANT
80	50968	9	TORX HEAD SCREW, 5/16-18
81	50792	2	WASHER
82	50792	2	WASHER
83	50775	1	RETAINING RING (SCE1412)
85	50775	1	RETAINING RING
84	50773	1	LIP SEAL (.875x1.30x0.25)
85	50779	1	BRAKE DISK
96	50866	1	SLEEVE BEARING
93	50277	1	SPRING, FRICTION PACK
94	50278	1	SPACER, FRICTION PACK
95	50108	2	HEX LOCK NUT 5/16-24
97	122cc	122cc	20W-50 OIL
106	50850	1	SPACER, TRUNNION
109	70110	1	FITTING-O RING ASSEMBLY
111	70109	1	CAP-VENT ASSEMBLY
116	50859	2	RING, RETAINING
117	9004800-2506	2	SID HOLDS PIN
120	50874	1	RIB NECK BOLT 2"
122	50853	1	BRAKE YOKE
124	50816	1	ARM, BRAKE



P.2 of 2. 703370-P3