

PARTS LIST AND INSTRUCTIONS



Wheel Horse

WHEEL-HORSE PRODUCTS, INC. • SOUTH BEND, IND.

LAWN VACUUM ATTACHMENT Model 7-2611 with Optional HOSE ACCESSORY Model 7-2621



SAFETY INSTRUCTIONS

- Exercise caution at all times when operating your new vacuum attachment.
- Always stop engine before leaving machine.
- Always stop engine before servicing or adjusting machine.
- Always keep hands, feet and clothing away from any power driven parts.
- **Never** remove foreign objects from mower deck nozzle, hose, or impeller before stopping engine.
- **Never** operate unit with hose from impeller to canopy disconnected.

DESCRIPTION

The Lawn Vacuum attachment is packed complete in one (1) carton. It is designed specifically for installation on 42" mowers only — models 5-1001, 5-1423, 5-1422, 5-1421; and a model 7-2211 Dump Trailer. An **optional** Hose Accessory model 7-2621 is available for use around shrubbery and other inaccessible areas.

INSTALLATION

IMPELLER UNIT

1. Assemble the Rear (Dozer Blade) Quick Hitch Assembly to tractor as shown in Figure 1, leaving bolts loose. Assemble Latching Plates to outside of hitch.
2. Relocate the R. H. tractor foot rest in the outer hole locations on footrest bracket, retaining the two (2) $\frac{5}{16}$ -18 bolts for later use. (Figure 5)

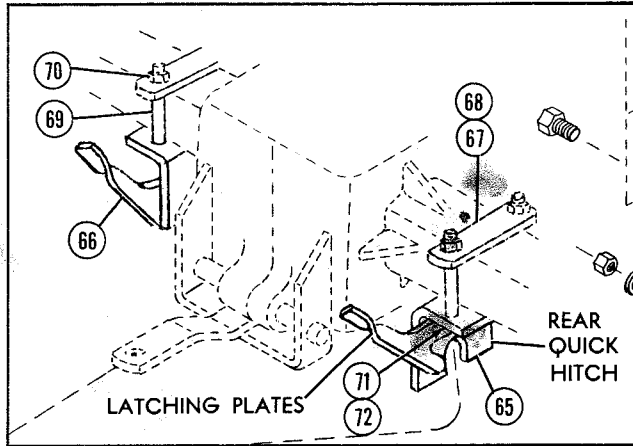

FIGURE 1

3. Mount Idler Pulley in center of slotted hole of Idler Mounting Bracket with $\frac{3}{8}$ -16 bolt, washer, and nut as shown in Figure 2.

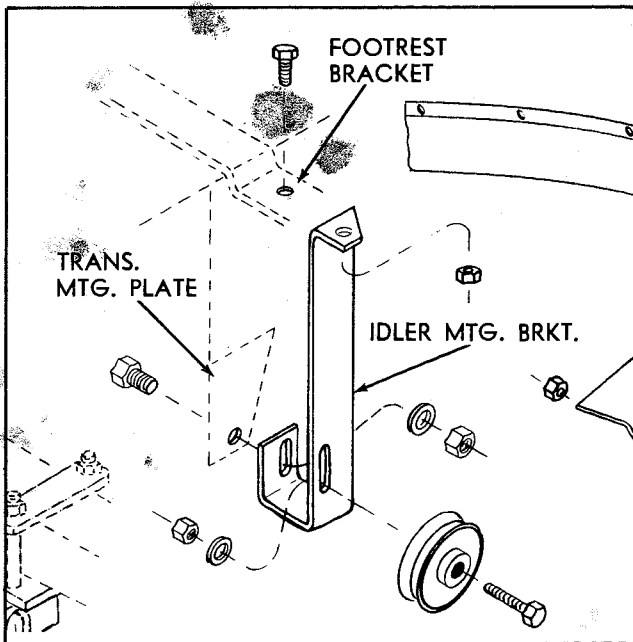

FIGURE 2

4. Secure the Idler Mounting Bracket to Transmission mounting plate with $\frac{1}{2}$ -13 Bolt, washer, and nut. Fasten at top to the footrest bracket with $\frac{5}{16}$ -18 bolt, and nut as shown in Figure 2.
5. Mount the Impeller Unit on Rear Quick Hitch, placing the adjustment screw into Draw Bar and secure with Latching Plates and hairpin cotter as shown in Figures 3 and 4.

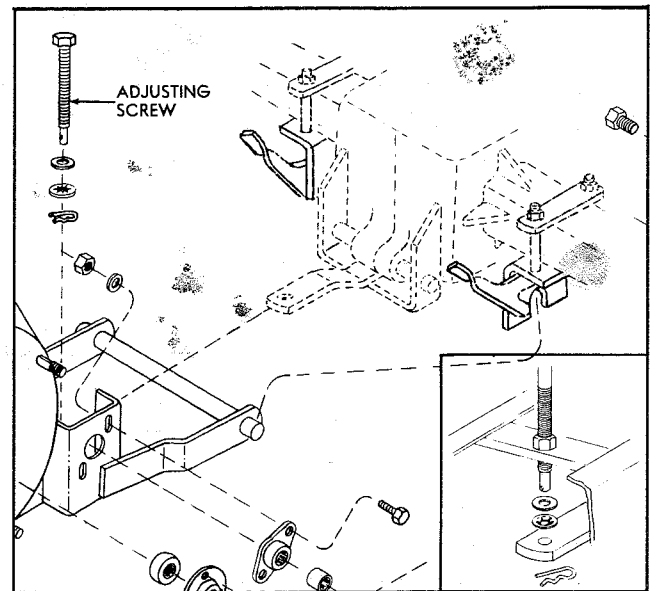

FIGURE 3

FIGURE 4

6. Shift quick hitch ass'y. as necessary to align the Jackshaft Pulley with the outer groove on clutch pulley and tighten Quick Hitch Mtg. Bolts.
7. Slip the Drive Belt under R. H. rear tractor wheel and place on outer groove of clutch pulley, Jackshaft Pulley and under Idler Pulley as shown in Figure 5. (Wheel removed in photo for viewing purposes only.)

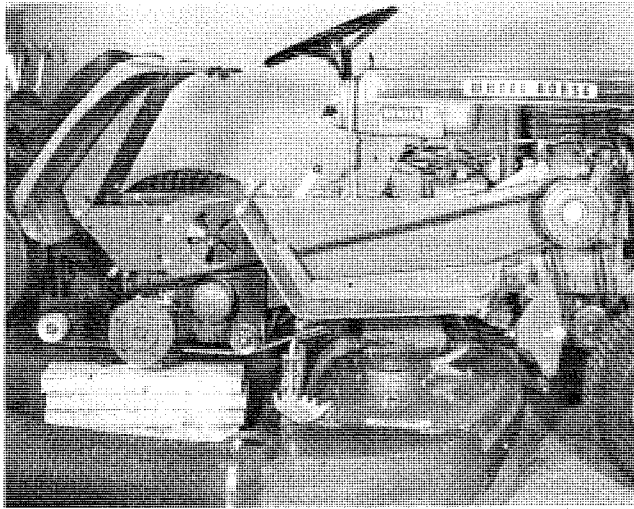

FIGURE 5

8. Adjust the adjustment screw for proper belt tension. (Approximately 1" deflection in the center on upper strand.) Idler pulley may be moved in slot to provide belt clearance under axle and additional belt adjustment.
9. To install belt cover, hook clip at top to Tractor Belt Guard and fasten on outside of Foot Rest with bolts removed during Step 2 and with nuts supplied.

MOWER PREPARATION

10. Clamp Mower Deck Covers to front edge of mower deck, ends against Roller Bracket with bottom edge 1" below mower deck. Using the deck covers as templates, mark and drill eight (8) $\frac{13}{64}$ Dia. holes for machine screws and fasten with Keps-Nuts. See Figure 6. Install with screw-heads inside mower.

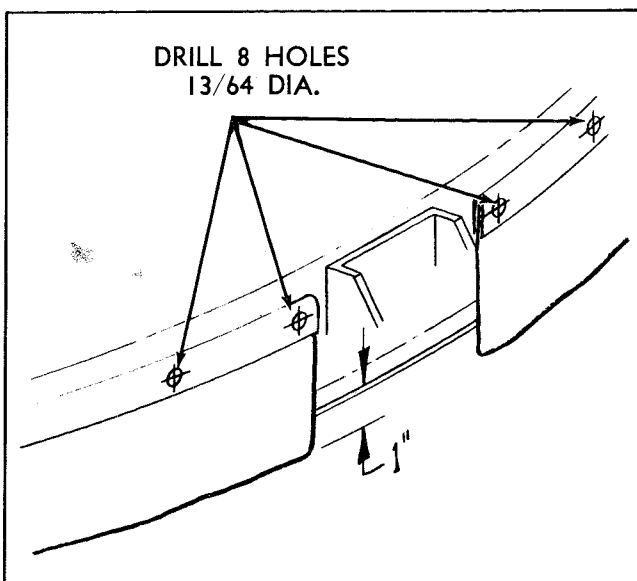

FIGURE 6

11. Place Nozzle on mower deck. Mark location for holes. Drill three (3) $\frac{5}{16}$ Dia. holes and file out to square for $\frac{5}{16}$ -18 Carriage Bolts and secure with nuts. See Figure 7.

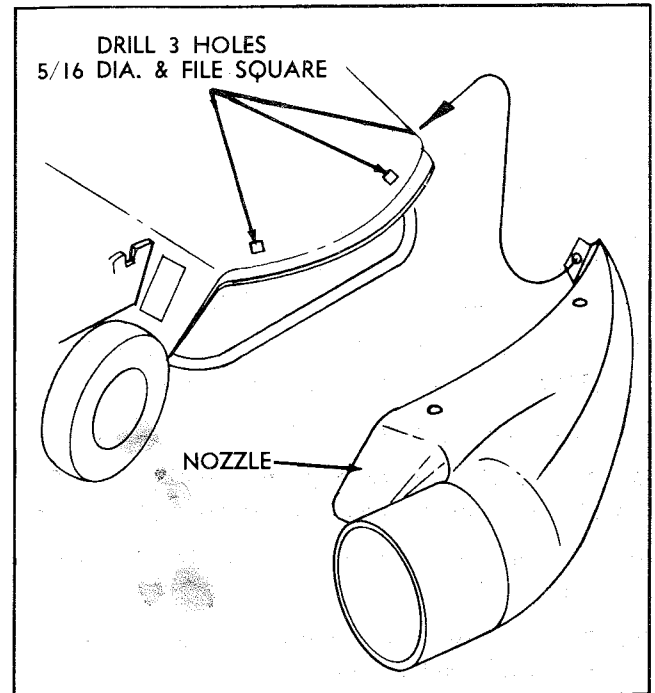

FIGURE 7

TRAILER CANOPY

12. Fasten top Trailer Canopy tubes (52) to hose adapter ass'y. tube (53) using $\frac{5}{16}$ -18 bolt and nut as shown in Figure 8.
13. Assemble the rear of the top canopy support tubes (52) to the outside and the cross tubes (56) to the inside of the top rear U-Tube (55) using $\frac{5}{16}$ -18 Bolt and nut as shown in Figure 9.
14. Insert Upright Braces (54) into Hose Adapter Assembly Tube (53) and Top Rear U-Tube (55).
15. Make loose connection of Front Upright Braces (54), Lower U-Tube (55), and Cross Tubes (56) using eyebolts as shown in Figure 10.
16. Make loose connection of Rear Upright Braces (54) to lower U-Tube (55) as shown in Figure 11.
17. Install canopy over frame.
18. Pull up sides of canopy and install side tubes (57) in loops of canopy as shown in Figure 12.
19. Insert reduced ends of side tubes (57) into bottom U-Tubes (55).
20. Pull up corners of canopy and tighten nuts on Eye Bolts making unit rigid.
21. Place Canopy Frame Assembly on Dump Trailer with side dust seals between trailer bed and frame tubing as shown in Figure 12.
22. Turn up corners of canopy and fasten unit to trailer bed as shown in Figure 10. NOTE: Check to make sure side dust seals are still in proper location.
23. Install Canopy Hooks and fasten to rear tubes as shown in Figure 13.
24. Secure Canopy to Trailer Bed with rope making sure bottom of canopy is below bed lip and plastic canopy corner protectors are in place between canopy and mounting bolts before tying knots.

FINAL ASSEMBLY

25. Fasten 51" Hose between Mower nozzle and Impeller Assembly with hose clamps.
26. Hook Trailer Tongue to rear of Vac Unit with Tool Pin.
27. Fasten 33" Hose to Canopy Adaptor with hose clamp.
28. Insert hose adapter into opposite end of hose and secure with hose clamp.
29. Position Adapter in Clip on Impeller Assembly and secure with wing nut.

OPERATING INSTRUCTIONS

Please read the safety rules in this manual before attempting to operate this equipment.

The Lawn Vacuum is designed to operate efficiently at normal mowing speeds. Consult your mower operating instructions for proper throttle settings and ground speed. **Note:** The attachment clutch engages and disengages both the mower and lawn vacuum simultaneously.

The vacuum will pick up grass clippings, leaves, twigs and other small articles on the lawn and deposit them in the trailer. A deflector is built into the hose adaptor assembly tube to protect the canopy against damage from flying debris. Care should be taken, however, to remove any articles from the lawn which might cause damage to the mower or impeller assembly.

If suction action or pick up should cease while in operation, stop forward travel, disengage attachment clutch, and **shut off engine**. Check for such possible causes as a dirty canopy breathing screen, obstructions in the mower nozzle, hoses or impeller housing, and insufficient belt tension.

The trailer may be easily emptied through the large zippered flap in the rear of the canopy. **Never empty trailer with engine running.** The trailer may be lowered (trailer latch released) for emptying if desired, after first disconnecting the trailer hose from impeller unit.

MAINTENANCE

The Lawn Vacuum is nearly maintenance free. The impeller shaft bearings and idler pulley require no lubrication. Prompt emptying of the trailer and allowing the canopy to dry thoroughly between uses and prior to storage will prolong service life. For winter storage, simply take standard rust preventative measures on metal components.

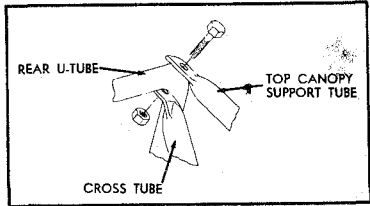

FIGURE 9

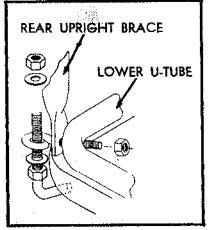

FIGURE 11

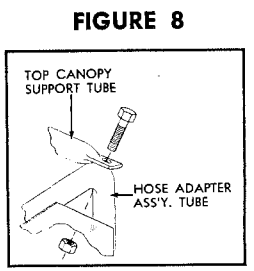

FIGURE 8

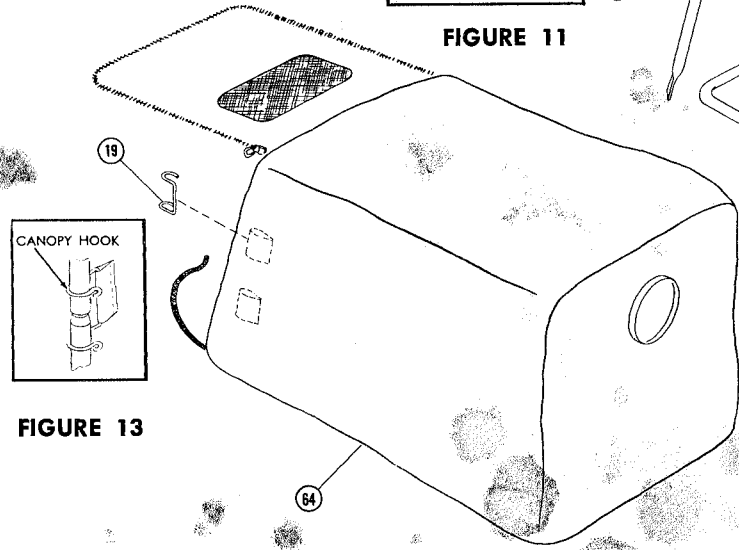

FIGURE 13

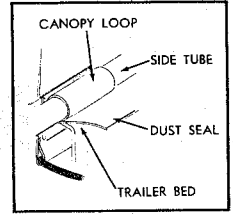
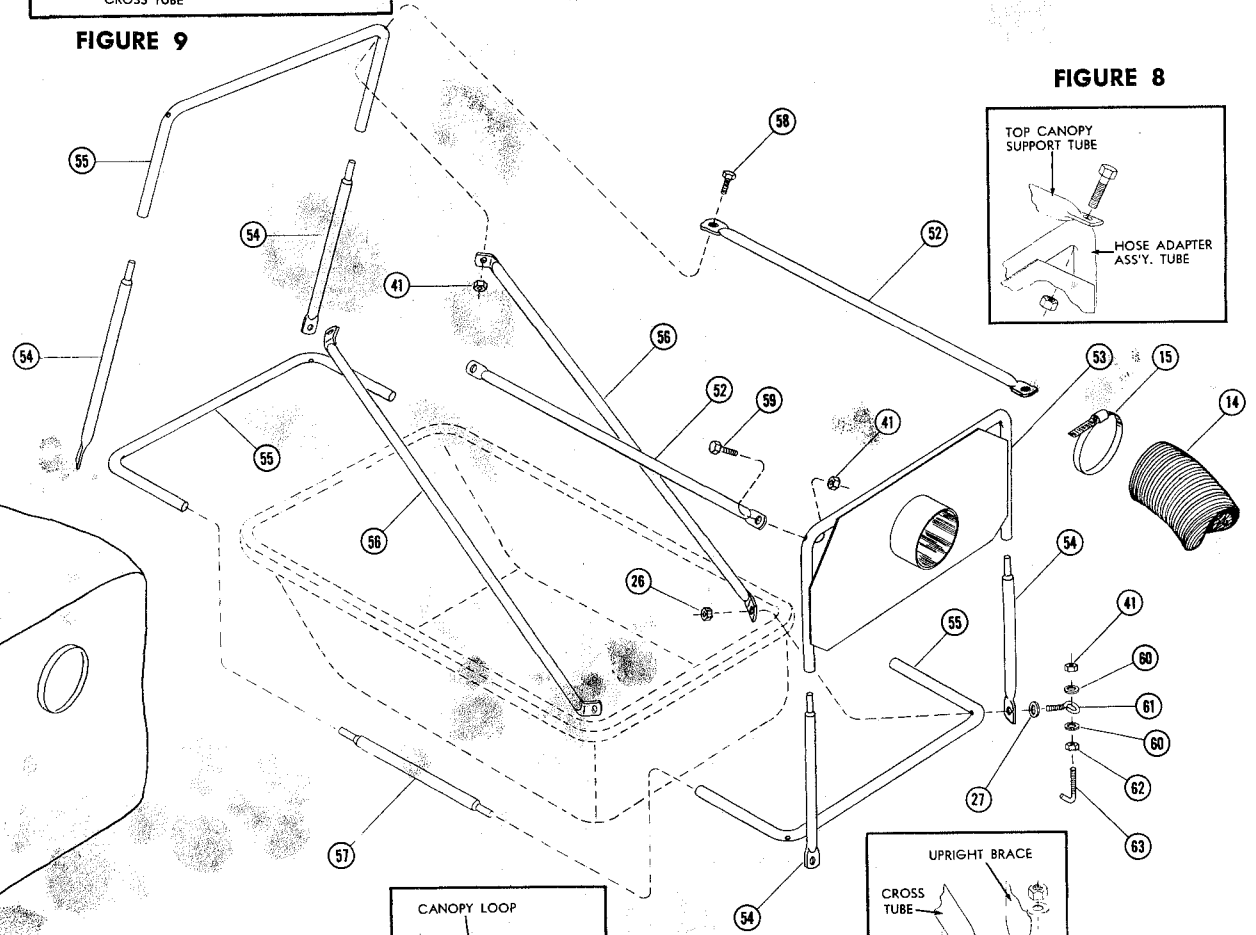

FIGURE 12

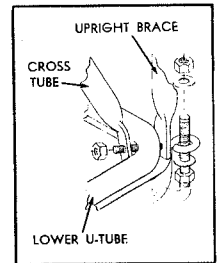

FIGURE 10

VACUUM ATTACHMENTS

When ordering parts always list Part No. and name of Part.

Parts available only through Authorized Dealers.

(Specifications subject to change without notice.)

Item No.	Part No.	Description	No. Req'd.	Item No.	Part No.	Description	No. Req'd.
1	102518	Impeller Housing Ass'y.	1	37	1594	Drive Belt 4L-1070	1
2	102519	Impeller Assembly	1	38	908017-4	$\frac{5}{16}$ -18 x $\frac{3}{4}$ Hex Cap Sc.	1
3	102520	Front Plate Ass'y.	1	39	908057-4	$\frac{1}{2}$ -13 x 1 Hex Cap Sc.	1
4	102521	Jackshaft Spacer	2	40	102544	Idler Mtg. Bracket	1
5	1580	Impeller Drive Belt 4L-310	1	41	915112-6	$\frac{5}{16}$ -18 Lock Nut	16
6	102522	$\frac{3}{4}$ Ret. Ring 5133-75	3	42	920011-4	$\frac{1}{2}$ " Flat Washer	1
7	6366	Square Key $\frac{3}{16}$ x $\frac{7}{8}$	3	43	915115-6	$\frac{1}{2}$ -13 Lock Nut	1
8	102524	Jackshaft Pulley 4L-2 $\frac{3}{4}$	2	44	102545	V-Belt Idler 4L-2 $\frac{3}{8}$	1
9	102525	6" Dia. Hose x 51"	1	45	908036-4	$\frac{3}{8}$ -16 x 1 $\frac{1}{2}$ Hex Cap Sc.	1
10	908032-4	$\frac{3}{8}$ -16 x $\frac{3}{4}$ Hex Cap Sc.	4	46	102546	Mower Deck Cover Ass'y.	2
11	102526	Jackshaft Bearing	2	47	102547	Belt Guard Ass'y.	1
12	920009-4	$\frac{3}{8}$ " S.A.E. Flat Washer	5	48	910792-4	#10-24 x $\frac{1}{2}$ Rd. Head Sc.	8
13	915113-6	$\frac{3}{8}$ -16 Lock Nut	5	49	915964-4	#10-24 Kep-Nut	8
14	102527	6" Dia. Hose x 33"	1	50	102548	Nozzle Ass'y. — 42" Mower Deck	1
15	102528	6" Hose Clamp	4	51	900285-4	$\frac{5}{16}$ -18 x $\frac{5}{8}$ Carr. Bolt	3
16	915585-4	$\frac{5}{16}$ -18 Wing Nut	1	52	102549	Top Tube	2
17	102529	Hose Adapter	1	53	102550	Front Hose Adapter Ass'y.	1
18	102530	Impeller Pulley 4L-4	1	54	102551	Upright Brace	4
19	102531	Hamper Hook	4	55	102552	U-Tube	3
20	102532	Impeller Shaft Spacer	1	56	102553	Cross Tube	2
21	908001-4	$\frac{1}{4}$ -20 x $\frac{1}{2}$ Hex Cap Sc.	8	57	102554	Side Tube	2
22	920081-4	$\frac{1}{4}$ " Split Lock Washer	6	58	908020-4	$\frac{5}{16}$ -18 x 1 $\frac{1}{4}$ Hex Cap Sc.	2
23	102533	Bearing Cup	2	59	908019-4	$\frac{5}{16}$ -18 x 1 Hex Cap Sc.	2
24	102534	Ball Bearing	2	60	920008-4	$\frac{5}{16}$ " S.A.E. Flat Washer	8
25	102535	Belt Cover Assembly	1	61	102555	$\frac{1}{4}$ -20 Eye Bolt	4
26	915111-6	$\frac{1}{4}$ -20 Lock Nut	6	62	915112-6	$\frac{5}{16}$ -18 Hex Nut	4
27	920007-4	$\frac{1}{4}$ " S.A.E. Flat Washer	4	63	102556	J-Bolt	4
28	102536	Bearing Cup w/Nuts	2	64	102559	Cart Cover	1
29	102537	Seal	1	65	7710	Ass'y. Bracket Mounting	1
30	102538	Adjustment Screw	1	66	7204	Plate — Latching	2
31	102539	$\frac{3}{16}$ Flat Washer	1	67	7711	Link	2
32	102540	$\frac{3}{16}$ Push-Nut PS-438014	1	68	7713	Spacer — Angle	2
33	933509-4	Hairpin Cotter	1	69	900073-4	Bolt Carriage $\frac{3}{8}$ -16 x 3 $\frac{1}{2}$	4
34	102542	Impeller Shaft	1	70	915663-4	Nut $\frac{3}{8}$ -16 Elastic Stop	6
35	933215	$\frac{1}{4}$ x 1 $\frac{1}{4}$ Roll Pin	2	71	908034-4	Bolt Hex $\frac{3}{8}$ -16 x 1-	2
36	102543	Jackshaft	1	72	920009-4	Washer $\frac{3}{8}$ S.A.E.	2

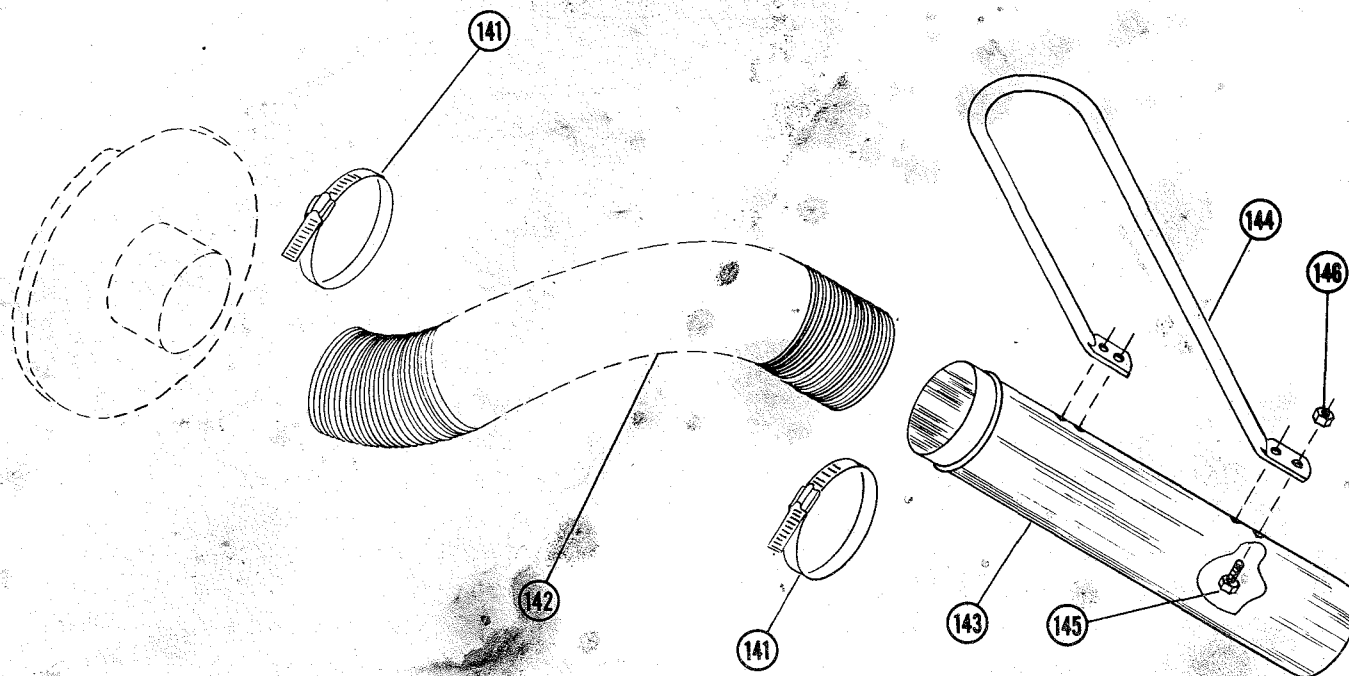

HOSE ACCESSORY

Model #7-2621

Optional Accessory for Model 7-2611 Lawn Vacuum

OPERATION

The Hose Accessory makes the Lawn Vacuum even more versatile by permitting leaf and debris pick-up around shrubs, along hedges and fences and other inaccessible areas. It comes packed in one (1) carton and is easily assembled, using the exploded view drawing below as a guide. To use, remove the hose from the mower and the impeller housing. **CAUTION: Always install mower nozzle plug when mower hose is disconnected.** Install hose accessory on impeller. **Always shut off tractor engine before installing or removing hoses.** Position tractor so that the area beneath the mower is free of debris and that the mower nozzle points **away** from work area. Lower mower to cutting position and set parking brake. Start engine, adjust throttle $\frac{3}{4}$ to full open position and engage attachment clutch.

PARTS LIST

When ordering parts always list Part No. and name of Part.

Parts available only through Authorized Dealers.

(Specifications subject to change without notice.)

Item No.	Part No.	Description	No. Req'd.
141	102528	6" Hose Clamp	2
142	102515	10' Lg. Plastic Hose	1
143	102516	Nozzle	1
144	102517	Nozzle Handle	1
145	908001-4	$\frac{1}{4}$ -20 x $\frac{1}{2}$ Hex Cap Sc.	4
146	915111-6	$\frac{1}{4}$ -20 Lock Nut	4

Wheel Horse Service Bulletins 1961 - 1990: **#142** Issued: March 1973
Model 7-2611 Lawn Vacuum - Drive Belt Clearance

[Previous](#) [Table of Contents](#) [Next](#)

FOR USE WITH 1973 MODEL 5-1010 MOWERS ONLY

ALL DISTRIBUTORS/DEALERS:

1. Problem:

1.1 Drive belt #1594 does not clear #101777 bar-draft.

2. Solution (Field):

2.1 Replace #101777 with part #104030 bar-draft.

2.2 Replace right bracket #102430 with a left bracket #102429.

3. Solution (Factory):

3.1 All shipments after this date from our plant will include bar-draft #104030 and a left bracket #102429 packaged with each Lawn-Vac.

4. Order:

4.1 Order parts in paragraph 2 from your distributor.

5. Reimbursement:

5.1 File a standard warranty claim for both parts and labor directly with us here in South Bend, our standard procedure.

5.2 Operation number 51001-A.

5.3 Labor allowance 1/2 hour-\$3.25.