

PARTS LIST AND INSTRUCTIONS

DOZER BLADE – "A" FRAME

FACTORY ORDER NUMBER 6-4114

FOR USE WITH 42", 54" OR 56" BLADES

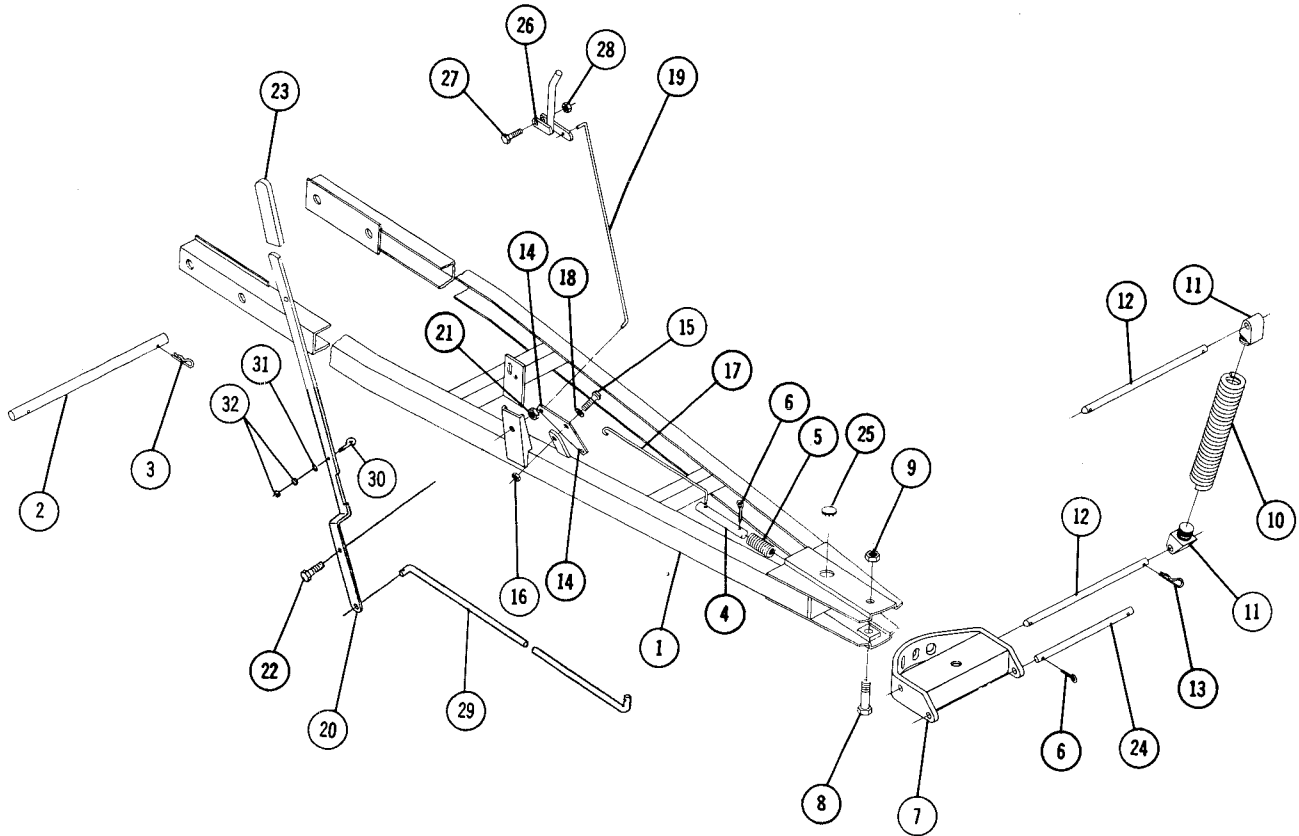

Dozer blade attachments are shipped in two separate cartons: an "A" frame package and blade package. This carton contains the "A" frame illustrated below. In order to install it on a tractor, you must have,

in addition, either the 42", 54" or 56" blade.

Complete assembly and mounting instructions are provided in the Parts list and Instructions packed with the blades.



WHEEL HORSE

lawn & garden tractors

**PARTS LIST — DOZER BLADE "A" FRAME
FACTORY ORDER NUMBER 6-4114**

Parts available only through Authorized Dealers.
When ordering parts always list Part Number and Description.
(Specifications subject to change without notice.)

ITEM NO.	PART NO.	DESCRIPTION	NO. REQ'D.
1	7716	Frame Assembly	1
2	7701	Mounting Shaft	1
3	933506	Hairpin Cotter	2
4	5127	Index Pin	1
5	2354	Spring	1
6	932017	Cotter Pin $\frac{1}{8}$ x 1	3
7	103475	Sector & Channel Assembly	1
8	908256	Bolt Hex $\frac{3}{4}$ -16 x $3\frac{3}{4}$	1
9	915640	Nut Hex $\frac{3}{4}$ -16 Elastic Stop	1
10	5117	Trip Return Spring	2
11	5125	Lug	4
12	5120	Trip Pivot Rod	2
13	933512	Hairpin Cotter	4
14	3770	Index Plate	1
15	908034	Bolt Hex $\frac{3}{8}$ -16 x 1	1
16	915663	Nut $\frac{3}{8}$ -16 Elastic Stop	1
17	3771	Lower Index Rod	1
18	920009	Washer $\frac{3}{8}$ SAE	1
19	104341	Upper Index Rod	1
20	104340	Index Lever	1
21	915238	Nut Hex $\frac{1}{2}$ -13 Jam	1
22	908057	Bolt Hex $\frac{1}{2}$ -13 x 1	1
23	5359	Grip	1
24	4564	Lower Pivot Rod	1
25	4944	Plug Button	2
26	5107	Lever Assembly	1
27	908005	Bolt Hex $\frac{1}{4}$ -20 x 1	1
28	915111	Nut — Nylok $\frac{1}{4}$ -20	1
29	104338	Blade Control Rod	1
30	104218	Eye Bolt	1
31	920079	Lockwasher — #10	1
32	915565	Nut, #10-24 Hex	2

WHEEL HORSE PRODUCTS, INC. 515 West Ireland Road South Bend, Indiana 46614