

01008193
344-2400R

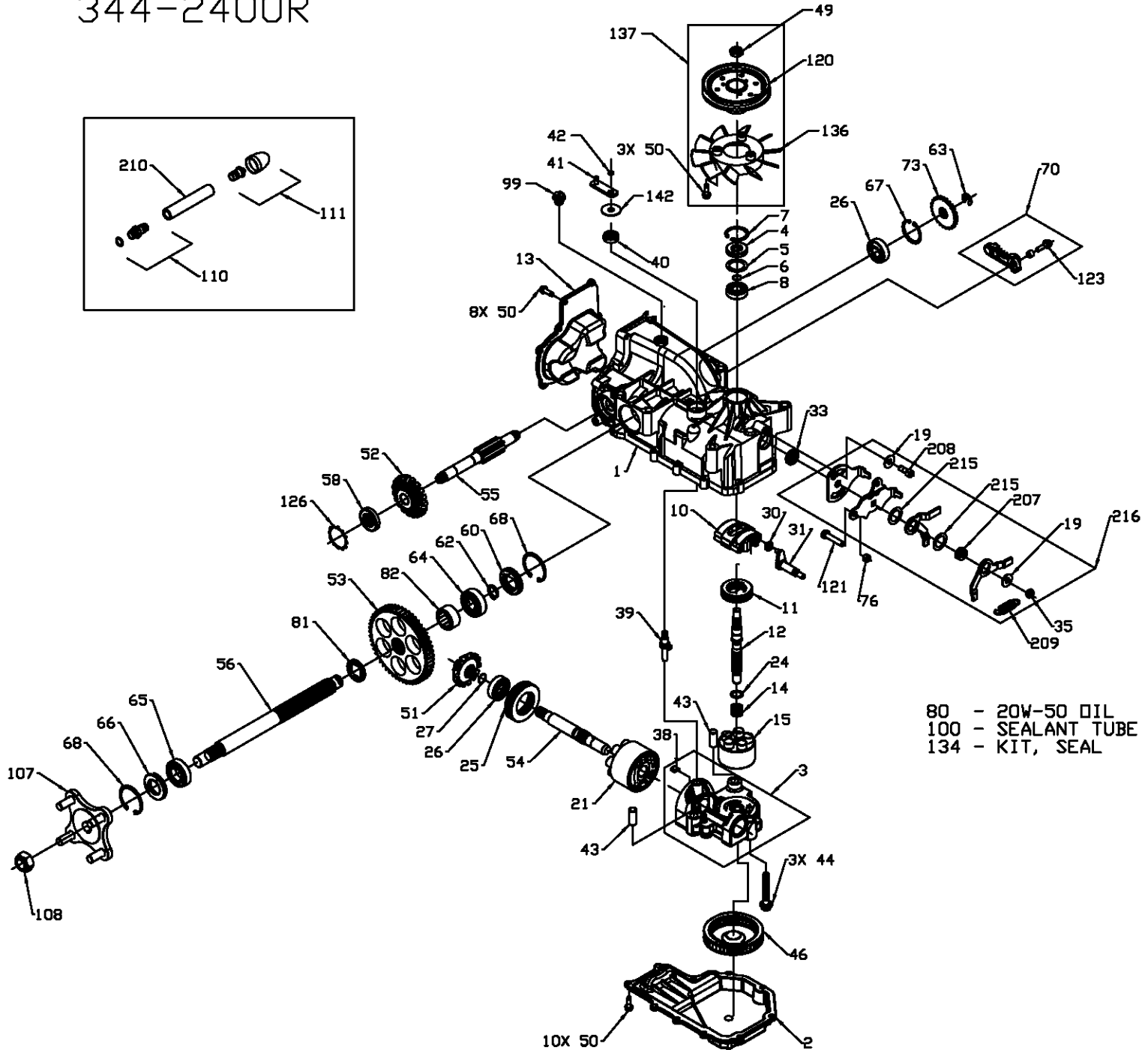

01008193
344-2400R

ITEM #	PART #	QTY	DESCRIPTION	ITEM #	PART #	QTY	DESCRIPTION	ITEM #	PART #	QTY	DESCRIPTION
1	70627	1	KIT, HOUSING-MAIN	43	50002	2	PIN, HOLLOW .39 X .5 X 1	126	51316	2	RING, RETAINING
		1	HOUSING, MAIN	44	50016	3	BOLT, HEX FLANGE 3/8-24 X 2.5	134	70553	1	KIT, SEAL
		2	CRADLE BEARING	46	50990	1	FILTER			1	SEAL, LIP 15 X 35 X 7
		1	TRUNNION BUSHING	49	51244	1	HEX LOCK NUT 1/2-20 (NYLON INSERT)			1	RING, RETAINING 37 INT
		1	SEAL, LIP 12 X 25 X 7	50	50752	21	SCREW, 1/4-20 X .75			1	SEAL, LIP 12 X 25 X 7
2	5089ORM	1	SCREW, HFHC 1/4-28 X 7/8 (PATCH)	51	50744	1	14T BEVEL GEAR			1	SEAL, LIP 10 X 25 X 7
3	70677	1	LOWER HOUSING	52	50745	1	19T BEVEL GEAR			1	RING, RETAINING .31 EXT
		1	KIT, CENTER SECTION	53	50746	1	53T SPUR GEAR			18	HFHCS 1/4-20 X .75
		1	CENTER SECTION	54	50757	1	SHAFT, MOTOR			1	SEAL PLUG
		1	BUSHING .67 X 1.03 X .75	55	51298	1	SHAFT, BRAKE			1	RING, RETAINING .75 EXT
		1	PLATE, BYPASS	56	50748	1	SHAFT, AXLE			1	RING, RETAINING .440 EXT
		3	BOLT, HEX FLANGE 3/8-24 X 2.5	58	51161	2	SEAL, LIP 17 X 40 X 7			1	SEAL, LIP 25 X 47 X 7
		2	CHECK PLUG ASSEMBLY, .027	60	50995	1	SEAL PLUG - SIDE			1	RING, RETAINING 1.56 INT
4	9008000-0128	1	SEAL, LIP 15 X 35 X 7	62	50759	1	RING, RETAINING - AXLE	136	51365	1	FAN, 6", 10 BLADE
5	2003018	1	SPACER	63	51109	1	RING, RETAINING	137	70591	1	KIT, FAN-PULLEY
6	2003016	1	RING, WIRE RETAINING	64	50743	1	BEARING-BALL 20X47X14(6204)			3	SCREW, 1/4-20 X .75
7	2003052	1	RING, RETAINING	65	50740	1	BEARING-BALL 25X47X12(6005)			1	FAN, 6", 10 BLADE
8	2003043	1	BALL BEARING	66	50751	1	SEAL, LIP 25 X 47 X 7			1	HEX LOCK NUT 1/2-20 (NYLON INSERT)
10	2003087	1	VARIABLE SWASHPLATE	67	50329	1	RING, RETAINING			1	PULLEY, Ø4.5 X 1.625
11	50551	1	THRUST BEARING 30 X 52 X 13	68	50760	2	RING, RETAINING -AXLE	142	51813	1	WASHER, .39 X 1.27 X .05
12	50005	1	SHAFT, INPUT	70	70391	1	ASSEMBLY, BRAKE ARM SERVICE	207	51396	1	SPACER, RTN
13	50891RM	1	COVER-BACK			1	ARM, BRAKE ZINC	208	51400	1	SHCS 5/16-24 X .75 (PATCH)
14	2003014	1	SPRING, BLOCK			1	CLEVIS PIN	209	51399	1	SPRING, EXTENSION
15	70331	1	10cc CYLINDER BLOCK ASS'Y			1	BUSHING .255 X .394 X .330	210	51401	1	HOSE, .5 X 4
		1	10cc CYLINDER BLOCK			1	SCREW, HFHC 1/4-28 X 7/8 (PATCH)	215	51408	2	WASHER, PLASTIC 1.19 X .7
		5	10cc PISTON SPRING			1	73 50754	216	70609	1	KIT, RTN SCISSOR
		5	PISTON SEAT WASHER			1	76 43083			2	WASHER, .34 X .88 X .06
		5	10cc PISTON			1	80 79oz			1	NUT, HEX LOCK 5/16-24 UNJF
19	44130	2	WASHER, .34 X .88 X .06			1	81 50942-2			1	ARM, RTN
21	70082	1	21cc CYLINDER BLOCK ASS'Y			1	82 50942-1			1	ARM, RTN SCISSOR, INNER
		1	21cc CYLINDER BLOCK			1	99 9005200-5600			1	ARM, RTN SCISSOR, OUTER
		7	21cc PISTON SPRING			1	100 50928			1	ARM, CONTROL
		7	PISTON SEAT WASHER			1	107 70314			1	SPACER, RTN
		7	21cc PISTON			1	108 50863			1	SPRING, EXTENSION
24	2003017	1	WASHER, BLOCK THRUST			1	110 70110			1	SHCS 5/16-24 X .75 (PATCH)
25	50552	1	THRUST BEARING 42 X 68 X 16			1	111 70921			2	WASHER, PLASTIC 1.19 X .7
26	50315	2	BALL BEARING			1	120 50302				
27	2000022	1	RING, WIRE RETAINING			1	121 51753				
30	2000015	1	SLOT GUIDE			1	123 51576				
31	50807	1	TRUNNION ARM			1					
33	9008000-0126	1	SEAL, LIP 12 X 25 X 7			4					
35	50108	1	NUT, HEX LOCK 5/16-24 UNJF			1					
38	70680	1	KIT, BYPASS PLATE			1					
		1	PLATE, BYPASS (BREAD)			1					
		1	PLATE, BYPASS			1					
39	2003555	1	BYPASS ACTUATOR			1					
40	45074	1	SEAL, LIP 10 X 25 X 7			1					
41	50270	1	ARM, BYPASS			1					
42	44870	1	RING, RETAINING			1					

