

328-3000

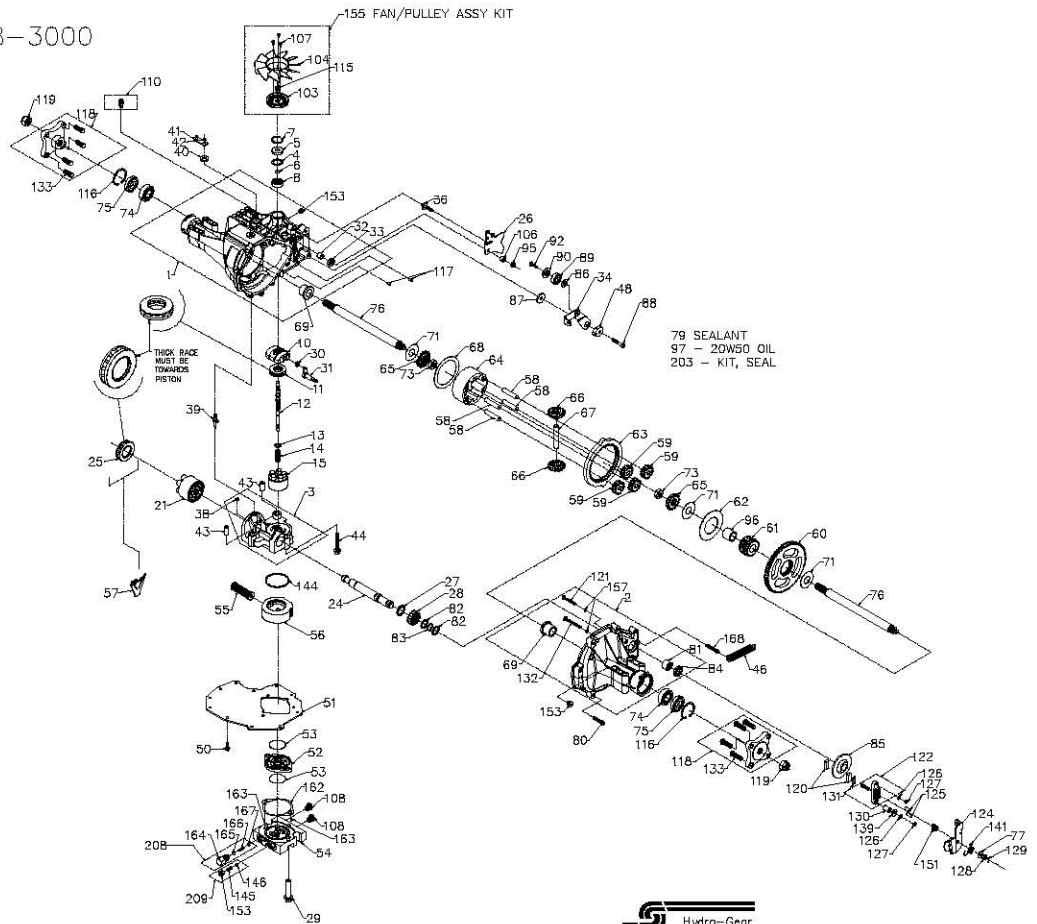

328-3000

ITEM #	PART #	QTY	DESCRIPTION
1	70433	1	HOUSING, MAIN ASSEMBLY
		1	HOUSING, MAIN
		1	SEAL, LIP 12x25x7
		1	BEARING, FLANGE
		1	BUSHING, TRUNNION
2	70298	1	HOUSING, R.H. ASSEMBLY
		1	HOUSING, R.H.
		1	BEARING, FLANGE
		2	O-RING .07X.239
		1	BOLT, 2" RIB NECK
		1	BEARING, NEEDLE .875X1.125X.75
3	70686	1	SEAL, LIP .875X1.3X.25
		1	KIT, CENTER SECTION
		1	CENTER SECTION
		1	BUSHING .50X.60X.50
		1	BUSHING .90X1.02X.75
		1	PLATE, BYPASS
		1	CHECK PLUG ASSEMBLY, NO BLEED
		1	CHECK PLUG ASSEMBLY, .027
		1	SPACER
4	2003018	1	SEAL, LIP 15X35X7
5	9008000-0128	1	RING, WIRE RETAINING
6	2003016	1	RING, RETAINING
7	2003052	1	BEARING, BALL
8	2003043	1	SWASHPLATE, VARIABLE
10	2003087	1	BEARING, THRUST 30X52X13
11	50551	1	SHAFT, INPUT
12	50960	1	WASHER, BLOCK THRUST
13	2003017	1	SPRING, BLOCK
14	2003014	1	BLOCK, 10cc CYLINDER ASSEMBLY
15	70331	1	BLOCK, 10cc CYLINDER
		5	PISTON, 10cc
		5	SPRING, 10cc PISTON
		5	WASHER, PISTON SEAT
21	70082	1	BLOCK, 21cc CYLINDER ASSEMBLY
		1	BLOCK, 21cc CYLINDER
		7	WASHER, PISTON SEAT
		7	PISTON, 21cc
		89	44147
		89	51200
		93	50870
		95	51018
		96	50866
		97	51242
		103	50848
		104	50850
		107	50851
		108	9005200-5600
		110	70110
		115	44133
		116	50859
		117	9004800-2506

ITEM #	PART #	QTY	DESCRIPTION
40	45074	1	SCREW LIP .40X.28X.75
41	50270	1	ARM, BYPASS
42	44870	1	RING, RETAINING
43	50002	2	PIN
44	50016	3	SCREW 3/8-24X2.5
46	51199	1	SPRING, RETURN
48	51097	1	PUCK, ADJUSTING
50	50752	14	COVER, LOWER
51	51302	1	HOUSING, GEROTOR ASSEMBLY
52	51049	1	O-RING .103X2.425
53	9004100-1430	2	KIT, MANIFOLD, AUXILIARY
54	70545	1	MANIFOLD, AUXILIARY
		1	BUSHING .394X.472X.394
		1	MANIFOLD, CHARGE
		1	RETAINER, MOTOR BEARING
		4	PIN, CARRIER
		4	GEAR, 15T PLANET
		60	50646
		61	50645
		82	50789
		63	50764
		64	50765
		65	50647
		66	50648
		67	50786
		68	50767
		69	50768
		71	50788
		73	50791
		74	50771
		75	50772
		76	50825
		77	44130
		79	50928
		80	50866
		81	44782
		82	50777
		83	50775
		84	50773
		85	50779
		86	50132
		87	50836
		88	50837
		89	44147
		89	51200
		93	50870
		95	51018
		96	50866
		97	51242
		103	50848
		104	50850
		107	50851
		108	9005200-5600
		110	70110
		115	44133
		116	50859
		117	9004800-2506

ITEM #	PART #	QTY	DESCRIPTION
118	70314	2	HUB ASSEMBLY
		4	STUD, 1/2-20X1.5
		1	HUB
119	50863	2	NUT, HEX 3/4-16
120	44132	2	PUCK, BRAKE
121	50874	1	BOLT, 2" RIB NECK
122	70633	1	YOKE, BRAKE ASSEMBLY
124	50916	1	ARM, BRAKE
125	44127	2	PIN, BRAKE
126	43177	2	LOCKWASHER, 1/4"
127	43178	2	NUT, 1/4-20
128	44142	1	NUT, CASTLE
129	44101	1	PIN, COTTER
130	23711	1	SPACER
131	44134	1	PLATE, PUCK
132	50865	1	BOLT, 3" RIB NECK BOLT
133	44431	1	STUD, 1/2-20X1.5
139	44278	1	WASHER, .27X.88X.12
141	50884	1	SPRING, BRAKE ARM BIAS
144	50974	1	O-RING .103X2.987
145	51157	1	SPRING, RELIEF
146	9001214-4400	1	BALL, 7/16
151	50919	1	SPRING, COMP. BRAKE ANTI-DRAW
153	9003110-5600	3	PLUG, STRAIGHT THREAD
155	70489	1	KIT, FAN/PULLEY ASSEMBLY
		1	PULLEY
		1	SHAFT, DIFFERENTIAL
		1	PLATE, THRUST DIFF.
		2	BEARING, FLANGE
		3	WASHER 1.0X2.25X.04
		2	NUT, HEX JAM 5/8-18
		2	BEARING, BALL 25.4X52X15
		2	SEAL 1X2.049X.375
		2	SHAFT, AXLE
		1	WASHER .34X.88X.06
		1	WASHER .5X1.0X.03
		1	WASHER .32X2.0X.14
		1	SCREW, 5/16-24X1-1/2
		2	BEARING .625X1.375X.433
		1	SPACER, LOCATING
		1	SCREW, COUNTERSUNK 5/16-18X1
		1	NUT, HEX LOCK 5/16-24
		1	BEARING, SLEEVE 1.0X1.31X1.34
		122	OIL-20W50
		1	FAN
		1	SPACER, TRUNNION
		3	SCREW 12-24X.5
		2	PLUG, PLASTIC
		1	KIT, FITTING
		1	O-RING .08X.468
		1	FITTING, PLASTIC HOSE
		1	NUT, HEX 1/2-20
		2	RING, RETAINING
		2	PIN, STD HDLS
		1	79 SEALANT
		1	97 - 20W50 OIL
		1	203 - KIT, SEAL
157	50977	2	O-RING .070X.239
162	51148	1	SHIM
163	50408	2	PIN
164	50967	1	VALVE BODY
165	9004201-3700	1	O-RING .078X.468
166	50968	1	SPRING
167	9001214-2500	1	1/4" BALL
168	51151	1	SCREW, SHOULDERS TORX HEAD 5/16-18X1.81
203	70492	1	KIT, SEAL
		1	SEAL, LIP 15X35X7
		1	SEAL, LIP 12X25X7
		1	SEAL, LIP 10X25X7
		2	O-RING .103X2.425
		2	SEAL, LIP 1.000X2.049X.375
		1	SEAL, LIP .875X1.375X.250
		2	O-RING .070X.239
		1	KIT, O-RING, MANIFOLD
		1	SHIM, CHARGE PUMP (.002 RED)
208	2510082	1	KIT, VALVE, AUXILIARY RELIEF
		1	VALVE, AUXILIARY RELIEF BODY
		1	O-RING .078X.468
		1	SPRING, AUXILIARY RELIEF
		1	1/4" BALL
209	70544	1	KIT, CHARGE RELIEF
		1	PLUG, STRAIGHT THREAD
		1	SPRING, RELIEF
		1	BALL, 7/16