

015618
320-2400L

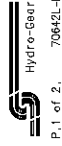
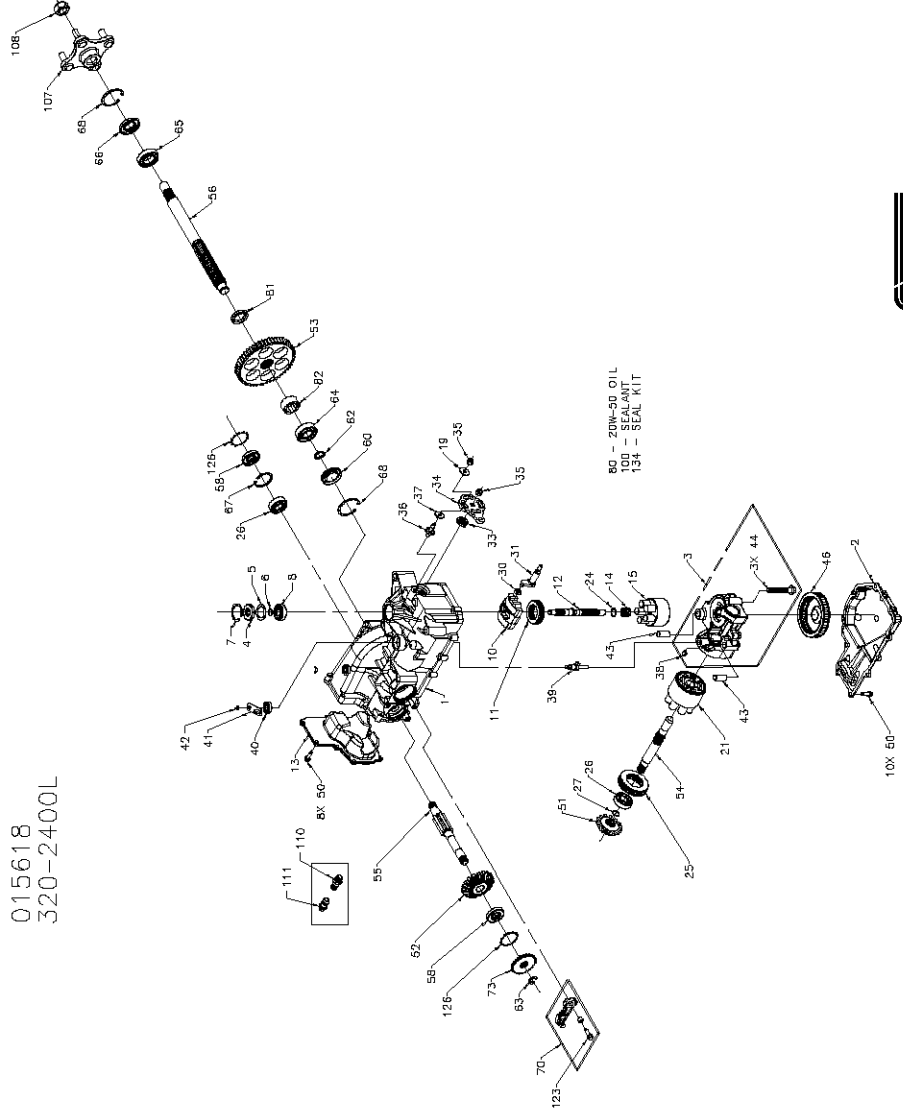

P.1 of 2, 70642L-P2

015618
320-2400L

ITEM NO.	HYDRO-GEAR PART NO.	QTY.	DESCRIPTION
1	70590	1	K.I.T. HOUSING-MAIN
		1	HOUSING, MAIN
		2	CHUCK BEARING
		1	LIP SEAL
		1	TRUNNION BUSHING
3	70679	1	K.I.T. CENTER SECTION
		1	CENTER SECTION
		1	PLATE, BYPASS
4	9006000-0128	3	SCREW 3/8-24 X 2.5
5	2003016	1	CHECK PLUG ASSEMBLY, .044
6	2003016	1	LIP SEAL
7	2003016	1	SPACER
8	2003052	1	WIRE RETAINING RING
9	2003043	1	RETAINING RING
10	5005067	1	BALL BEARING
11	5005067	1	THRUST BEARING
12	500015	1	THRUST BEARING 50 X 52 X 13
13	50801RM	1	INLET SHAFT
14	2003014	1	COVER-BACK
15	70331	1	SPRING, BLOCK
		1	10cc CYLINDER BLOCK ASS'Y
		5	10cc PISTON SPRING
		5	PISTON SEAT WASHER
		5	10cc PISTON
19	44130	1	WASHER
21	70062	1	WASHER
		1	21cc CYLINDER BLOCK ASS'Y
		7	21cc PISTON SPRING
		7	13.5 PISTON SEAT WASHER
		7	10cc PISTON
24	2003017	1	WASHER, BLOCK THRUST
25	50652	1	THRUST BEARING 42 X 68 X 16
26	50315	2	BALL BEARING
27	2000022	1	WIRE RETAINING RING
30	2000015	1	SLOT GUIDE
31	508017	1	TRUNNION ARM
33	9006000-0128	1	LIP SEAL
34	50749	1	CONTROL ARM
35	60317	2	NUT
36	50426	1	STUD - SHORT 5/16-24
37	50281	1	FRICITION PACK
38	70660	1	K.I.T. BYPASS PLATE
39	2003585	1	BYPASS ACTUATOR
40	50749	1	CONTROL ARM
41	50270	1	BYPASS ARM
42	44870	1	RETAINING RING
43	500002	2	PIN
44	50016	3	SCREW

ITEM NO.	HYDRO-GEAR PART NO.	QTY.	DESCRIPTION
46	50990	1	FILTER
50	50752	16	SCREW, 1/4-20 X .75 LDRG
51	50744	1	14T BEVEL GEAR
52	50745	1	19T BEVEL GEAR
53	50746	1	53T SPUR GEAR
54	50757	1	MOTOR SHAFT
55	51288	1	BRAKE SHAFT
56	50746	1	AXLE SHAFT
58	50746	2	SEAL, LIP 1.75 X .40 X 7
60	50995	1	SEAL, PLUS - SIDE
63	51109	1	RETAINING RING KIT
64	50743	1	BEARING-BALL 20X47X14(6204)
65	50740	1	BEARING-BALL 25X47X12(6005)
66	50751	1	SEAL
67	50309	1	RETAINING RING
68	50760	2	RETAINING RING-AXLE
70	70381	1	LH BRAKE ARM SERVICE ASSEMBLY
		1	BRAKE ARM
		1	CLEVIS PIN
		1	BUSHING 0.285X0.361X0.330
		1	HEX WASHER HEAD SCREW, 1/4-20 X .778
		1	HEX NUT
73	50784	1	BEARING-BALL 20X40
80	50942-2	1	AXLE BUSHING
81	50942-2	1	AXLE BUSHING
82	50942-1	1	AXLE BUSHING
100	50928	1	SEALANT
107	70314	1	HUB ASSEMBLY
		1	HUB
		4	LUG BOLT
108	50663	1	NUT, HEX 3/4-16
110	70110	1	FITTING O-RING ASSEMBLY
		1	PLASTIC HOSE FITTING
		1	O-RING
111	70109	1	CAP VENT ASSEMBLY
		1	CAP VENT ASSEMBLY
		1	CAP VENT VALVE
123	51076	1	HEX WASHER HEAD SCREW, 1/4-20 X .778
126	51316	2	RING, RETAINING
134	70553	1	KIT SEAL
		1	SEAL, LIP 1.5 X .35 X 7
		1	RING, RETAINING
		1	SEAL, LIP 1.2 X .25 X 7
		1	SEAL, LIP 1.0 X .25 X 7
		1	RING, RETAINING
		2	SEAL, LIP 1.7 X .40 X 7
		1	SEAL, LIP 1.85 X .32
		1	RING, RETAINING
		1	RING, RETAINING .440 EXTERNAL
		1	SEAL, LIP .85 X 1.85 X .275
		2	RING, RETAINING
		2	RING, RETAINING

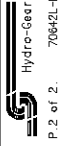

P.2 of 2, 70642L-P2