

033629  
319-3000

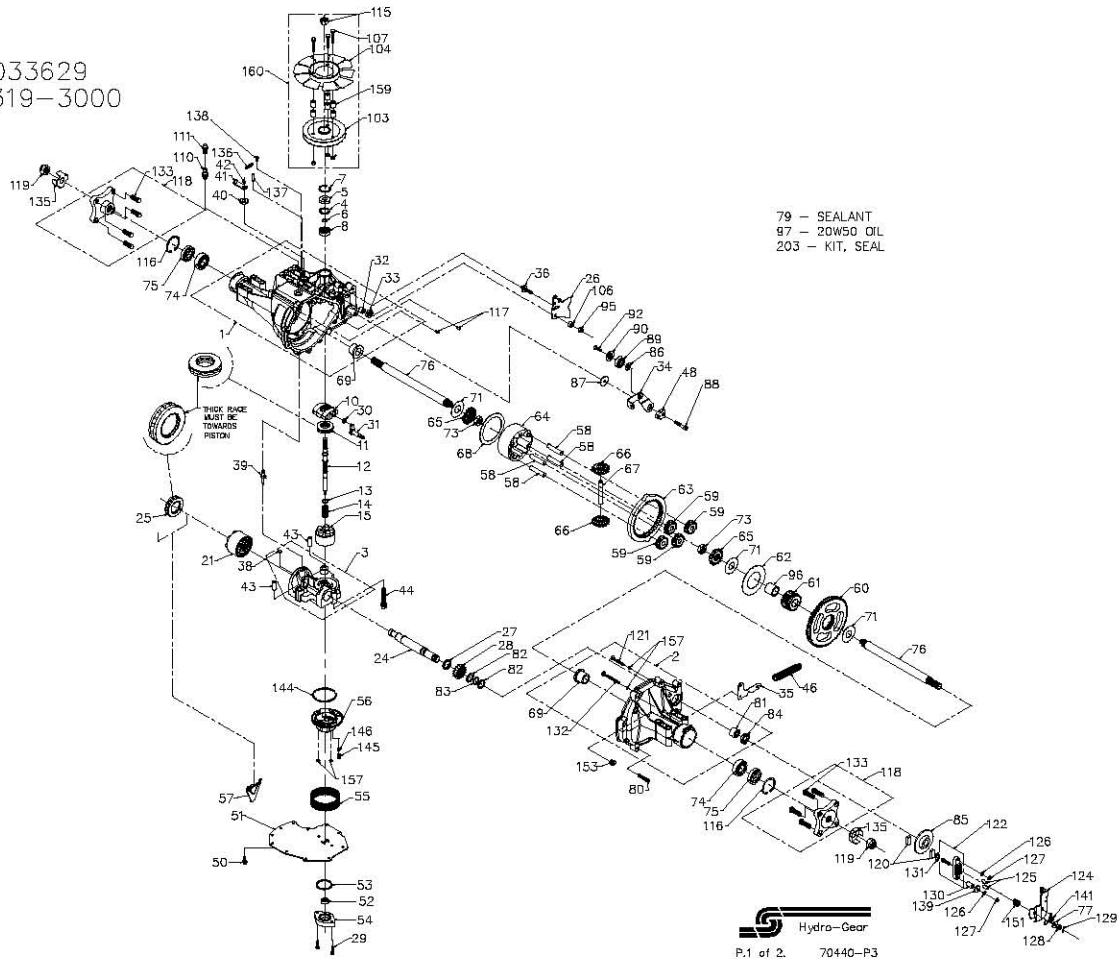

033629  
319-3000

ITEM #	PART #	QTY	DESCRIPTION	ITEM #	PART #	QTY	DESCRIPTION	ITEM #	PART #	QTY	DESCRIPTION
1	70287	1	MAIN HOUSING ASSEMBLY	44	50016	3	SCREW	118	70314	2	HUB ASSEMBLY, 1/2-20
		1	MAIN HOUSING	46	51199	1	RETURN SPRING			1	HUB
		2	CRADLE BEARING	48	51097	1	ADJUSTING PUCK	4		4	WHEEL STUD, 1/2-20
		1	LIP SEAL	50	50752	11	SCREW-Self TAPPING	119	50863	2	NUT, HEX 3/4-16
		1	TRUNNION BUSHING	51	50972	1	LOWER COVER	120	44132	2	PUCK, BRAKE
2	70298	1	R.H. HOUSING ASSEMBLY	52	50273	1	GEROTOR ASSEMBLY	121	50874	1	RIB NECK BOLT, 2"
		1	R.H. HOUSING	53	9004101-1340	1	O-RING	122	70633	1	BRAKE YOKE ASSEMBLY
		1	FLANGE BEARING	54	50260	1	GEROTOR COVER	124	50916	1	ARM, BRAKE
		2	O RING	55	70538	1	KIT, FILTER	125	44127	2	PINS, BRAKE
		1	RIB NECK BOLT, 2"	56	51156	1	CHARGE MANIFOLD	126	43177	2	LOCKWASHER, 1/4"
		1	RIB NECK BOLT, 3"	57	50796	1	RETAINER, MOTOR BEARING	127	43178	5	NUT, 1/4-20
		1	NEEDLE BEARING (SCE1412)	58	50776	4	PIN, CARRIER	128	44142	1	NUT, CASTLE
		1	LIP SEAL (.875 I.D. x 1.30 O.D. x .25)	59	50783	4	1ST PLANET GEAR	129	44101	1	COTTER PIN
3	70687	1	CENTER SECTION ASSEMBLY	60	50646	1	67T SPUR GEAR	130	23711	1	SPACER
		1	CENTER SECTION	61	50645	1	21 TOOTH SUN GEAR	131	44134	1	PUCK PLATE
		1	BUSHING .50X.60X.50	62	50769	1	PLANET THRUST PLATE	132	50865	1	RIB NECK BOLT, 3"
		1	BUSHING .90X1.02X.75	63	50764	1	51T RING GEAR	133	44431	8	LUG BOLT 1/2-20
		1	PLATE, BYPASS	64	50765	1	PLANETARY CARRIER	135	51197	2	SPINDLE CUP
		1	CHECK PLUG ASSEMBLY, .044	65	50647	2	MITER GEAR, DIFF. (SPUNED)	136	50384	1	EXTENSION SPRING
		1	CHECK PLUG ASSEMBLY, .027	66	50848	2	MITER GEAR, DIFF.	137	50882	1	SPRING PIN
4	2003018	1	SPACER	68	50766	1	SHAFT, DIFFERENTIAL	138	50653	1	SCREW, STAP 10-32 X .5
5	9008000-0128	1	SEAL-LIP	69	50768	2	DIFF. THRUST PLATE	139	44278	1	WASHER, 7/800 X .265ID X .125 THK
6	2003016	1	WIRE RETAINING RING	70	50767	3	FLANGE BEARING	141	50884	1	SPRING, BRAKE ARM BIAS
7	2003052	1	RETAINING RING	71	50788	2	WASHER 1.0 X 2.25 X .04	144	50974	1	O RING, 2.987 ID 0.103 THK
8	2003043	1	BALL BEARING	73	50791	2	HEX JAM NUT, 5/8-18	145	51157	1	SPRING, RELIEF
10	2003087	1	VARIABLE SWASHPLATE	74	50771	2	BALL BRG 8205-1	146	9001214-4400	1	BALL
11	50551	1	THRUST BEARING 30 X 52 X 13	75	50772	2	SEAL 1" ID X 2.0472" X 0.375"	151	50919	1	COMP. SPRING, BRAKE ANTI-DRAG
12	50785	1	INPUT SHAFT	76	50825	2	SHAFT, AXLE	153	9005110-5600	1	PLUG, STRAIGHT THREAD
13	2003017	1	BLOCK THRUST WASHER	77	44130	1	WASHER	157	50977	4	O-RING, 0.070 X 0.239
14	2003014	1	BLOCK SPRING	79	50928	1	SEALANT	158	50258	6	SPACER
15	70331	1	10cc CYLINDER BLOCK ASSEMBLY	80	50888	9	TORX HEAD SCREW, 5/16-18	160	70488	1	FAN/PULLEY ASS'Y KIT
		1	10cc CYLINDER BLOCK	81	44752	1	NEEDLE BEARING (SCE1412)			1	FAN
		5	10cc PISTON	82	50777	2	WASHER			3	SCREW 1/4-20 X 2
		5	10cc PISTON SPRING	83	50775	1	RETAINING RING			1	JAM NUT
		1	PISTON SEAT WASHER	84	50773	1	LIP SEAL (.875 I.D. x 1.30 O.D. x .25)			3	NUT, 1/4-20
21	70082	1	21cc CYLINDER BLOCK ASSEMBLY	85	50779	1	WASHER .5 X 1.0 X .03			6	SPACER
		1	21cc CYLINDER BLOCK	86	50132	1	WASHER			1	KIT, SEAL
		7	PISTON SEAT WASHER	87	50836	1	CAPSCREW, 5/16-24X1.5			1	SEAL-UP
		7	21cc PISTON	88	50837	1	BEARING			1	SEAL-UP
		7	21cc PISTON SPRING	89	44147	1	SPACER, LOCATING			1	SEAL-UP
		1	OUTPUT (MOTOR) SHAFT	90	51200	1	FAN			1	O-RING
24	50862	1	THRUST BEARING 42 X 68 X 16	92	50870	1	COUNTERSUNK SCREW			2	SEAL 1" ID X 2.0472" X .375"
25	50552	1	CONTROL ARM	95	50108	1	HEX LOCK NUT 5/16-24			1	LIP SEAL (.875 I.D. x 1.3 O.D. X.25)
26	51250	1	SPACER	96	50865	1	SLEEVE BEARING			2	O-RING, .070X.239
27	50774	1	SPACER	97		12oz	20W-50 OIL			2	SCREW O-RING
28	50661	1	16T PINION GEAR	103	50302	1	PULLEY			1	KIT, O-RING, MANIFOLD
29	50975	2	CAPSCREW, M6 X 1-25	104	50307	1	FAN				
30	2000015	1	SLOT GUIDE	106	50850	1	SPACER, TRUNNION				
31	50807	1	TRUNNION ARM	107	44300	3	SCREW 1/4-20 X 2				
32	2003009	1	TRUNNION BUSHING	110	70110	1	FITTING-O RING ASS'Y				
33	9008000-0126	1	LIP SEAL			1	PLASTIC HOSE FITTING				
34	51127	1	RETURN ARM			1	O-RING				
35	51183	1	BRACKET, DAMPER	111	70109	1	CAP VENT ASS'Y				
36	50426	1	5/16-24 STUD			1	PLASTIC VENT				
38	70880	1	KIT, BYPASS PLATE			1	CAP-VENT				
39	2003555	1	BYPASS ACTUATOR	115	44133	1	JAM NUT				
40	45074	1	LIP SEAL	116	50859	2	RETAINING RING				
41	50270	1	BYPASS ARM	117	9004800-2506	2	STD HDLS PIN				
42	44870	1	RETAINING RING								
43	50002	2	PIN								