

176057  
311-3500

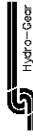
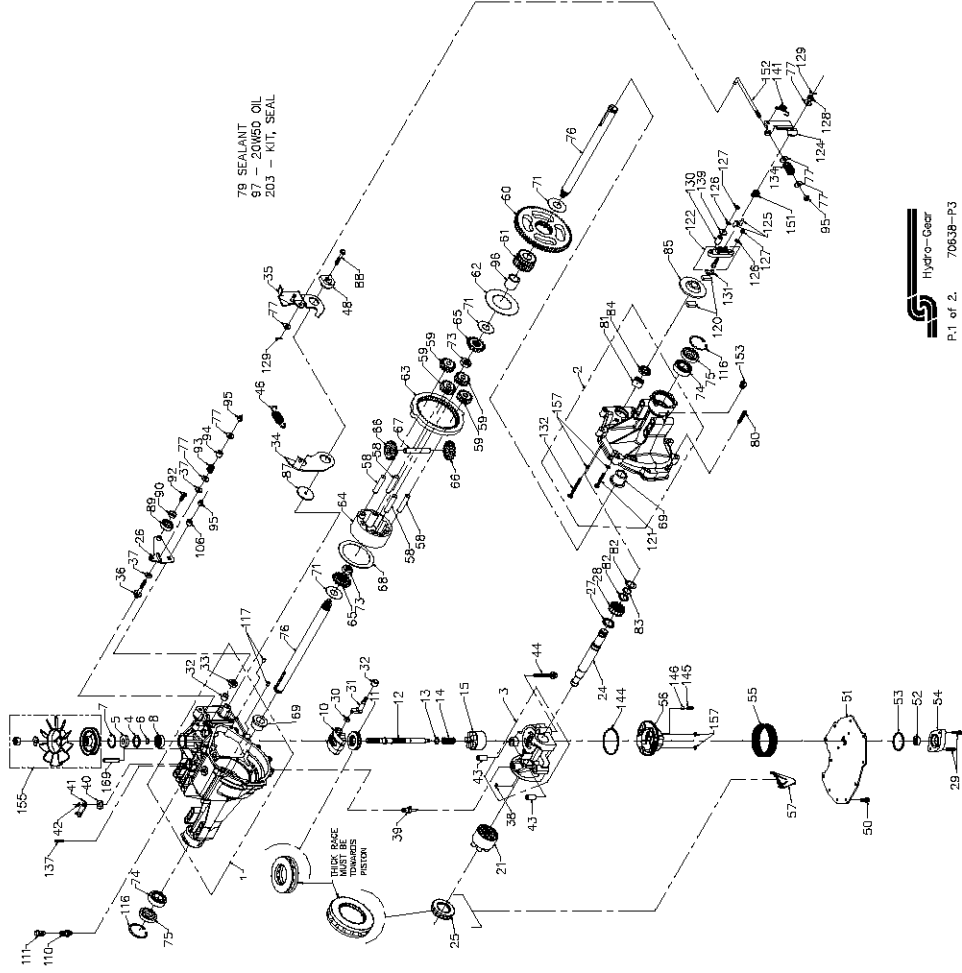

P.1 of 2. 70638-P3

176057  
311-3500

ITEM #	PART #	QTY	DESCRIPTION	ITEM #	PART #	QTY	DESCRIPTION
1	70297	1	MAIN HOUSING ASSEMBLY	110	70110	1	FITTING, O-RING ASSY
2	70300	2	BEARING, BALL, .59 X 1.38 X .43	111	70109	1	FITTING, PLASTIC HOSE
3	70684	1	BEARING, BALL, .59 X 1.38 X .43	116	50859	1	VENT, CAP ASSY
4	20032018	1	FLANGE BEARING	117	8004800-2508	1	VENT, PLASTIC
5	8008000-0128	1	TRUNNION BUSHING	121	40128	1	RING, RETAINING
6	2003052	1	CRADLE BEARING	122	70633	1	PIN, STD. HOLS
7	2003043	1	R.H. HOUSING ASSEMBLY	123	50874	1	BOLT, RIB NECK, 2"
8	2003087	1	R.H. HOUSING	124	50911	1	YOKE, BRAKE ASSEMBLY
9	50795	1	O-RING	125	44127	2	APM, BRAKE
10	2003014	1	O-RING	126	43177	2	LOCKWASHER, 1/4"
11	70331	1	RIB NECK BOLT, 2"	127	44162	2	NUT, 1/4-20
12	2003052	1	RIB NECK BOLT, 3"	128	44162	2	NUT, CASTLE 5/16-24
13	2003087	1	NEEDLE BEARING (SCE1412)	129	44162	2	WASHER, 7/800 X .2850 X .125 THK
14	2003014	1	LIP SEAL (.875 I.D. X 1.30 D. X .25)	130	23711	1	SPRING, BRAKE ARM BIAS
15	70331	1	BUSHING .90X.102X.75	131	44134	1	SPRING, RELIEF
16	2003052	1	BUSHING .90X.102X.75	132	50865	1	BALL, 7/16
17	2003087	1	PLATE, BYPASS	133	50862	1	COMP. SPRING, BRAKE ANTI-DRAW
18	2003087	1	CHECK PLUG ASSEMBLY, .04	134	50915	1	BRAKE PULL ROD
19	2003052	1	LIP SEAL, 15 X .35 X .7	135	44278	1	PLUG, STRAIGHT THREAD
20	2003087	1	RING, RETAINING	136	50864	1	KIT, FAM/PULLEY
21	70682	1	BEARING, BALL, .59 X 1.38 X .43	137	50862	1	WASHER, CO SLOTTED, .53 X 1.63 X .06
22	2003087	1	SWASHPLATE, VARIABLE	138	50862	1	PULLEY
23	2003087	1	BEARING, THRUST 30 X 52 X 13	139	50919	1	O-RING, .070 X .539
24	50862	1	SHATT, INPUT	140	50919	1	PIN, SPRING 5/16 X 1.75
25	2003014	1	SPRING, BLOCK, .591X.787X.040	141	50864	1	KIT, SEAL
26	2003014	1	LIP SEAL, 15 X .35 X .7	142	51157	1	SEAL-LIP 1023X7
27	2003014	1	RING, RETAINING	143	51157	1	SEAL-LIP 1023X7
28	50862	1	BEARING, BALL, .59 X 1.38 X .43	144	5001214-4400	1	LIP SEAL (.875 I.D. X 1.30 D. X .25)
29	50862	1	SWASHPLATE, VARIABLE	145	50919	1	O-RING, .070 X .539
30	2000015	1	SHATT, INPUT	146	50919	1	PIN, SPRING 5/16 X 1.75
31	50862	1	SPRING, BLOCK, .591X.787X.040	147	50919	1	KIT, SEAL
32	2003009	1	LIP SEAL, 15 X .35 X .7	148	50919	1	SEAL-LIP 1023X7
33	8008000-0126	1	RING, RETAINING	149	50919	1	SEAL-LIP 1023X7
34	50862	1	BEARING, THRUST 42 X 88 X 16	150	50919	1	LIP SEAL (.875 I.D. X 1.30 D. X .25)
35	50862	1	SPACER	151	50919	1	O-RING, .070 X .539
36	50284	1	STUD, 5/16-24	152	50919	1	PIN, SPRING 5/16 X 1.75
37	50281	1	PKC, FRICTION	153	9005110-5600	1	PIN, SPRING 5/16 X 1.75
38	70680	1	KIT, BYPASS PLATE	154	9005110-5600	1	PIN, SPRING 5/16 X 1.75
39	2003555	1	ACTUATOR, BYPASS	155	70460	1	PIN, SPRING 5/16 X 1.75
40	45074	1	SEAL, LIP 10 X 25 X 7				
41	50270	1	ARM, BYPASS				
42	44870	1	PIN	156	50977	1	SEAL-LIP 1023X7
43	50002	3	SCREW 3/8-24 X 2.5	157	50977	4	O-RING, .070 X .539
44	50016	1	WASHER, .343 X .680 X .062	159	51463	1	PIN, SPRING 5/16 X 1.75
45	50016	1	WASHER, .343 X .680 X .062	203	70482	1	KIT, SEAL
46	50835	1	PLUG, ADJUSTING				
47	50835	1	PLUG, ADJUSTING				
48	50835	1	SCREW, 1/4-20 X .75				
49	50732	11	COVER, LOWER				
50	50972	1	GEOROTOR ASSEMBLY				
51	50972	1	GEOROTOR ASSEMBLY				
52	56273	1	O-RING				
53	9004101-1340	1	COVER, GEOROTOR				
54	56260	1	WASHER, .343 X .680 X .062				
55	70535	2	WASHER, .343 X .680 X .062				
56	51156	1	MANIFOLD, CHARGE				
57	50796	1	MANIFOLD, CHARGE				
58	50776	4	PIN, CARRIER				
59	50763	4	GEAR, 1ST PLANET				
60	50846	1	GEAR, 6TH SPIUR				
61	50768	1	GEAR, 5TH PLANET				
62	50768	1	GEAR, 5TH PLANET				
63	50764	1	PLATE, PLANETARY				
64	50765	1	CARRIER, PLANETARY				
65	51431	2	GEAR, MITER DIFF. (SPUNED)				
66	51432	2	GEAR, MITER DIFF. (SPUNED)				
67	50766	1	SHAFT, DIFFERENTIAL				
68	50767	1	PLATE, DIFF. THRUST				
69	50768	1	WASHER, 10 X 25 X .04				
70	50768	1	WASHER, 10 X 25 X .04				
71	50791	3	NUT, HEX JAM 5/8-18				
72	50791	2	BEARING, BALL 82005-1				
73	50791	2	BEARING, BALL 82005-1				
74	50771	2	SEAL, 1" O X 2.0472" X .375"				
75	50772	2	SEAL, 1" O X 2.0472" X .375"				
76	50663	2	SHAFT, AXLE				
77	44130	6	WASHER, .343 X .680 X .062				
78	50828	1	SEALANT, TORX HEAD 5/16-18				
79	44964	1	BEARING NEEDLE (SCE1412)				
80	44962	2	WASHER, .885 X 1.250 X .038				
81	50772	1	RING, RETAINING				
82	50775	1	SEAL, LIP .875 I.D. X 1.30 D. X .25				
83	50775	1	SEAL, LIP .875 I.D. X 1.30 D. X .25				
84	50775	1	DISK, BRAKE				
85	50779	1	WASHER, .324 X 1.990 X .146				
86	50837	1	SCREW, 5/16-24 X 1-1/2				
87	50836	1	SCREW, 5/16-24 X 1-1/2				
88	50837	1	SCREW, 5/16-24 X 1-1/2				
89	50837	1	SCREW, 5/16-24 X 1-1/2				
90	50839	1	SPACER, LOCKING				
91	50839	1	SCREW, LOCKING				
92	50870	1	SPRING, COUNTERSUNK 5/16-18				
93	50277	1	SPRING				
94	50278	1	NUT, HEX LOCK 5/16-24				
95	50278	3	NUT, HEX LOCK 5/16-24				
96	50866	1	BEARING, SLEEVE				
97	50866	1	BEARING, SLEEVE				
98	50866	1	BEARING, SLEEVE				
99	50866	1	BEARING, SLEEVE				
100	50850	1	PLUG, PLASTIC				
101	9003200-5600	1	PLUG, PLASTIC				



P.2 of 2. 70638-P3