

# PARTS LIST AND INSTRUCTIONS



## WHEEL HORSE

WHEEL-HORSE PRODUCTS, INC. • SOUTH BEND, IND.

# TURNING BRAKES MODEL 8-1901 FOR 1973 18 H.P. TRACTOR

### PIVOT SHAFT AND PEDALS

Remove the RH foot rest support bracket and in its place bolt on the pedal pivot shaft assembly, item 10 using the same bolts and nuts. See Fig. 1.

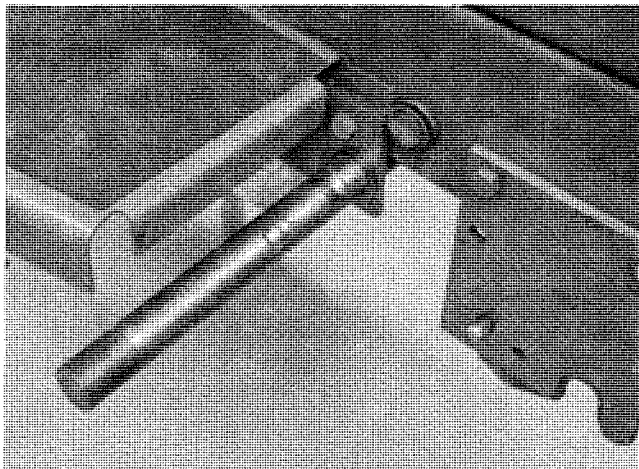

FIGURE 1

The upper arm of the support bracket will have a hole which will match a hole in the frame rail. Bolt this with a  $\frac{3}{8}$  x 1 bolt and  $\frac{3}{8}$  nut.

Remove the paint from the shaft. Fasten the Bar, item 19 to the Foot Pedal, item 13 with hardware shown in Fig. 6.

Install the LH Foot Pedal on the pivot shaft. Follow it with Rod, item 27. Insert it through the pedal in the direction shown in Fig. 6. Install the washer and cotter pin to retain the rod on the pedal.

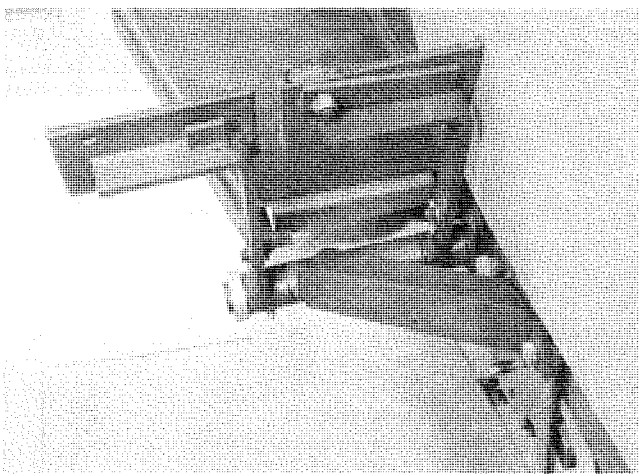

FIGURE 2

Install the brace assembly, item 16, and fasten to the frame with a  $\frac{3}{8}$  x  $1\frac{1}{4}$  Bolt and Nut as shown.

Add the RH foot pedal, item 14 and collar, item 17 to the shaft and tighten. See Fig. 2 and Fig. 6.

### TRANSFER SHAFT

Bolt the support plate assembly, item 39 to the right side of the frame as shown in Fig. 3 and Fig. 6.

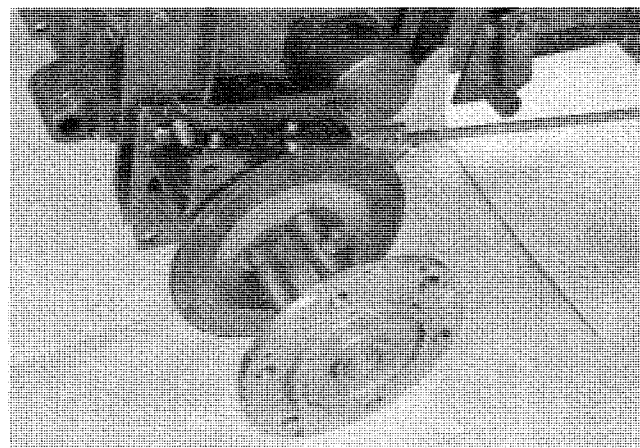

FIGURE 3

Bolt an identical part on the left side as shown in Fig. 4 using the hardware shown in Fig. 6.

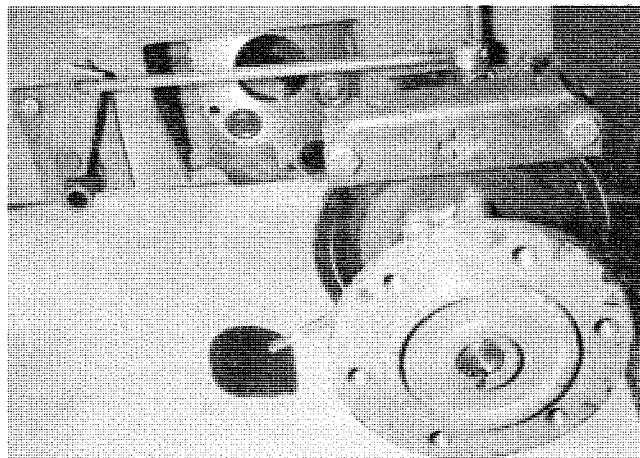

FIGURE 4

Slide shaft, item 30 and 2 bearings, item 31 through the upper holes in the support plates, and install arm, item 32 on each end of shaft. Secure with roll pins, item 33.

## CALIPERS

Remove each wheel hub and bolt the disc, item 35 to each hub. See Fig. 5 and Fig. 6. Reinstall and tighten each hub so they are flush with the ends of the axle. A minor adjustment may be necessary by sliding hub in or out or the brakes will be too tight.

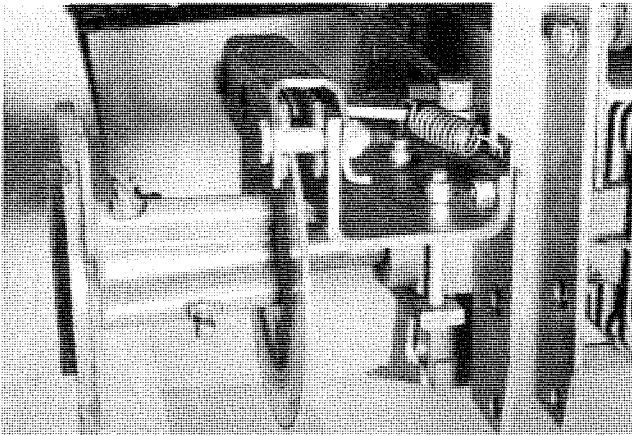

FIGURE 5

Place a spring anchor plate, item 37 between the caliper mounting bracket, item 23 and the tractor hitch mounting angle and fasten with bolt, item 26. See Fig. 5.

Complete the mounting bracket installation by adding link 24 and (2)  $\frac{3}{8}$  x  $3\frac{1}{2}$  bolt and nuts as shown in Fig. 5.

Lower the LH caliper unit over the disc and fasten to the mounting bracket with (2)  $\frac{1}{2}$  x  $2\frac{1}{2}$  bolts. See Fig. 5.

Make the identical installation on the right axle as shown in Fig. 3.

Install rod, item 34 on the left side of tractor as shown in Fig. 6 and Fig. 4. Fasten to arm assembly, item 32 with cotter pin, item 9 and washer, item 8.

Thread a trunnion, item 7 on the rod end. Drop the end of the trunnion through the lever, item 2, and fasten with the same hardware as used on rod 34.

Install rod, item 6, to the right brake pedal and make the identical assembly of hardware and trunnion as on the left side.

## ADJUSTMENT

Thread each rod, items 6 and 34 through their respective trunnions, item 7 until there is approximately 2" of travel at the top of each pedal.

## USAGE

Either the left pedal or the right pedal may be used independently. When either is being used, extreme caution must be used when turning in order that the tractor is not caused to tip over.

Both brakes may be used by turning the bar, item 19 so it engages the right pedal. When using, place foot so pressure is approximately equal on both pedals.

## PARTS LIST FOR TURNING BRAKES

Parts available only through Authorized Dealers.  
When ordering parts always list Part No. and name of Part.  
(Specifications subject to change without notice.)

Item No.	Part No.	Description	No. Req'd.
1	103114	Bracket — Secondary	2
2	103115	Lever — Assembly	2
3	103116	Plate Assembly	4
4	908062	Bolt — Hex. $\frac{1}{2}$ -13 x $2\frac{1}{4}$	4
5	915665-4	Nut — Hex. $\frac{1}{2}$ -13 E. S.	4
6	102230	Rod Assembly	1
7	5791	Trunnion	2
8	920009-4	Washer $\frac{3}{8}$	2
9	932008-4	Cotter Pin	2
10	102234	Pedal Pivot Assembly	1
11	908034-4	Bolt — Hex. $\frac{3}{8}$ -16 x 1	10
12	915663-4	Nut — Hex. $\frac{3}{8}$ -16	3
13	102755	Pedal — L. H.	1
14	102754	Pedal — R. H.	1
15	7073	Fitting — Grease	1
16	103106	Brace Assembly	1
17	8192	Collar	1
18	909849-5	Set Screw $\frac{1}{4}$ -20 x $\frac{5}{16}$	1
19	102259	Bar	1
20	MW-4405	Washer — Spring	1

Item No.	Part No.	Description	No. Req'd.
21	915663-4	Nut — Hex. $\frac{3}{8}$ -16 E. S.	12
22	103097	Pad — Brake Pedal	2
23	102423	Plate — Brake Mounting	2
24	3697	Link	2
25	908043-4	Bolt — Hex. $\frac{3}{8}$ -16 x $3\frac{1}{2}$	4
26	908035-4	Bolt — Hex. $\frac{3}{8}$ -16 x $1\frac{1}{4}$	3
27	102238	Rod Assembly	1
28	920009-4	Washer — $\frac{3}{8}$ SAE	8
29	932008-4	Cotter Pin	4
30	102237	Shaft	1
31	101442	Bearing	2
32	102240	Arm Assembly	2
33	933213	Pin — $\frac{1}{4}$ Dia. x 1	2
34	102244	Rod Assembly	1
35	102229	Disc	2
36	920083-4	Lockwasher $\frac{3}{8}$	8
37	100047	Plate — Spring Anchor	2
38	103125	Spring	2
39	102194	Support Assembly	2

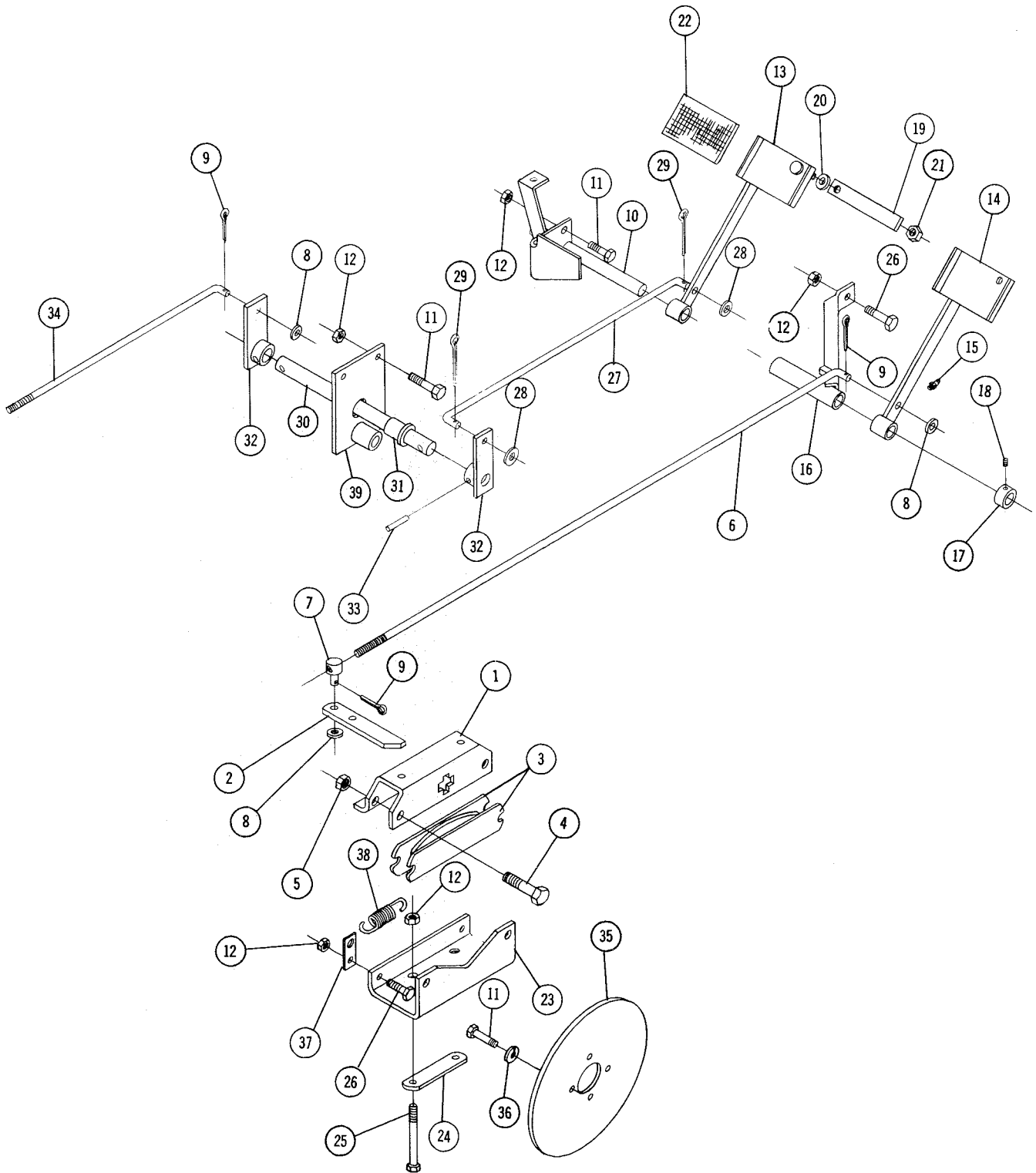
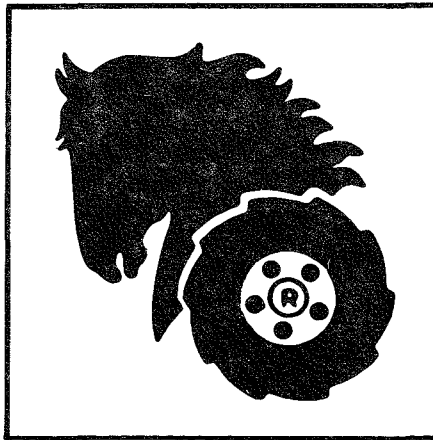

FIGURE 6



**WHEEL-HORSE PRODUCTS, INC.**

**515 West Ireland Road  
South Bend, Indiana 46614**

**WHEEL HORSE SPARE PARTS WARRANTY**

Wheel-Horse Products, Inc. guarantees both its new and its rebuilt spare parts as well as its assemblies against manufacturing defects for 90 days from the date of purchase. Any new or rebuilt spare parts or any assembly manufactured by Wheel Horse will be replaced free if found to be defective while in normal usage during the 90 days following the date of purchase. If the spare part or assembly is warranty replacement, our guarantee applies for the duration of the original warranty period or 90 days, whichever is longer.

Drive belts are also guaranteed for 90 days from date of purchase. Batteries and spare parts for engines are guaranteed separately by their manufacturer. This guarantee covers the replacement of defective parts only. All labor, transportation costs and dealer service charges are the responsibility of the owner. All claims must be handled through an authorized Wheel Horse dealer.

Wheel-Horse Products, Inc. reserves the right to change spare part specifications and/or to delete or substitute spare parts at any time without notice and without incurring obligation.