

"No. 6155"
1-10-61

Wheel-Horse

Reg. U. S. Pat. Off.

MODELS

401, 551, 701



**OPERATOR AND
SERVICE MANUAL WITH
PARTS LIST FOR
WHEEL HORSE TRACTORS**

WHEEL-HORSE PRODUCTS • SOUTH BEND, INDIANA

Things you should know

Your new transmission is powered on needle bearings and roller bearings. The reduction is 108 to 1, and both final drives are steel forgings. All shafts are turned, ground, hardened, and polished for greater strength and best oil sealing.

Speeds are from 1 mph to 6 mph with 3 speeds forward and 1 reverse.

Rear tires are 6:00x12 and the front tires are 4:00x8.

WARRANTY

For Wheel-Horse Tractors and Attachments

WE warrant WHEEL-HORSE PRODUCTS for **ONE YEAR** from date of purchase against defective parts and workmanship. We will replace, free of charge, any defective part if returned to the factory PREPAID. Wheel Horse Products, Inc., reserves the right to make changes or improvements upon its products without imposing any obligations upon itself to install the same upon its products previously manufactured.

The engine and battery carry a separate warranty by the manufacturer. FOR ENGINE OR BATTERY SERVICE, CONTACT YOUR LOCAL ENGINE OR BATTERY SERVICE HEAD-QUARTERS.

NOTE; THIS ONE YEAR WARRANTY POLICY COVERS ALL 1961 WHEEL-HORSE PRODUCTS AND DOES NOT RESCIND THE 90 DAY WARRANTY ON PREVIOUS PRODUCTS.

BEFORE YOU START

Read Engine Manual and follow all instructions pertaining to type of lubrication specified. The engine is the heart of your tractor and it is very important that you keep it in good condition.

Lubricate all grease fittings with a regular pressure gun lubricant every eight to ten hours of operation.

A light machine oil should be used on all moving parts to keep joints from wearing and squeaking.

Remove oil filler plug, located at the left rear side of the transmission, and fill to level of hole with a good grade of S.A.E. 90 Gear Lube (will require about 3 pints).

The transmission should be checked after every 40 hours of use. For best use, transmission should be drained once a year by removing plug on bottom to drain oil. Refill as above paragraph. This is a regular automotive type transmission with sliding gears and should have the same care as your car.

TIRES

On the 401 and 551 Tractor the front tires are filled with liquid anti-freeze ballast to provide additional weight to front end. It is not necessary to check these wheels as the ballast is harmful to tire gauges, and liquid will be lost in checking.

Rear tires should have 6 to 8 pounds of air pressure, and can also be filled with ballast if desired. Ordinarily this is not necessary as operator will add sufficient weight.

STARTING ENGINES

- (A) 401 Engine has a recoil starter with a plain OFF and ON key. To start push key to ON position.
- (B) 551 Engine has a key starter which must be turned all the way to the right to activate solenoid.
- (C) 701 Engine has an ON and OFF key, also a starter button. Turn key to ON position and push starter button.
1. Before starting the engine open valve on sediment Bowl.
 2. Place gear shift lever in neutral position.
 3. Pull throttle lever $\frac{1}{2}$ way out and by turning to the right you can lock it in position.
 4. Pull choke lever all the way out to choke engine. If engine is warm and has been running, choking will not be necessary.
 5. When Engine starts push choke in to off position and regulate throttle control by turning to the left to unlock and push in or out to desired speed.
 6. Depress clutch pedal on left side of tractor before selecting desired gear range.
 7. When starting tractor in winter it is desirable to depress clutch so engine does not have to turn over transmission.

CLUTCHING

There is no need to force gear shift lever if gears do not immediately mesh. Depress clutch pedal all the way down and let up, then depress again and shift again. To avoid jerky starts, release clutch pedal slowly when shifting. While in motion do not shift gears with out depressing clutch pedal.

You will note too that clutch pedal also operates as the brake pedal for stopping by pushing pedal forward all the way.

LIFT LEVER

There is a convenient lift lever on all 3 model tractors, located on the left hand side. All levers have a multi-notched sector for controlling the up and down position of the rear hitch, and in some cases front mounted attachments. The 701 tractor lift lever has two notches; one for up position and one for down position. In some cases this will be used for lifting by pushing lever forward instead of backward.

ATTACHMENTS

All attachments for the 401 and 551 will be the same as 1960. See your attachment instruction sheets.

The 701 attachments will be new in most cases except all drawn implements.

All power implements on 701 will use the clutch which is supplied with your tractor. This is on the right side. Again read your attachments mounting sheet for instructions.

Further information will be with the attachment instructions.

WIRING

See wiring diagram for Part No. and repair.

CARE OF THE TRACTOR

(1) Keep tractor greased and oiled regularly. Check transmission and engine case oil levels.

(2) Keep engine air cleaner clean. This will add to your engine life.

(3) Keep tires properly inflated. See previous instructions.

(4) Keep tractor covered and in a dry place when not in use.

(5) Keep grass and dirt out of engine cowling as this will stop the flow of air and decrease engine life.

(6) Brake adjustment. The brake band, located on the left side of the transmission, brakes the transmission and in turn stops the wheels. Adjust the nut on the brake rod so that, when you depress the clutch pedal all the way down, the band tightens around the brake drum, just as the idler pulley releases the belt. Keep brake band and drum free from oil and dirt.

(7) Clutch Adjustment. With clutch idler engaged, set clutch finger approximately $\frac{1}{8}$ of an inch away from the belt. This should be checked every 10 hours of operation. Be sure clutch finger does not rub the belt when running. This causes excessive belt wear.

(8) Clutch and Brake Pedal Adjustment. The clutch and brake pedal rod, located under the pedal may be turned in or out to adjust the pedal to operators desired posi-

tion. Remove pin from rod under pedal and turn rod in or out for adjustment.

(9) When replacing belts or mounting driven implements make sure all pulleys are in line, by placing a string across the face of all pulleys. String should touch both sides of all pulleys.

(10) On the 551 and 701 Tractors which have batteries, check liquid after every 40 hours of use. If tractor has been in storage it may be necessary to recharge.

(11) Your tractor is only as good as the service you give it. See your Wheel Horse Dealer for a thorough check up after each season of use.

(12) When replacing belts it is advisable to purchase them from your Wheel Horse Dealer, as these belts are double corded for longer life and closer tolerance.

LUBRICATION

- (a) Grease steering column top and bottom. (2 places).
- (b) Grease front wheel bearings. (2 places).
- (c) Grease front axle. (3 places).
- (d) Grease front steering link. (2 places).
- (e) Grease steering gear. (1 place).
- (f) Oil Lift lever.
- (g) Oil foot pedal.
- (h) Oil engine linkage.
- (i) Use a graphite lubricant on choke, throttle control.
- (j) Use a graphite lubricant on lift cable.
- (k) Use a good grade of clean regular gasoline. Do not store in rusty cans.

FOR YOUR COMFORT

There are available at your dealers certain items which you may find will make your job easier.

- (a) Seat Cushions. (For Model # 401)
- (b) Back Rests (Optional)
- (c) Foot rests (For Model #401)
- (d) Tool Box & Fender (For Model #401)
- (e) Umbrella (Optional)
- (f) Tractor Cover. (Optional)
- (g) Tire Chains. (Optional)

FOR YOUR SAFETY

- (a) Keep all guards on at all times.
- (b) Never cowboy your tractor.
- (c) Keep hands and feet from moving parts.
- (d) Remove key when not in use.
- (e) Be careful on high uneven ground.

Wiring for 701

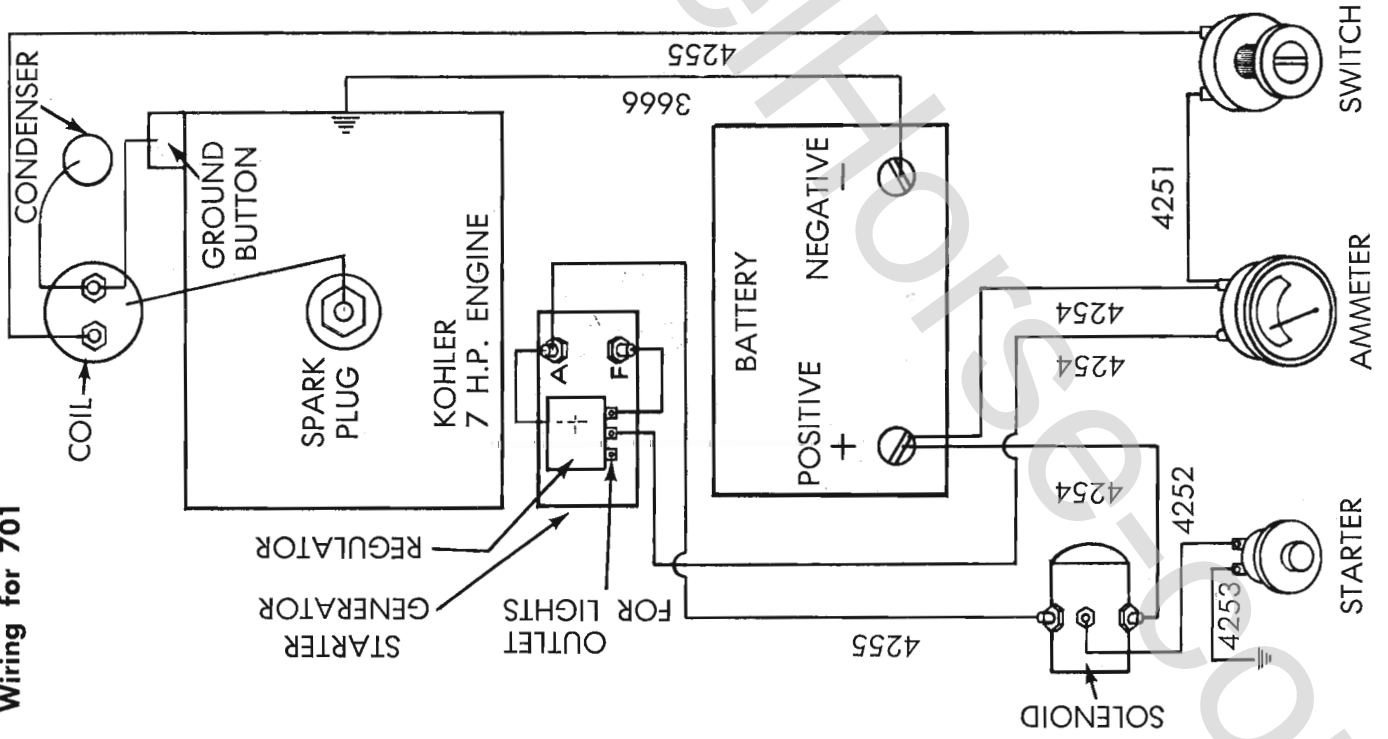

Wiring for 551

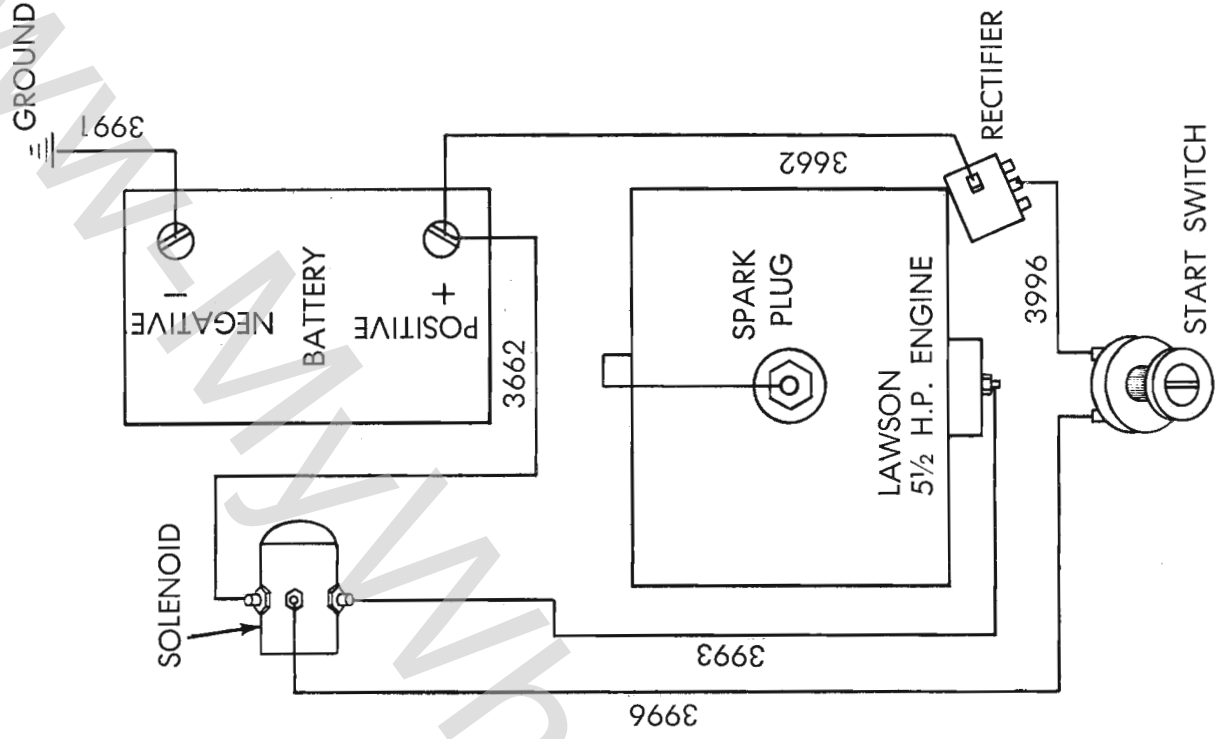

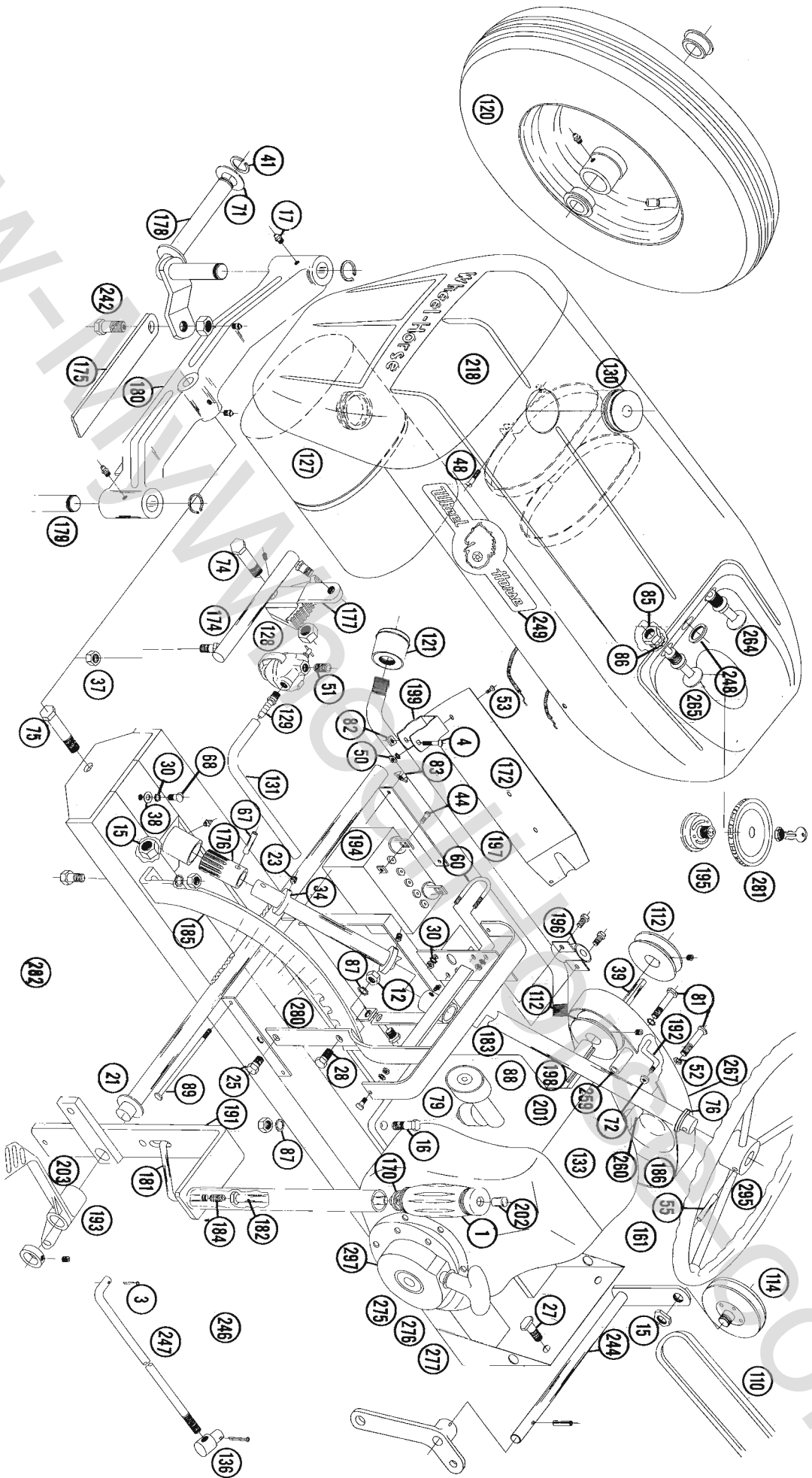

Figure 2—Model 551

www.motom.com

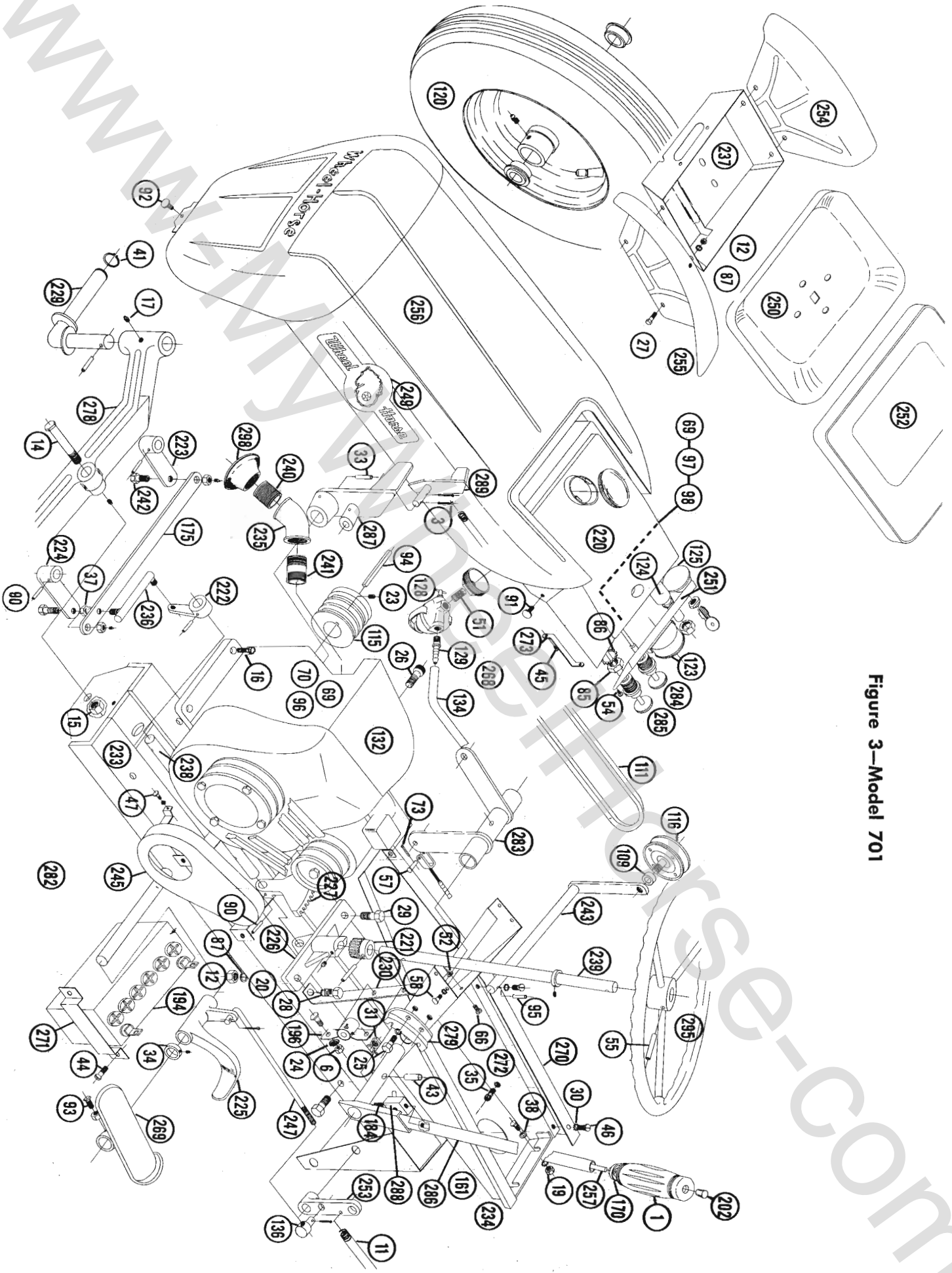

Figure 3—Model 701

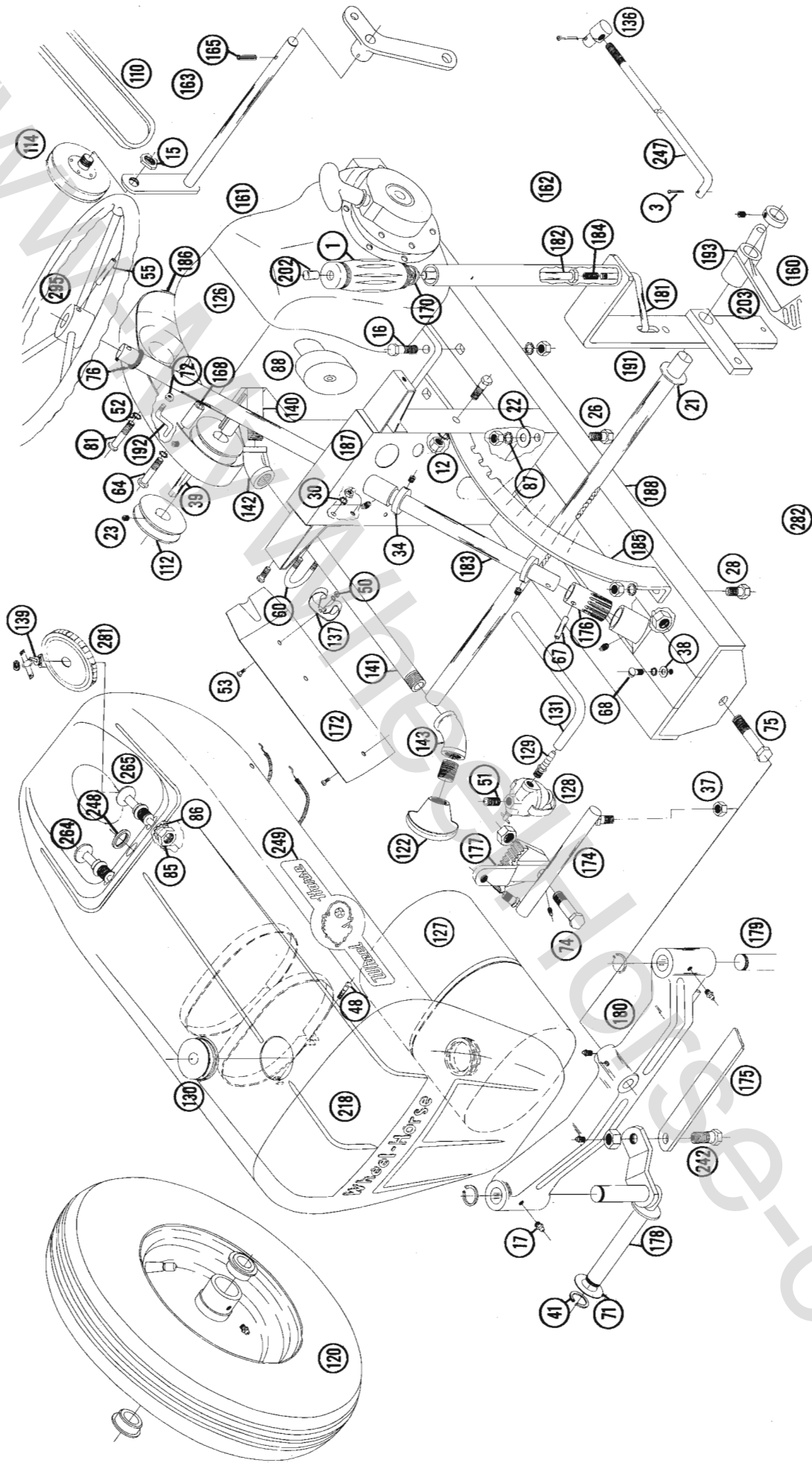

Figure 1—Model 401

PARTS LIST for MODELS 401, 551, 701 and TRANSMISSIONS

When ordering parts always list Part No., name of part, and Tractor Serial No. when available.

When more than one item is used on a tractor only one Reference No. is used.

Ref. No.	Part No.	Description	Fig. No.	No. Req.	Ref. No.	Part No.	Description	Fig. No.	No. Req.
1	1000	Handle Grip	1, 2, 3	1	54	1214	Rd. Hd. Machine Screw 8-32 x 3/8	3	4
2	1001	Shift Knob	1, 2, 3	1	55	1227	Roll Pin 3/16 x 1 3/4 lg.	1, 2, 3	1
3	1002	Cotter Pin 1/8 x 1	1, 2, 3	2	56	1232	Oil Seal 1 x 1 1/4 x 1/8	4	3
4	1003	Stove Bolt / with nut 3/16-24 x 1	2	1	57	1235	Yoke Pin	1, 2, 3, 4	2
5	1004	Wheel Bolt 3/16-20 x 3/4	1, 2, 3	6	58	1237	H.H.C.S. 1/4-20 x 5/8	3	4
6	1007	Hex Nut 3/16-18	3	2	59	1239	Socket Hd. Hd. Set Screw 1/4 x 3/4	4	1
7	1008	Woodruff Key #15	2, 3	3	60	1240	U-Bolt with Nut 1/4	1, 2	1
8	1009	H.H.C.S. 1/4-20 x 1/2	2, 3	2	61	1242	Roll Pin 5/32 x 1 3/16	4	1
9	1013	Pipe Plug 1/4 std. Pipe	4	1	62	1243	Cup Plug	4	1
10	1013A	Pipe Plug 3/8 std. Pipe (vent)	4	1	63	1244	Roll Pin 1/8 x 1	4	2
11	1014	Tension Spring	3, 4	2	64	1249	H.H.C.S. 5/16-24 x 1 3/4	1	1
12	1016	Hex Nut 3/8-16	1, 2, 3, 4	12	65	1252	Sq. Hd. Set Screw 3/8-16 x 7/8	4	2
13	1023	Sq. Hd. Set Screw Cup Pt. 3/8 x 1	4	2	66	1262	Stove Bolt 1/4-20 x 3/4	3	1
14	1025	H.H.C.S. 1/2-13 x 3	3	1	67	1269	Roll Pin 1/4 x 5/16	1, 2	1
15	1026	Jam Nut, Hex 1/2-13	1, 2, 3	1	68	1271	Stove Bolt 1/4-20 x 3/8	1, 2	1
16	1028	H.H.C.S. 3/8-16 x 1 1/4	1, 2, 3	4	69	1273	Rd. Hd. Machine Screw 10-32 x 5/8	3	1
17	1030	Grease Fitting 1/4-28	1, 2, 3	6	70	1277	Wire Clip	3	1
18	1032	H.H.C.S. 3/8-16 x 2" lg.	4	5	71	1278	Washer-Shim 1 1/4 x 3/4 x .050	1, 2, 3	2
19	1034	Hex Nut 1/4-20	2, 3, 4	3	72	1282	Jam Nut 3/16-24 H.H.	1, 2	1
20	1039	Lock Washer 3/8	3, 4	4	73	1285	Cotter Key 1/16 x 5/8	2, 3, 4	2
21	1040	Flat Washer 3/4 SAE	1, 2	1	74	1286	H.H.C.S. 1/2-13 x 1 3/4	1, 2	1
22	1041	Flat Washer 3/8 Wrought	1	2	75	1287	H.H.C.S. 1/2-13 x 2 3/4	1, 2	1
23	1042	Soc. Hd. Set Screw 3/16-18 x 5/16	1, 2, 3	4	76	1288	Grommet—Rubber 3/4 I.D.	1, 2	1
24	1045	Lock Washer 5/16	4	2	77	1303	Oil Seal 3/4 I.D. x 1" O.D. x 1/8	4	1
25	1047	H.H.C.S. 3/8-16 x 1/2	3, 4	2	78	1310	Nylock Nut 3/8-16	4	1
26	1059	Soc. Hd. Cap Screw 3/8-16 x 3/4	4	1	79	1314	90 Degree Fitting Fuel Line	2	1
27	1061	Hex Hd. Cap Screw 3/8-16 x 3/4	1, 2, 3	6	80	1316	Lock Nut 3/16-18	4	4
28	1062	H.H.C.S. 3/8-16 x 1"	1, 2, 3	3	81	1320	Hex H.C.S. 3/16-24 x 2	1, 2	1
29	1064	H.H.C.S. 3/8-16 x 1 1/2	3	3	82	1321	Sq. Nut 1/4	2	3
30	1067	Shakeproof Washer 1/4	1, 2, 3, 4	4	83	1327	Wing Nut 1/4-20	2	2
31	1070	H.H. Half Nut 3/8-16	3	2	84	1329	H.H.C.S. 3/8-18 x 3 1/4	4	4
32	1080	Jam Nut Hex Hd. 3/8-16	4	2	85	1330	Lock Nut Hex Hd. 3/16-18 x 5/16	1, 2, 3	2
33	1081	Roll Pin 1/4 x 1 1/2	3	1	86	1331	Shakeproof Washer 3/16 x I.D.	1, 2, 3	2
34	1085	Set Collar 3/4 I.D.	1, 2, 3	4	87	1332	Shakeproof Washer 3/8 I.D.	1, 2, 3, 4	12
35	1091	H.H.C.S. 5/16-18 x 1 1/2	3	1	88	1333	Shakeproof Washer 3/16 I.D.	1, 2	2
36	1106	Carriage Hd. Bolt and Nut 1/2-13 x 1	4	1	89	1335	Machine Bolt 1/4-20 x 6" lg.	2	2
37	1110	Hex Nut 3/8-24	1, 2, 3	2	90	1340	Roll Pin 1/4 x 1 1/4	3	3
38	1119	Flat Washer 1/4	1, 2, 3	2	91	1345	Thumb Screw 1/4-20 x 1 3/16	3	2
39	1120	Key Sq. 3/16 x 3/16 x 2	1, 2	1	92	1346	Thumb Screw 1/4-20 x 1 3/16	3	1
40	1122	Woodruff Key #9	4	2	93	1348	Sq. Hd. Set Screw 3/16-18 x 1"	3	2
41	1127	Snap Ring 3/4 I.D.	1, 2, 3, 4	4	94	1349	Sq. Key 1/4 x 1/4 x 1 1/2	3	1
42	1128	Snap Ring 1" I.D.	4	2	95	1350	Roll Pin 1/8 x 1 1/4	3	1
43	1136	Roll Pin 3/8 x 1 1/2	3	1	96	1351	Shakeproof Washer 8132	3	1
44	1143	Stove Bolt 1/4-20 x 5/8	2, 3	2	97	1352	Hex Nut 10-32	3	1
45	1150	Sheet Metal Screw No. 7 x 1/2	3	1	98	1353	Shakeproof Washer 10-32	3	1
46	1153	Stove Bolt 1/4-20 x 1/2	3	2	99	1508	Needle Bearing 3/4 x 1 x 3/4	4	2
47	1166	H.H.C.S. 1/4-20 x 3/4	3	1	100	1514	Ball Bearing 3/4 x 1 3/8 x 3/8	4	
48	1179	Stove Bolt 3/16-24 x 1/2	1, 2	2	101	1516	Bronze Bearing 1/2 x 5/8 x 1 1/8	4	1
49	1180	Carriage Hd. Bolt 1/2-13 x 1 1/2	4	1	102	1518	Needle Bearing 5/8 x 1 3/8 x 1/2	4	1
50	1182	Hex Nut 8-32	1	1	103	1528	Needle Bearing 1 x 1 1/4 x 1	4	2
51	1192	Close Nipple 1/8 Std. Pipe	1, 2, 3	1	104	1529	Needle Bearing 3/4 x 1 x 3/4	4	2
52	1196	Lock Washer 5/16	1, 2, 3	2	105	1530	Needle Bearing 1 x 1 1/4 x 3/4	4	1
53	1202	Rd. Hd. Machine Screw 8-32 x 1/4	1	1	106	1531	Needle Bearing 5/8 x 1 3/16 x 3/4	4	1

Ref. No.	Part No.	Description	Fig. No.	No. Req.
107	1537	Needle Bearing 1 x 1¼ x ¾	4	1
108	1533	Ball Bearing ½ x 1½ x 2½	2, 3	2
109	1536	Idler Bushing ¾ x 1½ x ¾	3	1
110	1569	"V" Belt (29") A Section	1, 2	1
111	1576	"V" Belt (70") A Section	3	1
112	1608	Engine Pulley ¾ I.D. x 2½ O.D.	1, 2	2
113	1611	"V" Pulley ¾ x 4" O.D.	4	1
114	1618	Idler Pulley	1, 2	1
115	1621	Engine Pulley 1" I.D. x 2½ O.D.	3	1
116	1623	Idler Pulley	3	1
117	1650	Tire and Tube 6 x 12 Cleat	4	2
118	1659	Tire and Tube 6 x 12 All Purpose	4	2
119	1700	Rear Wheel Rim 12 x 5 JA	4	2
120	1709	Front Wheel Ass'y 4 x 8	1, 2, 3	2
121	1739	Muffler Lawson 5½	2	1
122	1740	Muffler Kohler #7 H.P.	1	1
123	1745	Ammeter	3	1
124	1746	Starter Button	3	1
125	1747	Switch	3	1
126	1779	Kohler Engine K 90 4 H.P.	1	1
127	1785	Gas Tank	1, 2	1
128	1786	Strainer	1, 2, 3	1
129	1787	Straight Fitting Fuel Line	1, 2, 3	1
130	1789	Gas Cap	1, 2	1
131	1790	Fuel Line	1, 2	1
132	1794	Kohler Engine K 161 7 H.P.	3	1
133	1795	Lawson Engine 5½ H.P.	2	1
134	1796	Gas Line	3	1
135	1813	Tool Pin	4	1
136	1861	Rod Control	1, 2, 3	1
137	1883	Clamp	1	1
138	2510	Seat	1, 2, 4	1
139	3279	Switch	1	1
140	3487	Pipe Nipple ¾ Std. Pipe Close.	1	1
141	3488	Exhaust Pipe ¾ x 14½	1	1
142	3489	Elbow ¾-90 Degree Pipe	1	1
143	3490	Elbow ¾-45 Degree Pipe	1	1
144	3503	Shift Fork	4	2
145	3514	Shift Collar	4	1
146	3515	Front Shift Rail	4	1
147	3516	Rear Shift Rail	4	1
148	3517	Ball Stop (¼ Dia. Ball)	4	1
149	3518	Spring Stop	4	1
150	3520	Reverse Idler Gear	4	1
151	3522	Input Drive Gear	4	1
152	3523	Hi and Intermediate Gear (Spline)	4	1
153	3524	Lo and Reverse Gear (Spline)	4	1
154	3525	Cluster Gear	4	1
155	3526	Spline Shaft Gear	4	1
156	3527	Cluster Shaft Reduction Gear	4	1
157	3528	Cluster Shaft Reduction Pinion	4	1
158	3531	Spider Gear (Differential)	4	4
159	3537	Seat Spring	4	1
160	3539	Lift Cable	1	1
161	3541	Decal—Shift Position	1, 2, 3	1
162	3543	Brake Band Ass'y	1	1
163	3560	Hitch	1	1
164	3566	Seat Cushion	1, 2	1
165	3572	Hitch Pin	1	1
166	3573	Shift Pin Stop	4	1
167	3574	Wheel Hubs	4	2
168	3575	Pipe Spacer ¼ x 1¾	1	2
169	3577	Boot (Shift Lever)	4	1
170	3578	Plunger Guide	1, 2, 3	1
171	3583	Lug Cable Clamp	1, 2	1
172	3588	Exhaust Shield	1, 2	1

Ref. No.	Part No.	Description	Fig. No.	No. Req.
173	3590	Frame Spacer	1	1
174	3600	Drag Link	1, 2	1
175	3605	Tie Rod	1, 2, 3	1
176	3606	Steering Pinion	1, 2	1
177	3607	Steering Sector	1, 2	1
178	3622	Front Spindle R.H.	1, 2	1
179	3623	Front Spindle L.H.	1, 2	1
180	3614	Front Axle	1, 2	1
181	3615	Lower Plunger Rod	1, 2	1
182	3617	Upper Plunger Rod	1, 2	1
183	3618	Steering Rod	1, 2	1
184	3624	Spring	1, 2, 3	1
185	3626	Lift Sector	1, 2	1
186	3627	Belt Guard	1, 2	1
187	3628	Hood Stand Ass'y	1	1
188	3633	Frame Ass'y	1	1
189	3634	Brake Rod	1, 4	1
190	3636	Steering Support Plate	1	1
191	3639	Tool Lift Lever	1, 2	1
192	3542	Clutch Finger	1, 2	1
193	3644	Clutch Pedal	1, 2	1
194	3653	Battery (12 Volt)	2, 3	1
195	3656	Switch with Key	2	1
196	3657	Solenoid	2, 3	1
196	3658	Exhaust Pipe (Lawson)	2	1
198	3659	45 Degree Street Elbow ¾ Std. Pipe	2	1
199	3664	Exhaust Clamp (Lawson)	2	1
200	3666	Ground Wire	Wiring Dia.	1
201	3671	Lock Nut (¾ Pipe)	2	1
202	3680	Plunger Cap	1, 2, 3	1
203	3682	Decal (Clutch Pedal)	1, 2	1
204	3900	Transmission Case R.H.	4	1
205	3901	Transmission Case L.H.	4	1
206	3902	Brake Drum	4	1
207	3903	Brake Shaft and Gear	4	1
208	3904	Rear Axle	4	2
209	3905	Differential Case	4	2
210	3906	Bull Gear	4	1
211	3907	Spline Shaft	4	1
212	3908	Differential Axle Gear	4	2
213	3909	Differential Pin	4	4
214	3910	Cluster Shaft	4	1
215	3911	Reverse Idler Pin	4	1
216	3912	Gasket	4	1
217	3913	Brake Band Ass'y	4	1
218	3914	Hood	1, 2	1
219	3915	Locating Pin	4	2
220	3916	Instrument Shroud and Gas Tank	3	1
221	3917	Bevel Pinion (Steering)	3	1
222	3918	Steering Pivot	3	1
223	3919RH	Steering Arm R.H.	3	1
224	3919LH	Steering Arm L.H.	3	1
225	3922	Clutch Pedal	3	1
226	3923	Steering Support—Bottom	3	1
227	3924	Sector—Steering	3	1
228	3926	Tractor Hitch	4	1
229	3928	Front Spindle	3	2
230	3930	Hood Stand Channel Strut	3	2
231	3931	Lift Cable	3	1
232	3935	Brake Rod	2, 3, 4	1
233	3937	Frame Ass'y	3	1
234	3938	Hood Stand Ass'y	3	1
235	3939	45 Degree Elbo 1" Std. Pipe	3	1
236	3940	Drag Link	3	1
237	3943	Tool Box	2, 3	1
238	3944	Shaft—Lower Steering	3	1

Ref. No.	Part No.	Description	Fig. No.	No. Req.
239	3945	Shaft—Upper Steering	3	1
240	3947	Close Nipple 1" Std. Pipe	3	1
241	3948	Nipple 1" x 2" Std. Pipe	3	1
242	3949	Clevis Pin	1, 2, 3	2
243	3950	Idler Arm Ass'y	3	1
244	3954	Idler Arm Ass'y	2	1
245	3955	Engine Belt and Pulley Guard	3	1
246	3957	Lift Cable	2	1
247	3967	Clutch Rod	1, 2, 4	1
248	3968	Hole Plug	1, 2	1
249	3972	Decal—Hood	1, 2, 3	2
250	3973	Seat	3	1
251	3974	Instrument Panel	3	1
252	3978	Seat Cushion	3	1
253	3979	Pivot—Brake	3	1
254	3983	Fender—R.H.	2, 3	1
255	3984	Fender—L.H.	2, 3	1
256	3985	Hood Ass'y	3	1
257	3987	Rod—Upper Plunger	3	1
258	3988	Pin—Hitch	4	1
259	3989	Spacer—Belt Guard	2	1
260	3990	Spacer—Belt Guard	2	1
261	3991	Battery Cable 10"	Wiring Dia.	1
262	3992	Rectifier—Solenoid 22"	Wiring Dia.	1
263	3993	Starter—Solenoid 20½"	Wiring Dia.	1
264	3994	Throttle Control	1, 2	1
265	3995	Choke Control	1, 2	1
266	3996	Rectifier to Battery 12"	Wiring Dia.	1
267	3999	Belt Guard	2	1
268	4200	Foot Rest R.H.	3	1
269	4201	Foot Rest L.H.	3	1
270	4202	Belt Guard	3	1
271	4206	Clamp—Battery	3	1
272	4211	Spacer—Belt Guard ¾ Blk. Pipe	3	1

Ref. No.	Part No.	Description	Fig. No.	No. Req.
273	4212	Brace—Instrument Panel	3	1
274	4215	Shift Stick	4	1
275	4216	90 Degree Elbow	2	1
276	4217	Pipe Cap	2	1
277	4218	Pipe Nipple	2	1
278	4220	Front Axle	3	1
279	4222	Quadrant	3	1
280	4224	Hood Stand Ass'y	2	1
281	4225	Hole Plug	1, 2	1
282	4226	Serial Number Decal	1, 2, 3	1
283	4231	Lift	3	1
284	4232	Throttle Control	3	1
285	4233	Choke Control	3	1
286	4238	Lift Lever Ass'y	3	1
287	4239	Pedal—Clutch (Attach.)	3	1
288	4243	Lower Plunger Ass'y	3	1
289	4246	Trip Lever Ass'y	3	1
290	4251	Wire—Ammeter to Switch	Wiring Dia.	1
291	4252	Wire—Starter to Solenoid	Wiring Dia.	1
292	4253	Wire—Starter to Ground	Wiring Dia.	1
293	4254	Wire Ass'y—Batt. to Solenoid	Wiring Dia.	1
294	4255	Wire Ass'y—Batt. to Ground	Wiring Dia.	1
295	3415	Steering Wheel	1, 2, 3	1
296	1339	H.H.C.S. ¾-16 x 3½	4	1
297	1726	Lawson Recoil Starter	2	1
298	1744	Kohler Muffler	3	1
	5007	1961 Transmission complete		
	5010	1960 Transmission complete		
	3584	Tool Box and Fenders Assembly for 401 and 551		
		A-3587 Tool Box		
		B-3585 Fenders		
	S12-R	Red Touch-up Paint		
	S12-I	Ivory Touch-up Paint		

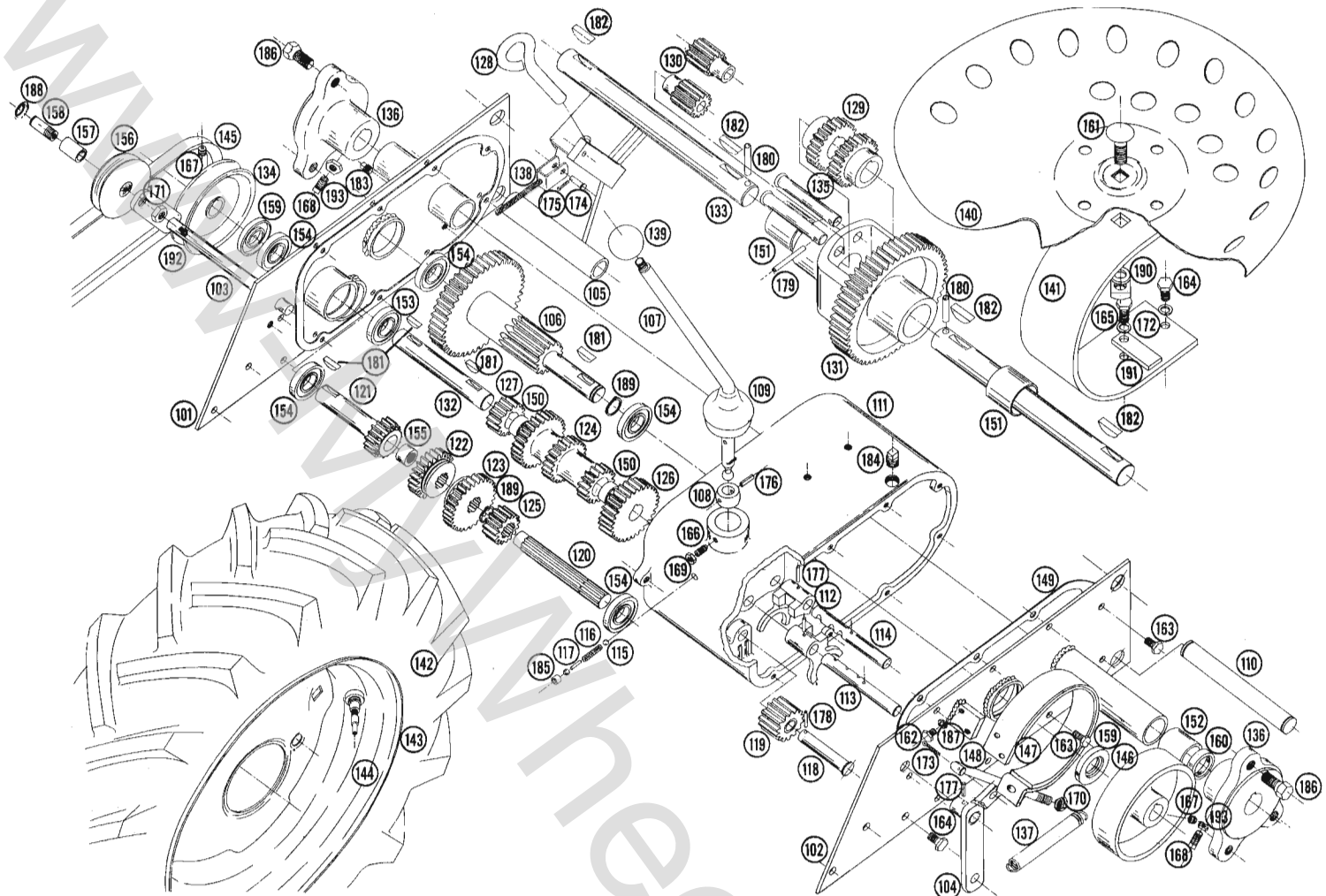

**Figure 5—Transmission No. 5010
Used on Model 401**

Ref. No.	Part No.	Description	No. Per Unit	Ref. No.	Part No.	Description	No. Per Unit	Ref. No.	Part No.	Description	No. Per Unit
101	3504	Right Trans. Cover	1	133	3532	Axle	2	164	1062	Hex Head Cap	7
102	3509	Left Trans. Cover	1	134	1611	Pulley Trans.	1	165	1028	Hex Head Cap	4
103	3638	Idler Arm	1	135	3535	Diff. Pins	4	166	1239	Set Screw Dog Pt.	1
104	3635	Clutch Arm	1	136	3574	Wheel Hub	2	167	1042	Set Screw Sock. Hd.	2
105	3560	Hitch	1	137	1014	Tension Spring	1	168	1252	Set Screw Sq. Head	2
106	3559	Brake Shaft	1	138	3539	Lift Cable	1	169	1034	Hex Nut	1
107	3538	Lever-Shift	1	139	1001	Knob	1	170	1016	Hex Nut	8
108	3514	Collar Shift	1	140	2510	Seat	1	171	1026	Jam Nut	1
109	3577	Boot-Shift Lever	1	141	3537	Seat Spring	1	172	1039	Lockwasher	8
110	3572	Hitch Pin	1	142	1650	T & T Assembly	2	173	1002	Cotter Pin	1
111	3501	Trans. Hsg.	1	143	1654	Tube	2	174	1235	Yoke Pin	1
112	3503	Shift Fork	2	144	1700	Rim	2	175	1285	Cotter Pin	1
113	3515	Shift Rail (frt.)	1	145	1569	Belt	1	176	1242	Roll Pin	1
114	3516	Shift Rail (rear)	1	146	3540	Brake Drum	1	177	1244	Roll Pin	3
115	3517	Ball, Stop	2	147	3543	Brake Band Assy	1	178	1133	Roll Pin	1
116	3518	Spring-Stop	1	148	3634	Brake Rod	1	179	1227	Roll Pin	2
117	3573	Pin Stop, Shift	1	149	3536	Gasket	2	180	1081	Roll Pin	2
118	3519	Rev. Idler Pin	1	150	1504	Bronze Bearing	2	181	1122	Key, Woodruff #9	4
119	3520	Rev. Idler Gear	1	151	1517	Bronze Bearing	2	182	1008	Key, Woodruff #15	4
120	3521	Spline Shaft	1	152	1503	Bronze Bearing	2	183	1108	Pipe Plug	1
121	3522	Input Gear	1	153	1502	Ball Bearing	2	184	1013	Pipe Plug	1
122	3523	Hi & 2 Gear	1	154	1519	Ball Bearing	5	185	1243	Cup Plug	1
123	3524	Lo & Rev. Gear	1	155	1518	Needle Bearing	1	186	1004	Wheel Bolt	6
124	3525	Cluster Gear	1	156	1616	Idler Pulley	1	187	1067	Shakeproof Washer	2
125	3526	Splined Pinion	1	157	1522	Bronze Bearing	1	188	1272	Snap Ring	1
126	3527	Cluster Shf. Red. Gear	1	158	3632	Stud-Idler Pin	1	189	1127	Snap Ring	4
127	3528	Cluster Shft. Pinion	1	159	1234	Oil Seal	2	190	1115	Lock Washer	1
128	1813	Tool Pin	1	160	1257	Oil Seal	2	191	3583	Lug-Cable Clamp	1
129	3530	Axle Gear	2	161	1106	Carriage Bolt	1	192	1030	Zerk	1
130	3531	Spider Gear	4	162	1009	Hex Head Cap	2	193	1080	Jam Nut	2
131	3502	Diff Case & Gear	1	163	1248	Hex Head Cap	18				
132	3533	Cluster Shaft	1								