

PARTS LIST AND INSTRUCTIONS



WHEELHORSE PRODUCTS, INC. • SOUTH BEND, IND.

The plow is shipped in two cartons. One carton has the plow base assembly and the coulter assembly with a bag of parts. The other carton contains the beam assembly.

ASSEMBLY

Replace the adjusting rod—R.H., which was removed for shipment, in the rear vertical member. Bolt the vertical member to the plow base, with the bolts supplied. Adjust the coulter in accordance with the depth at which you are going to plow.

LUBRICATION

There is only one grease fitting, and this is located on the coulter hub.

Before starting to plow, apply grease to coulter.

Use machine oil on the threads of adjusting rods.

When putting plow away, always wipe polished surface and coulter blade with grease or oil to prevent rust.

PREPARING THE PLOW FOR USE

The plow bottom must be cleaned so that dirt will slide off the mold-board without sticking. Wipe the polished surface with a rag soaked in turpentine, naphtha or gasoline. An old brick or a pumice stone can also be used to remove the protective coating, but usually this is not necessary if soil is not too wet.

TO BEGIN PLOWING

This is a 10" plow and works best at a depth of 5 to 6 inches. To turn the plow point into the ground when opening the furrow, use turnbuckle. After the dead furrow has been made, level the plow by running the right tractor wheels in the previous furrow and adjusting turnbuckle "A". When the right tractor wheels are in the furrow, the plow is designed to run in the proper horizontal angle.

For a 5 to 6 inch plowing depth, the coulter should slice from 2 to 3 inches deep, but not deep enough to drag the hub.

PLOW & COULTER PP-1064

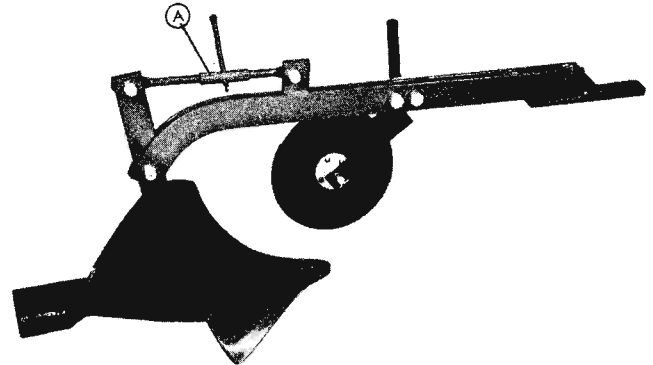

Lay out your field to be plowed, and, if possible, make it rectangular in shape, about 3 times as long as it is wide. NOTE: It is easier to plow a few long furrows than many short ones. LEAVE SOME ROOM AT EACH END FOR TURNING YOUR TRACTOR. Start plowing by laying off a dead furrow as shown in the sketch below.

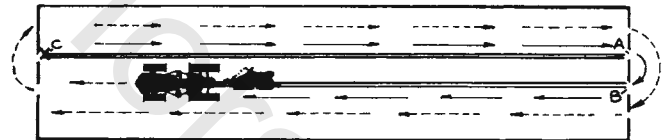

Begin at point "X" and plow a furrow to the end of your plot. Fix your eyes on a tree or some distant object in line with the middle of the plot so that you can guide your tractor and plow a straight first furrow to point "A". NOTE: ALWAYS LIFT PLOW BEFORE TURNING, and, at point "B", lower it again and plow a dead furrow piling the dirt on top of dirt from the first furrow. When you return to point "X" and start your real plowing with both the tractor's right wheels in the furrow at point "C", level out the plow with the turnbuckle. Plow in a clockwise direction, always LIFTING your plow at the end of the furrow before turning.

SPEED

Move steadily along so that the earth will turn over and not fall back into the furrow. In most soils, this is done at full throttle in second gear.

In light soils, plowing may often be done in high gear, but if you go too fast, you will get an uneven plowing job and the dirt is apt to be thrown instead of rolled over.

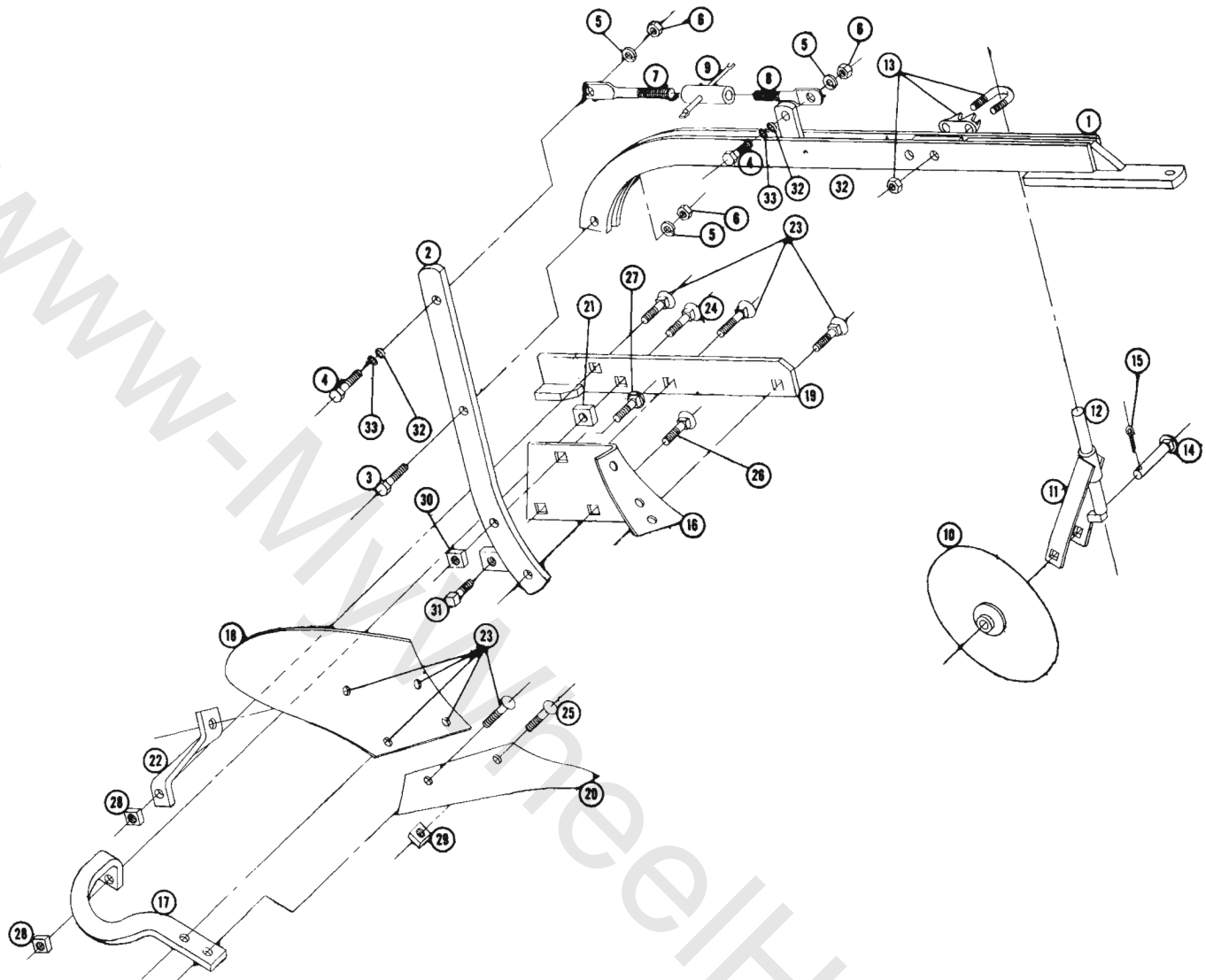

PARTS LIST

When ordering parts always list Part No. and name of part.

Ref. No.	Part No.	Description	No. Req'd.
1	2964	Ass'y. - Beam	1
2	2965	Standard Ass'y.	1
3	908059-4	Bolt - Hex. $\frac{1}{2}$ -13 x $1\frac{1}{2}$	1
4	908061-4	Bolt - Hex. $\frac{1}{2}$ -13 x 2	2
5	920085-4	Lockwasher $\frac{1}{2}$ Med.	3
6	915115-6	Nut - Hex. $\frac{1}{2}$ -13 Nylock	3
7	2043	Turn - Buckle End R.H. Thrd.	1
8	2044	Turn - Buckle End L.H. Thrd.	1
9	2027	Ass'y. Tube & Handle	1
10	2070	Ass'y. - Rolling Coulter	1
11	2065	Ass'y. - Arm - Coulter	1
12	2966	Ass'y. - Standard - Coulter	1
13	2967	Ass'y. "U" Bolt - Clamps & Nuts	1
14	2068	Axle - Coulter	1
15	932023-4	Cotter Pin $\frac{3}{16}$ x 1	1
16	2045	Frog	1
17	2049	Spreader	1

Ref. No.	Part No.	Description	No. Req'd.
18	2969	Moldboard	1
19	2970	Ass'y. - Landslide & Heel	1
20	2048	Ass'y. Point	1
21	2968	Spacer - Spreader	1
22	2971	Brace - Moldboard	1
23	901634-4	Bolt - Plow #3 Hd. $\frac{3}{8}$ -16 x 1	8
24	901636-4	Bolt - Plow #3 Hd. $\frac{3}{8}$ -16 x $1\frac{1}{2}$	1
25	901644-4	Bolt - Plow #3 Hd. $\frac{1}{4}$ x 14 x $1\frac{1}{4}$	1
26	901655-4	Bolt - Plow #3 Hd. $\frac{1}{2}$ -13 x $1\frac{3}{4}$	1
27	900115-4	Bolt - Carriage $\frac{1}{2}$ -13 x $1\frac{3}{4}$	1
28	915184-4	Nut - Square $\frac{3}{8}$ -16	9
29	915185-4	Nut - Square $\frac{1}{4}$ -14	1
30	915186-4	Nut - Square $\frac{1}{2}$ -13	3
31	900878-4	Bolt - Square Hd. $\frac{1}{2}$ -13 x 1	1
32	5353	Turn Buckle Spacer	2
33	920041-4	Washer $\frac{1}{2}$ Dia.	2