

## PARTS LIST AND INSTRUCTIONS



WHEELHORSE PRODUCTS, INC. • SOUTH BEND, IND.

The plow is shipped in two cartons. One carton has the plow base assembly and the coulter assembly with a bag of parts. The other carton contains the beam assembly.

### ASSEMBLY

Replace the adjusting rod—R.H., which was removed for shipment, in the rear vertical member. Bolt the vertical member to the plow base, with the bolts supplied. Adjust the coulter in accordance with the depth at which you are going to plow.

### LUBRICATION

There is only one grease fitting, and this is located on the coulter hub.

Before starting to plow, apply grease to coulter.

Use machine oil on the threads of adjusting rods.

When putting plow away, always wipe polished surface and coulter blade with grease or oil to prevent rust.

### PREPARING THE PLOW FOR USE

The plow bottom must be cleaned so that dirt will slide off the mold-board without sticking. Wipe the polished surface with a rag soaked in turpentine, naphtha or gasoline. An old brick or a pumice stone can also be used to remove the protective coating, but usually this is not necessary if soil is not too wet.

### TO BEGIN PLOWING

This is a 10" plow and works best at a depth of 5 to 6 inches. To turn the plow point into the ground when opening the furrow, use turnbuckle. After the dead furrow has been made, level the plow by running the right tractor wheels in the previous furrow and adjusting turnbuckle "A". When the right tractor wheels are in the furrow, the plow is designed to run in the proper horizontal angle.

For a 5 to 6 inch plowing depth, the coulter should slice from 2 to 3 inches deep, but not deep enough to drag the hub.

# PLOW & COULTER PP-101

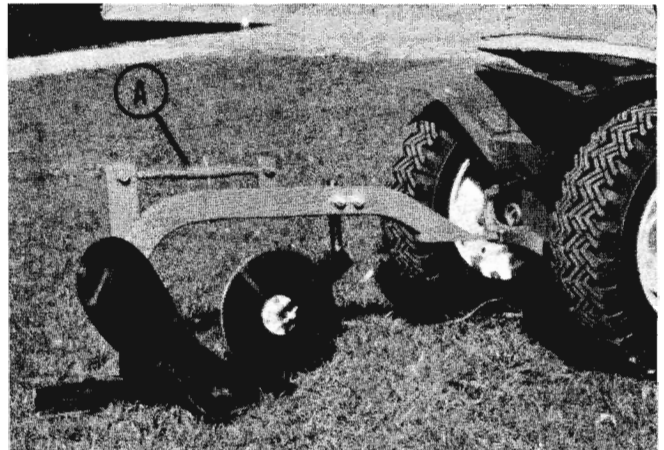

Lay out your field to be plowed, and, if possible, make it rectangular in shape, about 3 times as long as it is wide. NOTE: It is easier to plow a few long furrows than many short ones. LEAVE SOME ROOM AT EACH END FOR TURNING YOUR TRACTOR. Start plowing by laying off a dead furrow as shown in the sketch below.

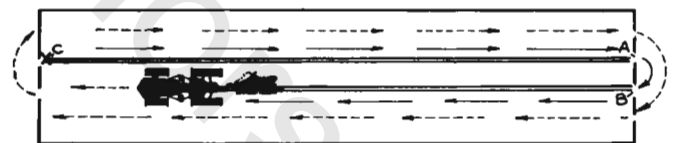

Begin at point "X" and plow a furrow to the end of your plot. Fix your eyes on a tree or some distant object in line with the middle of the plot so that you can guide your tractor and plow a straight first furrow to point "A". NOTE: ALWAYS LIFT PLOW BEFORE TURNING, and, at point "B", lower it again and plow a dead furrow piling the dirt on top of dirt from the first furrow. When you return to point "X" and start your real plowing with both the tractor's right wheels in the furrow at point "C", level out the plow with the turnbuckle. Plow in a clockwise direction, always LIFTING your plow at the end of the furrow before turning.

### SPEED

Move steadily along so that the earth will turn over and not fall back into the furrow. In most soils, this is done at full throttle in second gear.

In light soils, plowing may often be done in high gear, but if you go too fast, you will get an uneven plowing job and the dirt is apt to be thrown instead of rolled over.

## PARTS LIST

Ref. No.	Part No.	Description	No. Req'd.
1	1002	Cotter Pin $\frac{1}{8}$ x 1	1
2	1024	Plow Bolt $\frac{3}{8}$ -16 x $1\frac{1}{2}$	1
3	1030	Grease Fitting $\frac{1}{4}$ -28	1
4	1069	Plow Bolt $\frac{3}{8}$ -16 x 1	6
5	1072	Sq. Nut $\frac{3}{8}$ -16	7
6	1074	Hex Nut $\frac{1}{2}$ -13	3
7	1077	Hex Hd. Cap Screw $\frac{1}{2}$ -13 x 2	1
8	1115	Lockwasher $\frac{1}{2}$	3
9	1255	Plow Bolt $\frac{1}{2}$ -13 x $1\frac{1}{2}$	1
10	1312	Hex Hd. Cap Screw $\frac{1}{2}$ -13 x $1\frac{1}{2}$	2
11	1343	Hex Nut $\frac{5}{8}$ -11	2
12	1378	Carriage Bolt $\frac{1}{2}$ -13 x $1\frac{3}{4}$	1
13	1379	Plow Bolt $\frac{7}{16}$ -14 x 1	1
14	1380	Sq. Nut $\frac{1}{2}$ -13	2
15	1381	Sq. Nut $\frac{7}{16}$ -14	1
16	1383	Rd. Hd. Rivet $\frac{1}{64}$ x $\frac{5}{8}$	4
17	2027	Coupling—Adjusting	1

Ref. No.	Part No.	Description	No. Req'd.
18	2036	Beam Assembly W/A	1
19	2042	Bar—Rear Vertical Member	1
20	2043	Adjusting Rod—R.H.	1
21	2044	Adjusting Rod—L.H.	1
22	2045	Frog	1
23	2046	Mold Board	1
24	2047	Landslide	1
25	2048	Point	1
26	2049	Brace—Bar	1
27	2065	Standard Assembly	1
28	2066	Rod—Swivel	1
29	2068	Pivot Pin	1
30	2069	"U" Bolt	1
31	2070	Colter Blade Assembly	1
32	2072	Clamp—Coulter	1
33	2073	Blade 10" Dia.	1
34	2074	Hub—Blade	2

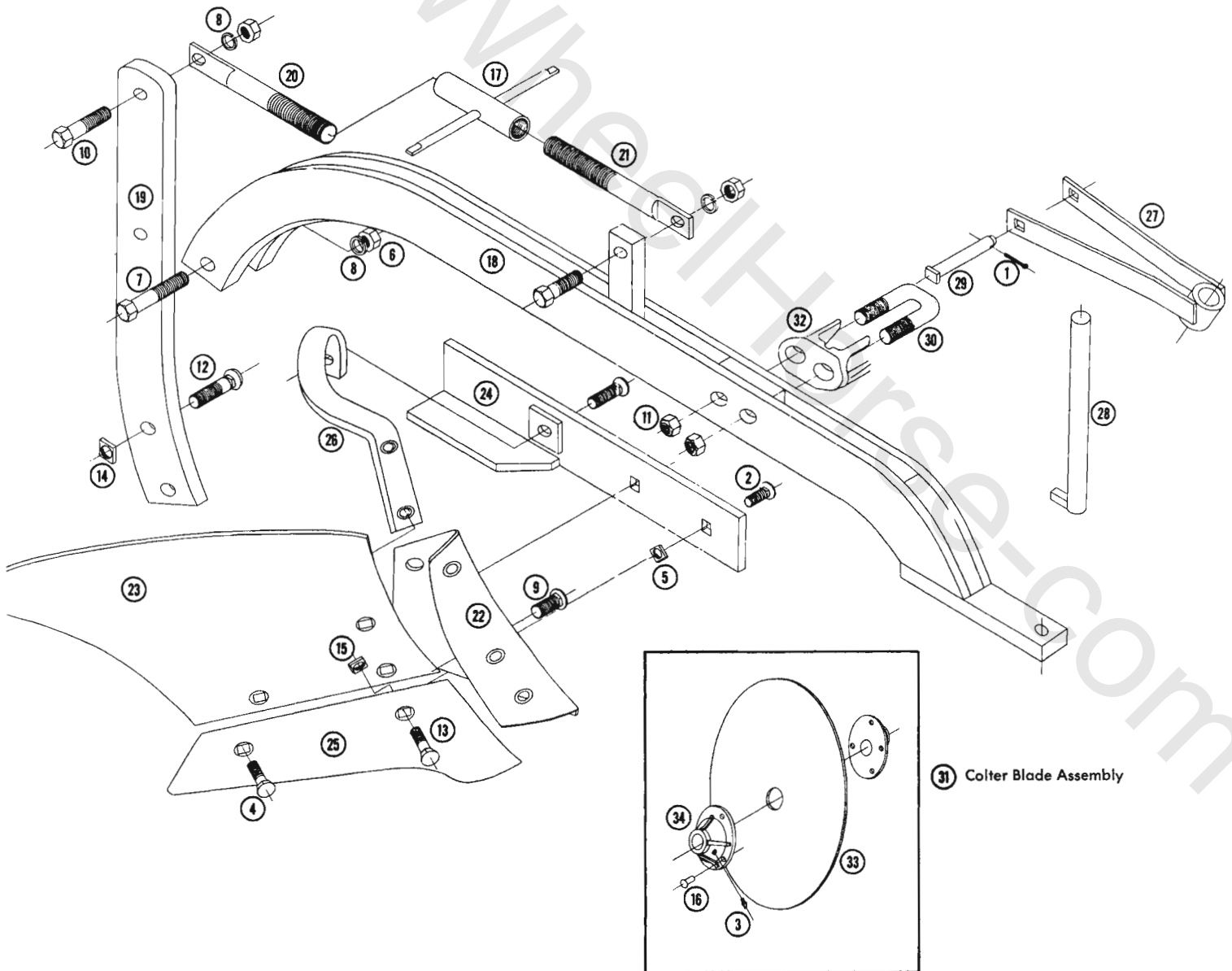

**31** Colter Blade Assembly