

PARTS LIST AND INSTRUCTIONS

32" DISC HARROW

FACTORY ORDER NUMBER 7-1513

(Formerly 7-1512)

ASSEMBLY

The disc is shipped dismantled in one carton as shown in Figure 1. Follow the assembly procedures in steps 1 through 4 for both disc gang assemblies. For Parts identification see Figure 1.

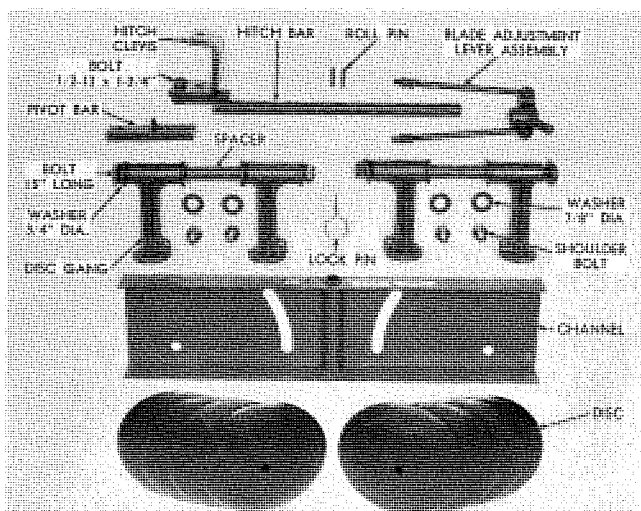

FIGURE 1

1. Grip the head of a $\frac{3}{4}$ x 15" bolt in a vise. Slip a $\frac{3}{4}$ " washer on the bolt, then a disc with the dished side up, and then another washer.

2. Slide a small diameter bearing tube on the bolt and install a cast iron disc gang over the tube with the long hub toward the disc.

3. Add another washer, disc, washer, a large diameter spacer and another disc between two washers.

4. Finally, install another bearing tube and disc gang, a disc between two washers, and a nut. Tighten the nut securely. The discs should rotate freely in the gangs.

5. Place the gang assemblies against the flat side of the channel with the dished side out and bolt them to the channel using the $\frac{5}{8}$ " shoulder bolts and $\frac{7}{8}$ " washers.

6. Slide the blade adjustment lever assembly on the hitch bar with the lock pin hole toward the hitch.

Then insert the hitch bar through the channel tube from the front and drive the roll pins in place on either side of the channel.

7. Connect the pivot rods to the inner gangs and adjust them with the lock nuts so the right and left gangs are set at the same angle. See Figure 2.

The disc harrow is now ready to be hitched to the tractor.

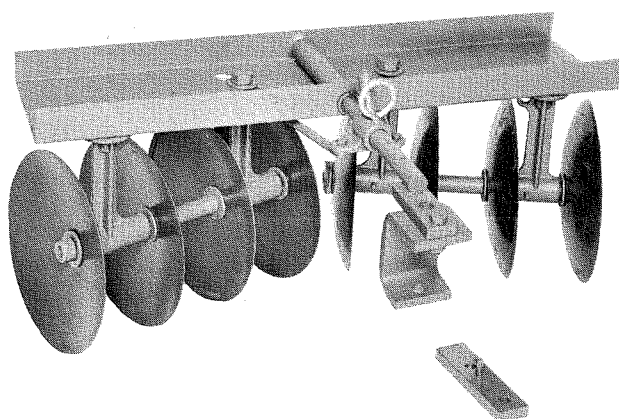

FIGURE 2

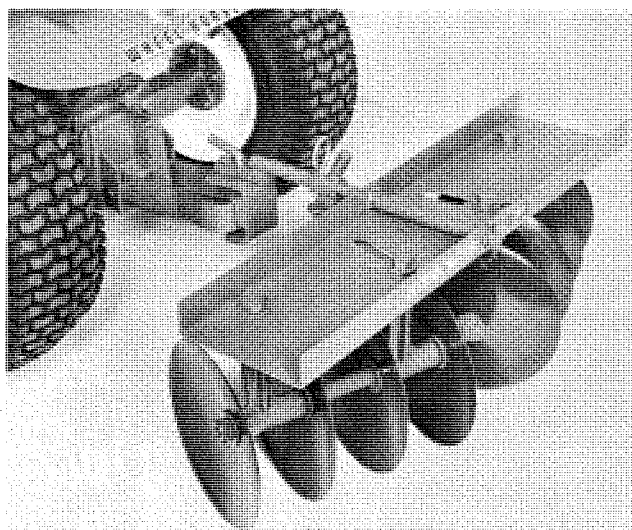

FIGURE 3



WHEEL HORSE

lawn & garden tractors

PARTS LIST — 32" DISC HARROW

FACTORY ORDER NUMBER 7-1513 (FORMERLY 7-1512)

Parts available only through Authorized Dealers.

When ordering parts always list Part No. and Description.

(Specifications subject to change without notice.)

ITEM NO.	PART NO.	DESCRIPTION	NO. REQ'D.
1	2149	Channel	1
2	8822	Hitch Bar	1
3	2160	Pivot Bar	1
4	8748	Disc Hitch Clevis	1
5	2104-C	Gang — Disc	4
6	1030	Grease Fitting	5
7	2108	Disc Blade	8
8	2109	Spacer	2
9	2110	Tube	4
10	6900	Bolt	2
11	920044	Washer $\frac{3}{4}$ U. S.	16
12	915610	Nut $\frac{3}{4}$ -10 Elastic Stop	2
13	2158	Bolt Shoulder $\frac{5}{8}$ -11	4
14	920016	Washer $\frac{7}{8}$ SAE	4
15	2152	Pivot Rod	2
16	932017	Cotter Pin $\frac{1}{8}$ x 1	2
17	915115	Nut — Nyllok $\frac{1}{2}$ -13	5
18	908060	Bolt Hex $\frac{1}{2}$ -13 x $1\frac{3}{4}$	1
19	2151	Blade Adjustment Lever	1
20	933269	Spirol Pin $\frac{1}{4}$ x $1\frac{1}{4}$	2
21	2156	Lever Lock Pin	2
22	103174	Decal	1

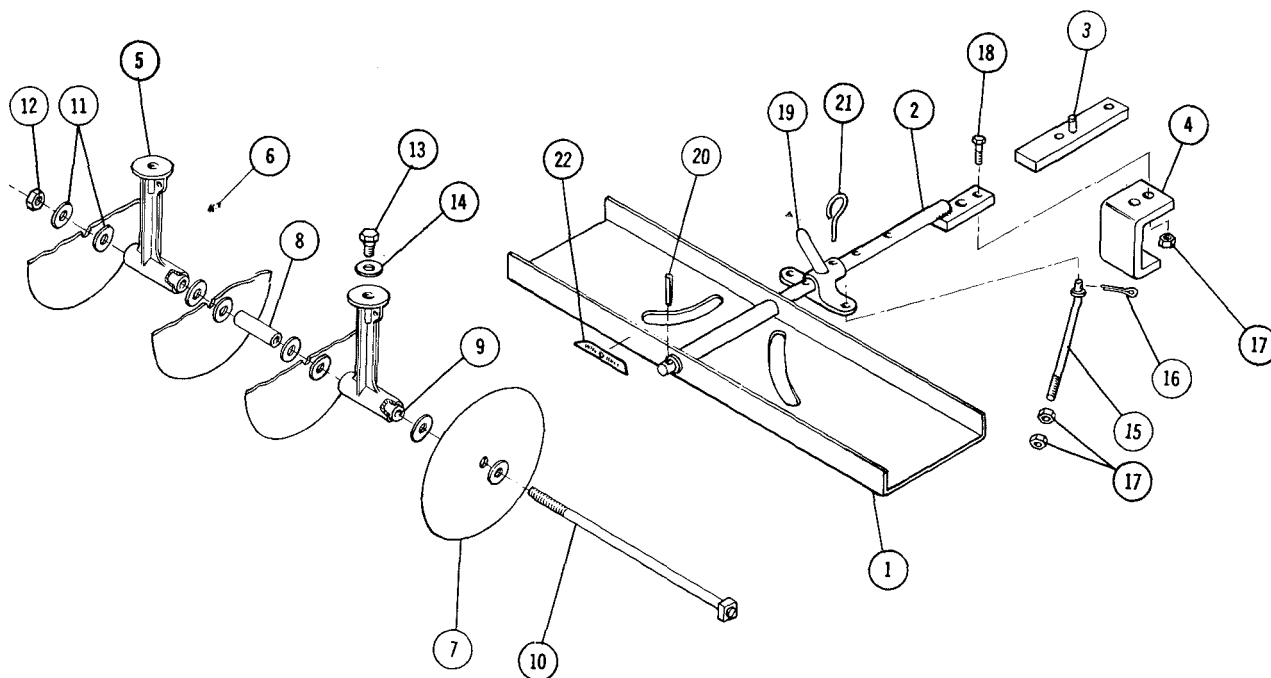

HITCH REQUIREMENTS

Depending on model, the tractor must be equipped with either a Type A Clevis Hitch, part number 8-5511 or 8-5211, or a Slot Hitch, part number 8-5521, which was standard prior to 1969 and an option for some 1969 models. Hitch mounting instructions are included with the hitch accessory.

1. **Clevis Type A** — If the tractor is equipped with a clevis hitch, the disc hitch clevis must be installed on the hitch bar with the $\frac{1}{2}$ -13 x $1\frac{3}{4}$ bolt and nut as shown in Figure 3. **Note:** The stabilizer bolts should not be tightened for operation thus allowing the disc to pivot for turns. Tighten the stabilizer bolts when transporting the disc. When extra weights are added, it is not possible to lift the disc with the hand lever and the discs should be set at 0° for transporting.

2. **Slot Hitch** — The hitch bar inserts directly into the slot hitch and is secured with the tool pin.

NOTE: The lift lever cannot raise the disc for turning when extra weights are mounted, so the pivot bar #2160 must be installed between the slot hitch and the disc hitch bar which allows the disc to follow the tractor around turns.

Position the pivot bar with the pin stop up, and fasten it beneath the flat on the hitch bar with the $\frac{1}{2}$ -13 x $1\frac{3}{4}$ bol and nut.

OPERATION

The channel frame is made so that extra weight may be added to improve penetration of hard or dry soils. It will hold two standard 8 x 8 x 16 cement blocks, one on each side. See the special notes under Hitch Requirements concerning the use of extra weights.

The tractor operator can set the angle of the disc gang assemblies at 0° , 10° , 20° , or 30° without leaving the driver's seat. To change the angle, pull the lock pin out of the hole in the blade adjustment lever and move the tractor slowly forward or backward to increase or decrease the angle. When the hole in the blade adjustment lever registers with the correct hole in the hitch bar, reinstall the lock pin to hold the position.

For average soil conditions, set the gang assemblies at 10° or 20° . It is best to start discing operations at slow speed, increasing speed when you can do it comfortably as work progresses and clods break down to smaller size. The type of seed bed desired, type and moisture content of the soil, and the weight on the disc harrow will determine the number of times the soil will have to be worked.

LUBRICATION

There are five pressure grease fittings on the disc, one on each disc gang and one on the blade adjustment lever. These should be greased every day when in use. When the disc is to be stored, a coating of grease on the blades is helpful in preventing rust.

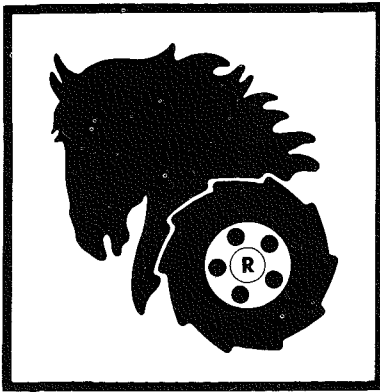

WHEEL HORSE PRODUCTS, INC.

515 West Ireland Road

South Bend, Indiana 46614