

## PARTS LIST AND INSTRUCTIONS



WHEEL HORSE

WHEEL-HORSE PRODUCTS, INC. • SOUTH BEND, IND.

## DOZER BLADE

MODEL & MODEL  
**6-1131**      **6-1141**

54"

56"

FOR USE ON 1-0600 SERIES TRACTORS

The Blade is shipped complete in one carton. It has been partially preassembled. To complete the assembly, group the parts similar to that shown in Fig. 5.

Prepare the Tractor by removing the links that hold the 3 Point Hitch Bracket to the axle. See Fig. 1.

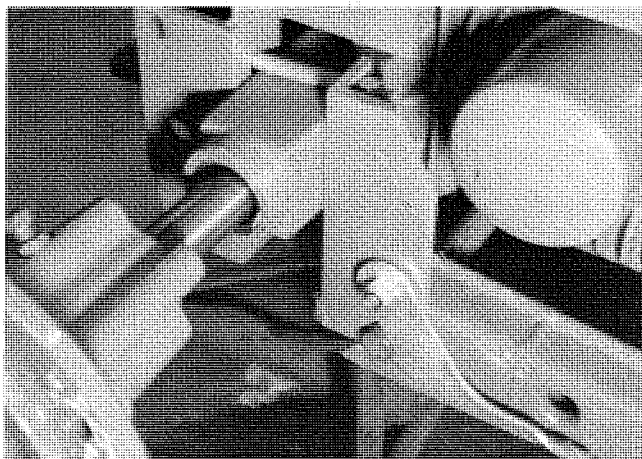

FIG. 1

Install Mounting Bracket Assembly, item 41, using the same bolts that held the Links.

Raise the Latches so the "U" notch is exposed to receive the Blade Shaft.

The Blade Control Rod, item 24, is inserted through the top of the pivot sector, item 4, and secured with hairpin cotter. Bolt the Pivot Sector, item 4, to the frame assembly using the Hex Bolt, item 5, and elastic stop nut, item 6. (NOTE: Apply a liberal coat of grease before installing.) Insert the bolt from the top and tighten, leaving it loose enough for the blade to swing free. Attach the control rod to the control arm. See Fig. 3.

Attach the Blade Assembly to the Pivot Sector using lower pivot rod, item 55, and two  $\frac{1}{8}$  x 1 Cotter Pins.

Referring to Fig. 2, insert Rod, item 13, through the rear hole of the sector. On each rod end install 2 springs, item 11, and secure each end with Hairpin Cotters, item 14.

Complete the assembly by inserting the remaining pivot Rod through the top spring anchors and the angles on the blade. The angle the blade makes with the ground will be determined by the hole in which the pivot Rod is placed. For general use, the second hole down from the top is used. Assemble for a forward tilt for earth spreading. Assemble for backward tilt for more aggressive action.

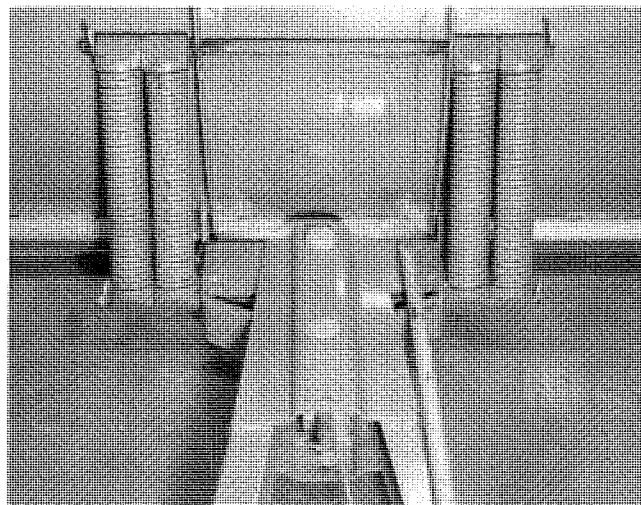

FIG. 2

Connect the Rod, item 29, to Index Pin, item 8, and Lever Assembly, item 15. Secure with Cotter Pins shown.

Slide Index Lever, item 25, over Arm, item 21, and fasten with Clevis Pin, item 34, and Hairpin, item 27.

Thread Yoke, item 31, on Rod, item 30. Connect this assembly to the Index Lever, item 36, and install Hairpin, item 27.

Attach the yoke end to the transfer lever arm, item 16, with Clevis Pin, item 32, and Cotter Pin, item 33.

Adjust the yoke so that the minimum travel is required to pull the index pin clear of the sector.

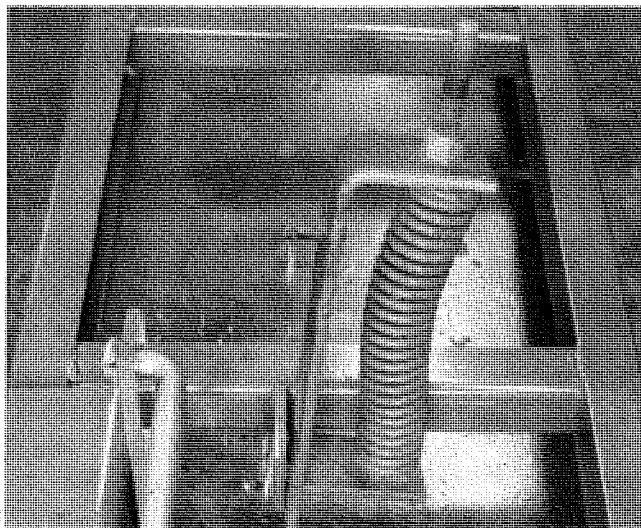

FIG. 3

Referring to Fig. 3 and Fig. 5, place Spring, item 49, over the Lift Rod Assembly, item 40. Install the Lift Bar, item 39, with the hole over the Lift Rod and the slot engaging the stud on the Lift Rod. Add Nut, item 51, to the top and Pin, item 50, to the bottom.

The Lift engaging pin, Fig. 3 is installed in the rear hole of the two hole pattern in the tractor lift bar, Fig. 4.

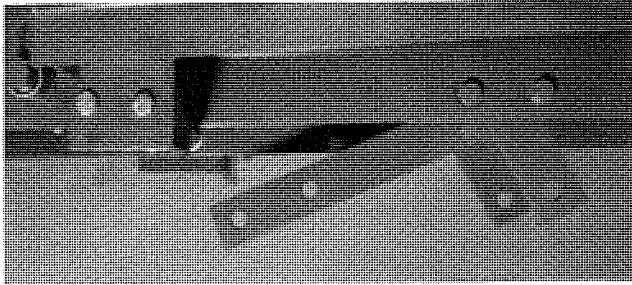

FIG. 4

## OPERATION

This dozer is equipped with a spring trip device. If the blade should strike a solid object, it will tilt forward and slide over. The dozer blade is adjustable and may be locked in three different positions: straight, right angle, and left angle. These adjustments are easily accomplished from the tractor seat by operating the convenient turn lever. The blade is adjusted up and down with the lift lever.

The Skids, item 56, one each side of the blade must be adjusted before operation. This is accomplished by loosening the set screws, adjusting to the desired position, and tightening again. The purpose of the skids is to keep the blade from catching on

cracks in the walk or drive, and to allow it to float over uneven surfaces.

As installed the Blade will float in use. To lock out the float feature insert a  $\frac{1}{2}$  x 2 Clevis Pin through the Lift Arms as shown in Fig. 6. Secure it with a Hairpin.

Before operation, make sure that all bolts are tight and cotter pins opened. Excessive play in the pivot sector may be removed by tightening the large pivot bolt. The blade edge is reversible and replaceable. After the edge is worn, remove the bolts securing it to the blade and turn it over, providing a new cutting edge.

A light grade of machine oil should be applied to all moving parts, before operation, and after every 10 hours of use.

**CAUTION:** Avoid hitting solid objects with the blade, as this could result in damage to the blade and injury to the operator.

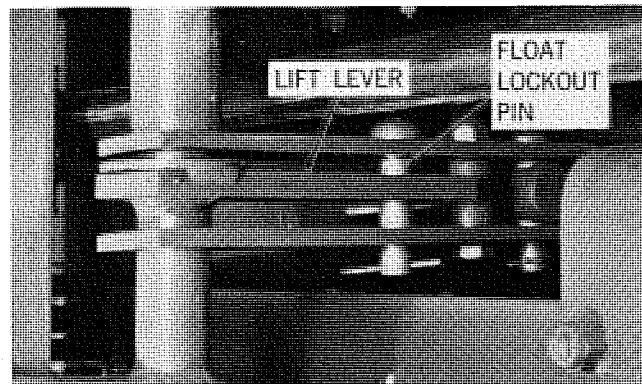

FIG. 6

## WHEEL HORSE SPARE PARTS WARRANTY

Wheel-Horse Products, Inc. guarantees both its new and its rebuilt spare parts as well as its assemblies against manufacturing defects for 90 days from the date of purchase. Any new or rebuilt spare parts or any assembly manufactured by Wheel Horse will be replaced free if found to be defective while in normal usage during the 90 days following the date of purchase. If the spare part or assembly is warranty replacement, our guarantee applies for the duration of the original warranty period or 90 days, whichever is longer.

Drive belts are also guaranteed for 90 days from date of purchase. Batteries and spare parts for engines are guaranteed separately by their manufacturer. This guarantee covers the replacement of defective parts only. All labor, transportation costs and dealer service charges are the responsibility of the owner. All claims must be handled through an authorized Wheel Horse dealer.

Wheel-Horse Products, Inc. reserves the right to change spare part specifications and/or to delete or substitute spare parts at any time without notice and without incurring obligation.

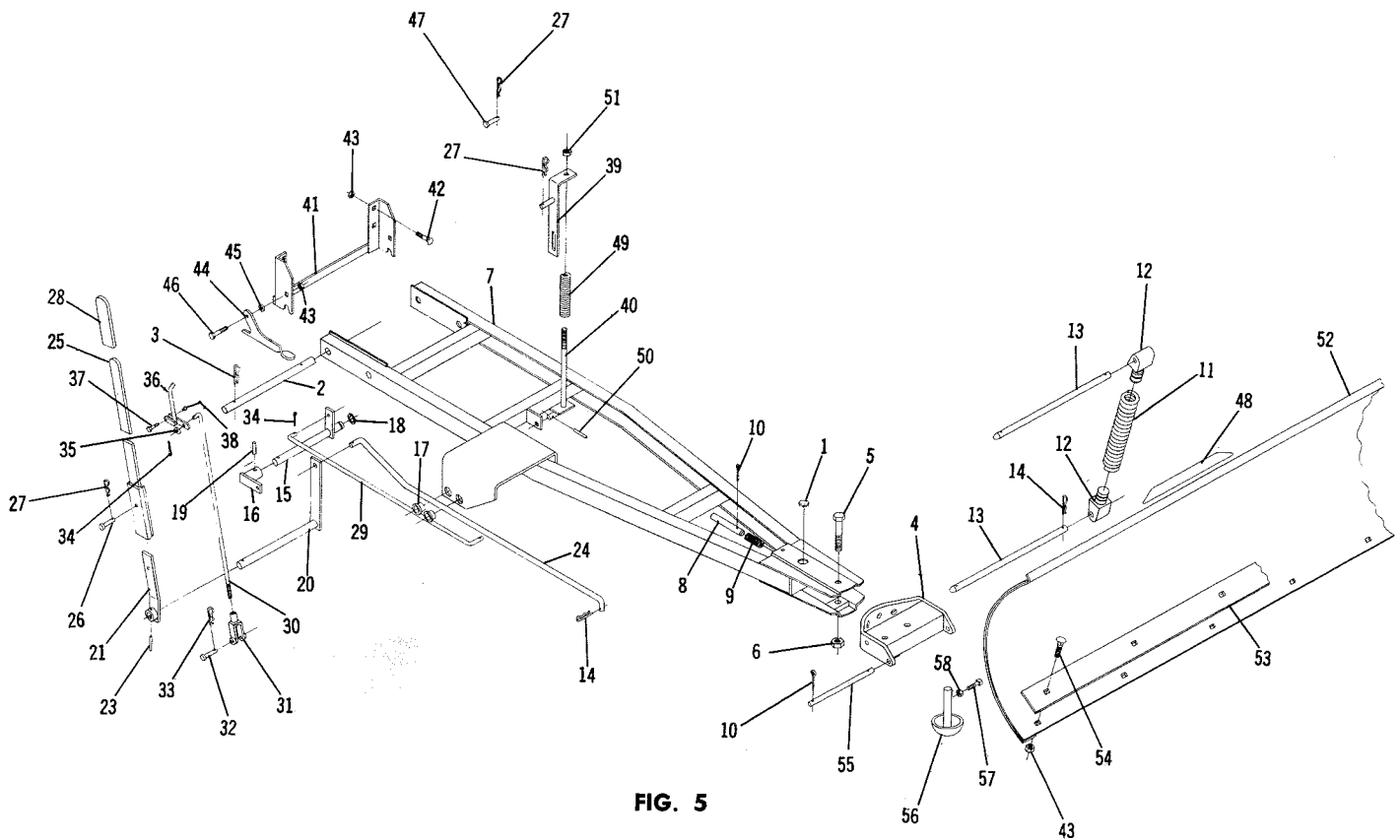

FIG. 5

### PARTS LIST FOR DOZER BLADES

Parts available only through Authorized Dealers.

When ordering parts always list Part No. and name of part.

(Specifications subject to change without notice.)

Item No.	Part No.	Description	No. Req'd.	Item No.	Part No.	Description	No. Req'd.
1	4944	Plug Button	2	30	103010	Rod — Upper Index	1
2	7701	Shaft — Mounting	1	31	103509	Yoke	1
3	933506-4	Hairpin	2	32	932120-4	Pin — Clevis ¼ Std.	1
4	103475	Assembly Sector & Chunnel	1	33	933503-4	Hairpin	1
5	908256-4	Bolt — Hex. ¾-16 x 3¼	1	34	932001-4	Cotter Pin	3
6	915640-4	Nut — Hex. ¾-16 E. S.	1	35	920007-4	Washer — ¼ SAE	3
7	102988	Frame Assembly	1	36	103507	Assembly Index Lever	1
8	103498	Pin — Index	1	37	908005-4	Bolt — Hex. ¼-20 x 1	1
9	2354	Spring	1	38	915111-6	Nut — Hex. ¼-20 Eslok	1
10	932017-4	Cotter Pin ⅛ x 1	3	39	103013	Assembly — Lift Bar	1
11	5117	Spring	4	40	103015	Assembly Lift Rod	1
12	5125	Lug	8	41	8010	Assembly Bracket Frame	1
13	103019	Rod	2	42	900073-4	Bolt — Carriage ⅜-16 x 3½	4
14	933512-4	Hairpin	6	43	915663-4	Nut — Hex. ⅜-16 E. S.	13
15	103499	Control Shaft	1	44	7704	Plate — Latching	2
16	103501	Assembly — Bar	1	45	920009-4	Washer — ⅜ SAE	2
17	103007	Bushing	4	46	903036-4	Bolt — Hex. ⅜-16 x 1½	2
18	936131	Snap Ring 1"	1	47	933000-4	Pin Clevis ½ x 2	1
19	933243	Spirol Pin ⅜ x 1¼	1	48	103174	Decal	1
20	102997	Assembly — Blade Index Arm	1	49	103018	Spring	1
21	103011	Assembly — Handle Bar	1	50	933171	Pin Spirol ⅝ x 1	1
22	915236-4	Nut — Hex. ⅜-16 Jam	2	51	915665-4	Nut — Hex. ½-13 E. S.	1
23	933244	Spirol Pin ⅜ x 1½	1	52	103000	Assembly Blade — 54"	1
24	103008	Rod — Blade Control	1	53	103615	Assembly Blade — 56"	1
25	103504	Assembly Handle	1	53	3087	Plate — Blade Edge 54"	1
26	932963-4	Clevis Pin ⅜ x 1	1	53	103618	Plate — Blade Edge 56"	1
27	933505-4	Hairpin	3	54	900062-4	Bolt — Carriage ⅜-16 x ¾	7
28	5359	Grip	1	55	4564	Rod — Lower Pivot	1
29	103009	Rod — Lower Index	1	56	2399	Assembly Skid	2
				57	909554-4	Set Screw — ⅜-16 x 1 Sq. Hd.	2



**WHEEL-HORSE PRODUCTS, INC.**  
**SOUTH BEND, INDIANA 46614**